

MAPX	MODIFICATION	DATE

A
B
C
D
E
F
G

A
B
C
D
E
F
G

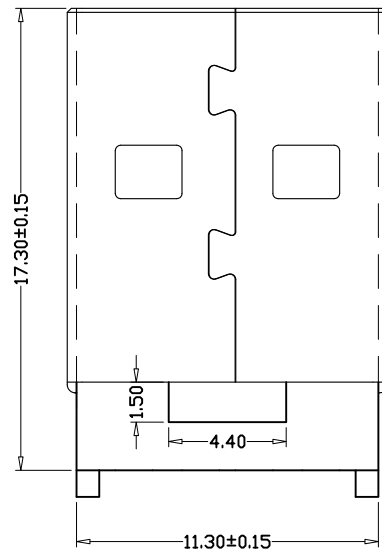
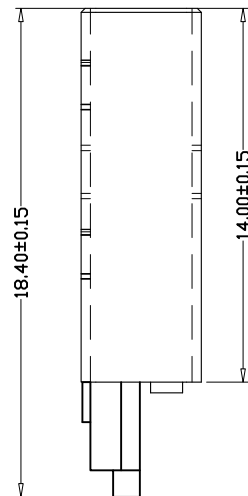
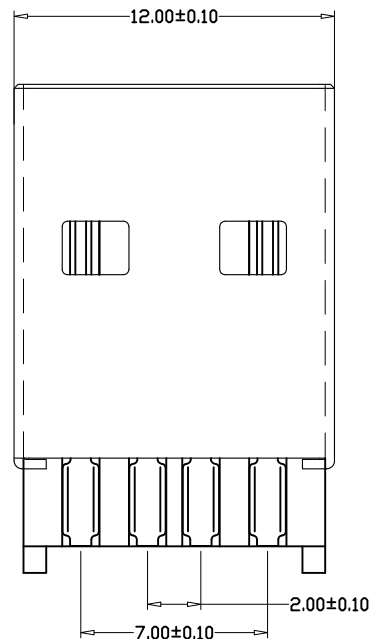
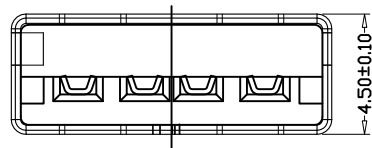

NOTES:

Housing: Thermoplastics

Contact: Copper Alloy

Shell: Copper Alloy/Steel

Voltage Current Rating: 1.5 AMP. 30V AC

Insulation Resistance: 1000MΩ Min.

Contact Resistance: 30 MΩ Max.

Dielectric Withstanding Voltage: 500V AC

Temperature Range: -55° C to +85° C

Insulator color: Black/White

Plastic material: PBT/LCP

Shell finish: Nickel plated/Tin-Lead plated

Contact finish:

01: Selective Gold Flash

02: Selective Gold 3U"

03: Selective Gold 5U"

04: Selective Gold 15U"

05: Selective Gold 30U"

产品图 PRODUCT CHART DWG				深圳市精拓金电子有限公司							
公差一览表 TOLERANCE UNLESS OTHERWISE				单位 UNITS	MM	制图 DRAWING	Z-Y-B	制图料号 PRODUCT PART NO.	917-111A1012A10200		
X.	±0.15	X.	±5°	比例 SCALE	1:1	审核 CHKD		产品名称 PRODUCT NO.	AM4代B款白胶1U焊线		
.XX	±0.10	.XX	±2°	日期 DATE	2011.10.15	核准 APPD		角法 VIEW		版本 VER	AO
.XXX	±0.05	.XXX	±1°								
	±0.03		±0.5°								

1 2 3 4 5 6 7 8 9 10