

SEC:A-A

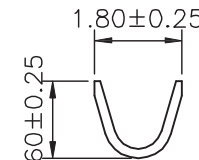

SEC:B-B

SPECIFICATIONS

- 1.Voltage rating: 250V AC, DC
- 2.Current rating: 3A, AC, DC
- 3.Withstanding Voltage: 1000V AC/minute
- 4.Insulation resistance:1000M min
- 5.Temperature range: -25 °C~+85 °C
- 6.Contact resistance: 10m max

Ordering Information & Specifications

Part No	Wire Range	Insulation O.D.	Material	Finish	Qty/reel
T2501BS-2	AWG#22-#28	1.90mm(max)	Brass	Tin-plated	8,000pcs
T2501PS-2	AWG#22-#28	1.90mm(max)	Phosphor Bronze	Tin-plated	8,000pcs

Note:E-Stamping before Tin-plated

				TOLERANCE UNLESS OTHERWISE		DRAWN	CK tan	XFCN兴飞连接器有限公司 CONNECTORS XFCN CONNECTORS CO., LTD.		SHEET	1/1
				X.	±0.30	X°	±5°			CHKD	DATE
				.X	±0.20	.X°	±2°	APPD	PRODUCT NAME	2.50mm Crimp Style Connectors	
				.XX	±0.08	.XX°	±1°	VIEW	PART. NO.	SCALE	1:1
				.XXX	±0.03	.XXX°	±0.5°			T2501PS-2	DWG NO.
AO	MODIFICATION		DRAW	DATE							