

1 2 3 4 5 6 7 8

REV	LOCATIONS	DESCRIPTION	DATE	REVISER	APPD

SPECIFICATIONS

Electrical

Current Rating: 1A AC(rms)/DC  
 Voltage Rating: 250V AC(rms) 500V DC  
 Contact Resistance: 35 mΩ Max  
 Insulation Resistance: 500 MΩ Min  
 Withstanding Voltage: 500V AC r.m.s  
 Temperature Range-Operating: -55°C~+105°C

Material and Plating

Housing: PBT (UL 94V-0), Black  
 Contact: Phosphor bronze/ Selective gold plated on contact area and bright tin plated on tails area  
 Shell: Steel/ Nickel plated

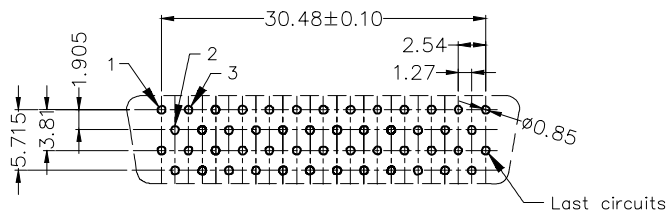
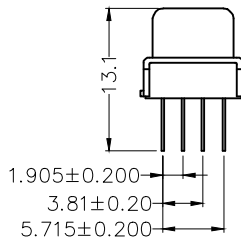
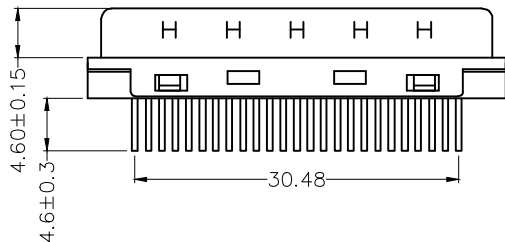
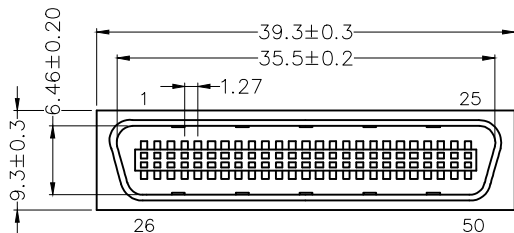

Recommended P.C.Board Layout  
 General Tolerances: ±0.05

Ordering Information

FCS 50 13 — MO D S 3 XX BK K  
 1 2 3 4 5 6 7 8 9 10

1	Category	2	Circuits	3	Distinction No.	4	Type	5	Assembly Layout	6	Entry Angle
	FCS-SCSI		50		13		MO-Male		D-DIP		S-180° Vertical
7	Plating	8	Thickness of Plating	9	Color-Resin	10	Packaging				
	3-Selective gold plated on contact area and bright tin plated on tails area		00-Gold flash 03-3μ" Custom plate available		BK-Black		K-Tray				

<p>THIRD ANGLE PROJECTION</p>	GENERAL TOLERANCES (UNLESS SPECIFIED)		APPROVE BY	DATE	PART NO.	ITEM NO.	<p>Leader Of Industry</p>
	X. ±0.30	X.' ±5'	FRANK	09/JUN/20	FCS5013-MODS3XXBKK	FCS5013	
DESIGN UNITS Metric	X.X ±0.20	X.X' ±2'	CHECKED BY	DATE	TITLE		REV 0 SHEET NO. 1/1 THIS DRAWING CONTAINS INFORMATION THAT IS PROPRIETARY TO TXGA INDUSTRIAL ELECTRONICS(S.Z)CO.,LTD AND SHOULD NOT BE USED WITHOUT WRITTEN PERMISSION
SCALE 5:1	X.XX ±0.15	X.XX' ±1'	CHERRY	09/JUN/20	SCSI Connector Pitch 1.27mm 180° Vertical Male		
SIZE A4	X.XXX ±0.10	X.XXX' ±0.5'	DRAWN BY	DATE			
			KATE	09/JUN/20			

1 2 3 4 5 6 7 8