

RoHS

MATERIALS

Housing: Plastic Thermoplastic, PA6T, UL94V-0, Black
 Contact Material: Copper Alloy Gold Selective Plated
 Front Shell: Steel, Nickel Plated Over Copper
 RoHS Compliant

ELECTRICAL CHARACTERISTICS

Rated Current: 1.0AMP
 Withstand Voltage: 500V AC/DC
 Insulation Resistance: 500MΩ Min
 Contact Resistance: 35mΩ Max
 Operation Temperature: -55°C to +105°C

材质

胶芯: 塑胶 PA6T UL94V-0, 黑色
 端子: 铜合金, 镀金
 前壳: 铁材, 镀镍

规格

耐电流: 1安培
 最大耐电压: 交流500伏特
 绝缘抗阻: 最小值大于500百万欧姆
 接触抗阻: 最大值小于35千分之一欧姆
 工作温度: -55°C到+105°C

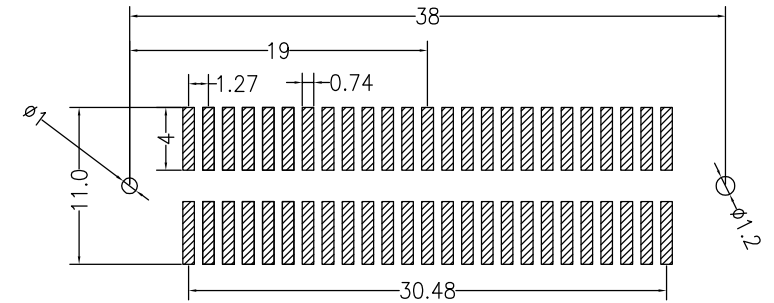
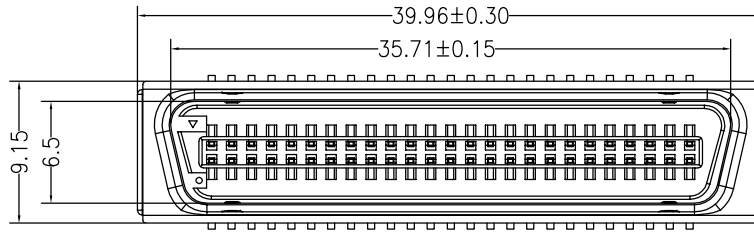

PCB LAYOUT

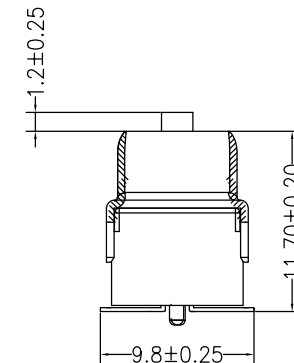
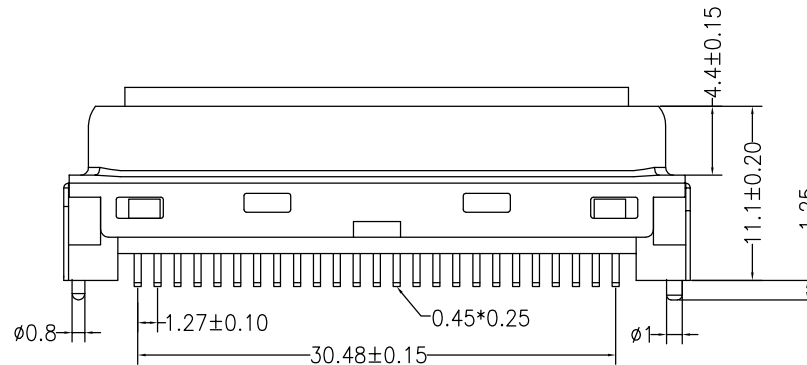

				OPERATION		DRAW		SCALE	FIT	深圳市连盛精密连接器有限公司		
				X.X	±0.30			UNIT	mm			
				CHECK				SIZE	A4	PART NO. XHLJQ-00026		
				X.XX	±0.15			SHEET	1/1			
A0	2018.08.22	NEW DRAWING		APPROVE				PROJ.	☯	TITLE: 信号连接器-50PIN 公头 SMT 配DB壳 胶芯加高1.2 带大小柱		
REV	DATE	MODIFICATION DESCRIPTION		CHANGE								
1	2	3	4	5	6	7	8	9				