

RoHS

Recommended P.C.B Layout(Top Side)
(PCB BOARD TOLERANCE±0.05)

SPECIFICATIONS

Rated Current:3.0AMP
Contact Resistance:20mΩ Max
Withstand Voltage:1000V AC/DC
Insulation Resistance:1000MΩ Min
Operation Temperature:-40°c to +105°c

Contact Material:Brass
Contact Plating:Au Over Ni
Insulator Material:Polyester(UL94V-0)
Standard: PA6T
Max.Processing Temp: 230°C for 30-60 seconds
(260°C for 10 seconds)

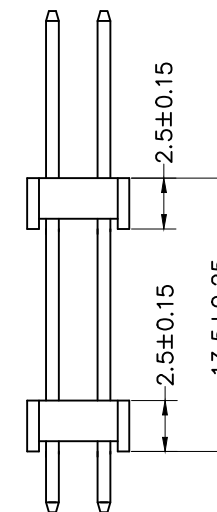
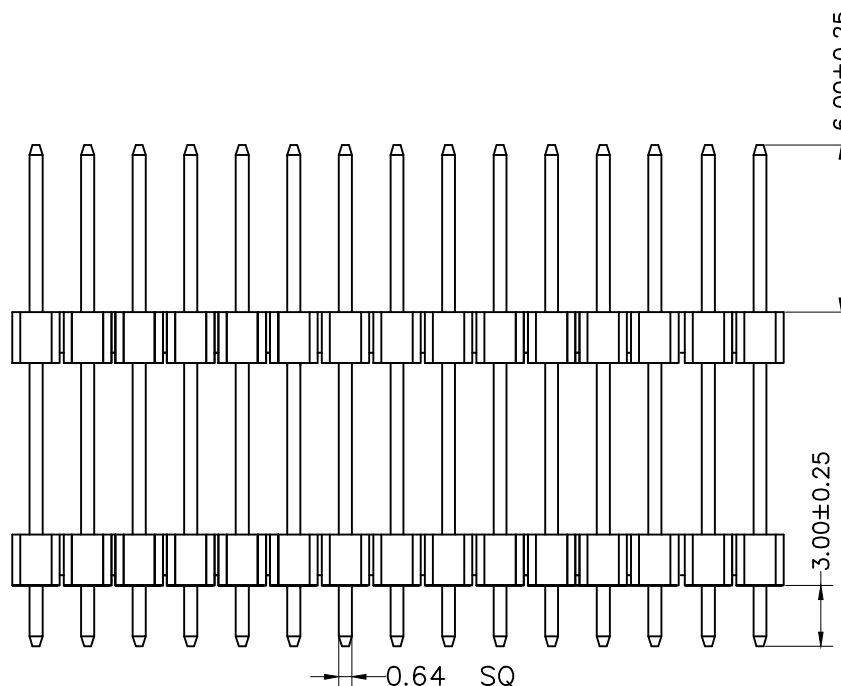
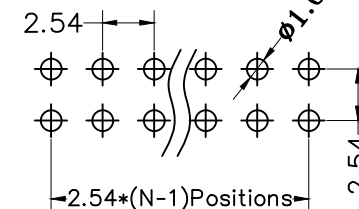
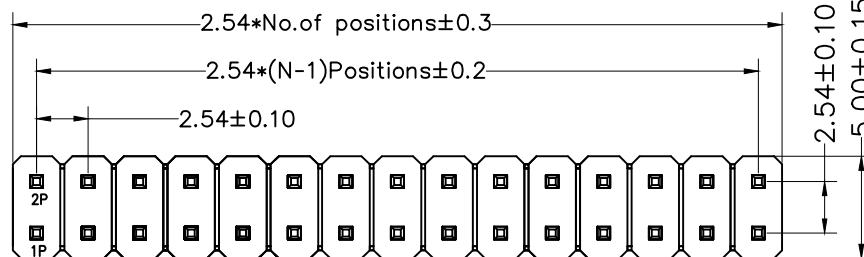

				OPERATION		DRAW		SCALE	FIT	深圳市连盛精密连接器有限公司	
				X.X	±0.30			UNIT	mm		
				X.XX	±0.20	CHECK		SIZE	A4	PART NO.	PH-01496
A0	2012.03.28	NEW DRAWING		X.XXX	±0.10			SHEET	1/1	TITLE:	
REV	DATE	MODIFICATION DESCRIPTION		CHANGE	ANGLE	±3°	APPROVE	PROJ.		2.54PH 2H=2x2.5 2XNP DIP PA6.0 PC3.0 PB13.5 L=22.5 PA6T	
					DIM	TOL					