

ABIDE BY ROHS

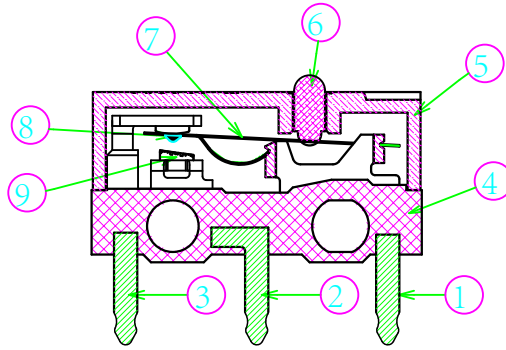

- Specification :
- 1. Rating : DC30V 0.1A ; Circuit: COM-NO
 - 2. Contact Resistance : 100mΩ Max
 - 3. Insulation Resistance : 100MΩ Min (DC250V)
 - 4. Withstand Voltage : AC500V (50-60Hz) for 1 minute
 - 5. Operation Force : 65±15gf
 - 6. Releasing Force : 20gf (Min)
 - 7. Operating Position : 6.90±0.2 mm
 - 8. Mechanical Life : 20,000,000 Cycles (min)

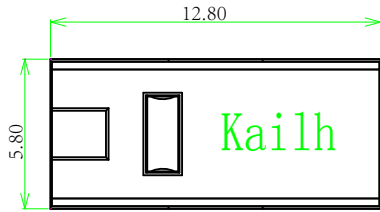
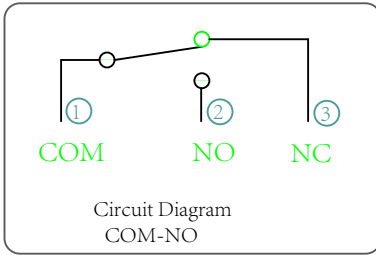
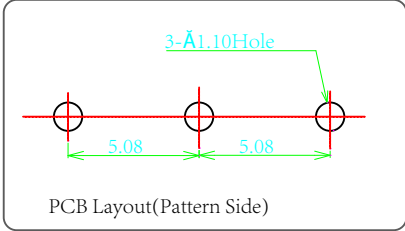
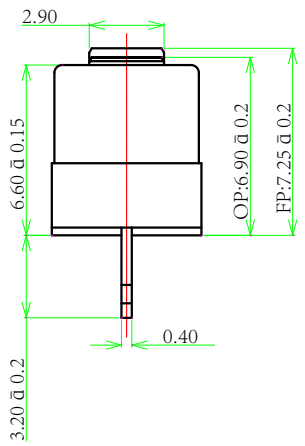
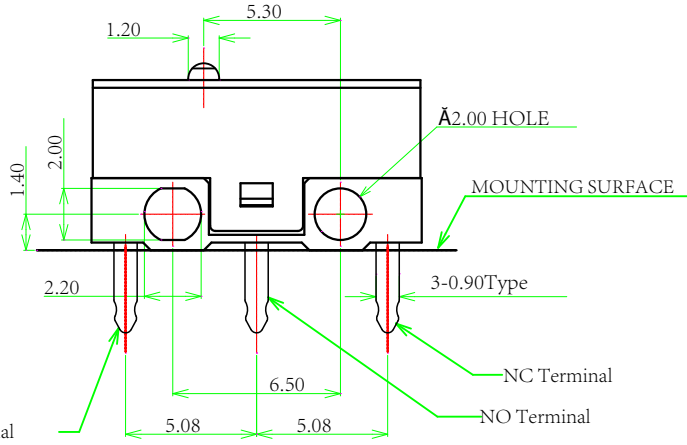

ITEM	PART NAME	TER. NO.	QTY.	MATERIAL	FINISHING	REMARK
⑨	Contact	1	1	Silver Alloy	Natural	
⑧	Contact	1	1	Composite gold	Natural	
⑦	Shrapnel	1	1	Copper Alloy	Natural	
⑥	Keystoke	1	1	POM	Red	
⑤	Cover	1	1	PBT	Black	
④	Base	1	1	PBT	Black	
③	Nc Terminal	3	1	BRASS	Ag-Plated	
②	No Terminal	2	1	BRASS	Ag-Plated	
①	Com Terminal	1	1	BRASS	Ag-Plated	

APPROVALS		DATE	东莞市凯华电子有限公司 DONGGUAN CITY KAIHUA ELECTRONICS CO.,LTD			
DRAWN	Shixijun	2013.12.11	TITLE: 20M Micro Switch			
CHECKED			Customer No.			
APPROVALS			PART NO. CMI126603D08			
TOLERANCES ARE		30 -A- ±0.30 10 -A- ±0.20 5 -A- ±0.15 4 -A- ±0.10	ANGLE	UNIT: mm	SCALE: 1:1	PROJ :
			±2°	DRAWING NO.	KHA-MI1266-001EN	SHEET 1 OF 1

ECN NO.	REV.	DATE.	DESCRIPTION.	CHANGE.	CHECK.	APPRO.
	C	2015.08.10	REDRAW		L.Zhang	
	A	2013.12.11	NEW		Shixijun	