

1 2 3 4 5 6 7 8 9 10

MAPX	MODIFICATION	DATE

A  
B  
C  
D  
E  
F  
G

A  
B  
C  
D  
E  
F  
G

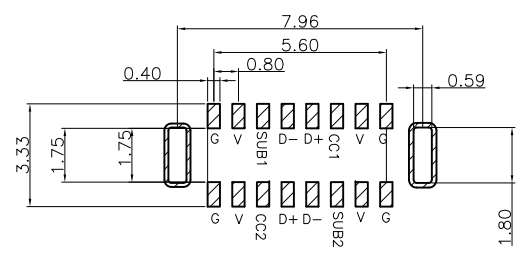
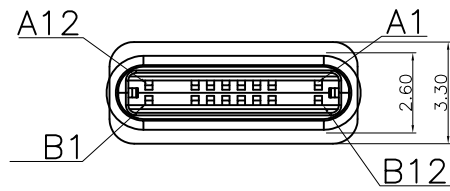

RECOMMENDED P.C.B. LAYOUT  
TOLERANCE UNSPECIFIED ±0.05mm

- 1.ELECTRICAL:  
CURRENT:3A  
CONTACT RESISTANCE:40 MILLIOHMS MAX  
DIELECTRIC WITHSTANDING VOLTAGE: 200V AC  
INSULATION RESISTANCE:100 MEGOHMS MIN
- 2.MECHANICAL:  
MATING FORCE:5-20N  
WITHDRAWAL FORCE:5-20N  
DURBILITY:10000 CYCLES
- 3.ENVIRONMENTAL:  
TEMPERTURE RANGE -40℃~105℃  
SALT TESTING:48 HOURS

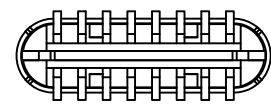
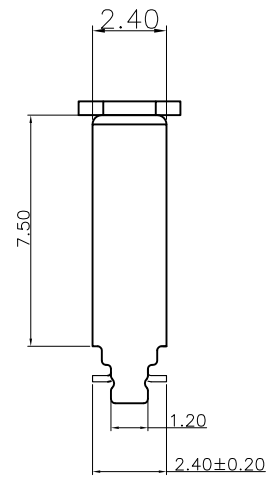
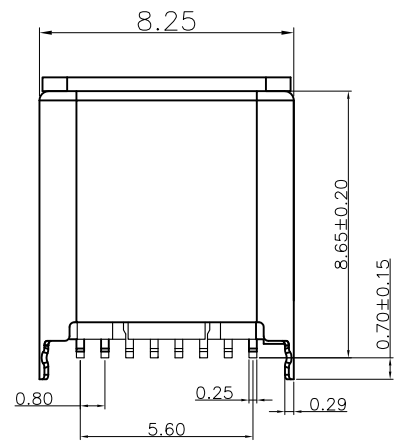

7				
6				
5				
4	PLASTIC	LCP	BLACK	UL 94V-0
3	Latch	SUS301	—	NI Plated
2	TERMINAL	C5191-H	—	Gold Plated
1	SHELL	SUS201	—	Ni Plated
NO.	DESCRIPTION	MATERIAL	COLOR	REMARK

<b>产品图</b> PRODUCT CHART DWG		<b>深圳市精拓金电子有限公司</b>									
公差一览表 TOLERANCE UNLESS OTHERWISE		单位 UNITS	MM	制图 DRAWING	YANG	制图料号 PRODUCT PART NO.	918-118A2021Y40006				
X.	±0.30	X.	±5.°	比例 SCALE	1:1	审核 CHKD	郭志富	产品名称 PRODUCT NO.	TYPE-C2.0公头立式8.65带固定脚L0.7LCP 黑胶双排SMT/16PIN+后塞		
.X	±0.25	.X	±2.°	日期 DATE	2019.11.23	核准 APPD	黄国荣	角法 VIEW		版本 VER	AO
.XX	±0.15	.XX	±1.°								
.XXX	±0.10	.XXX	±0.5°								

1 2 3 4 5 6 7 8 9 10