

REV.	ECN NO./DESCRIPTION	DATE
7	N130696	10/15'13
8	N150617	12/10'15
9	N160146	03/30'16

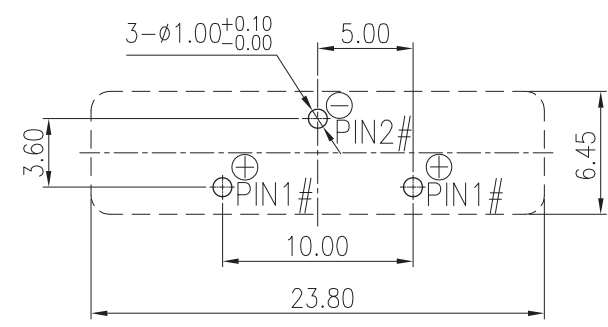

RECOMMENDED PCB LAYOUT(TOP VIEW)
(PCB THICKNESS:T=1.60mm)(TOLERANCE:±0.05)

- NOTES:
- MATERIAL:
HOUSING:PA66+30%G.F,UL94V-0;COLOR:SEE TABLE.
CONTACT MATERIAL:SEE TABLE
 - PLATING SPEC.:SEE TABLE.
 - ELECTRICAL PERFORMANCE:
LLCR:30mΩ MAX.
INSULATION RESISTANCE:1000MΩ MIN.
DIELECTRIC WITHSTAND VOLTAGE: 1000V AC FOR 1 MINUTE.
 - WAVE SOLDER:CONNECTOR MOUNTED ON THE PCB,THE TEMPERATURE OF THE SOLDER SHALL BE 260±5°C FOR 3~5 SECONDS.
 - RoHS OR HALOGEN FREE COMPLIANT.
 - PRODUCT NUMBER NOTE:

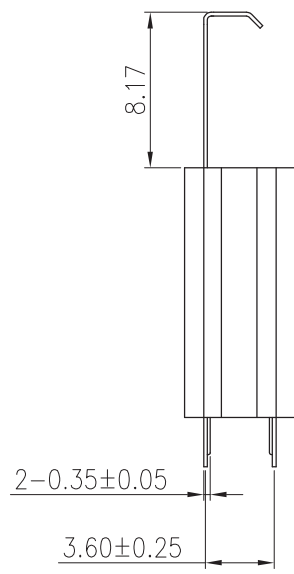
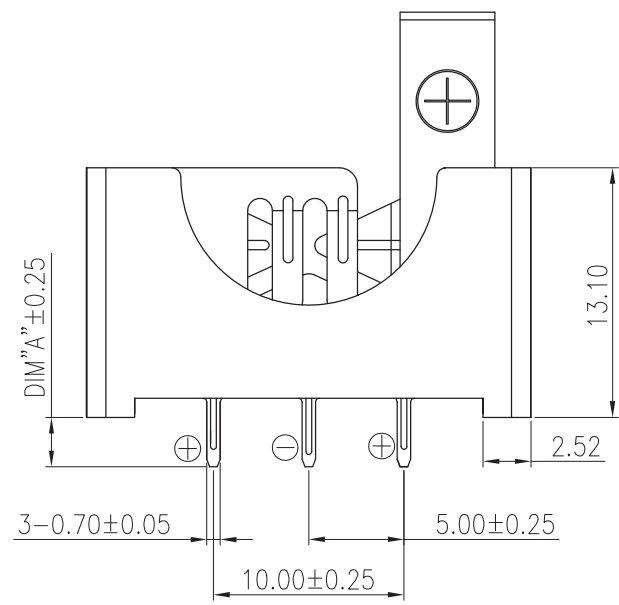
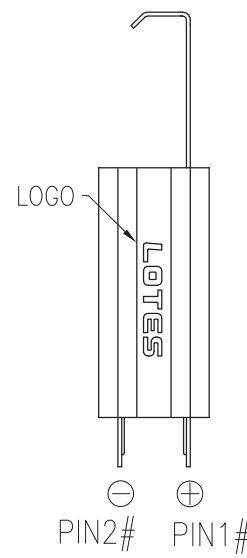
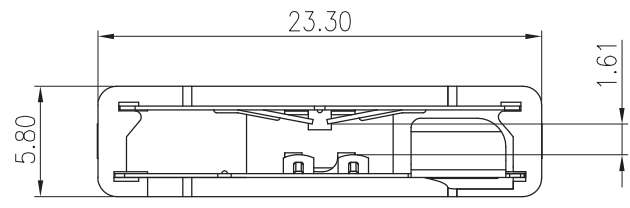
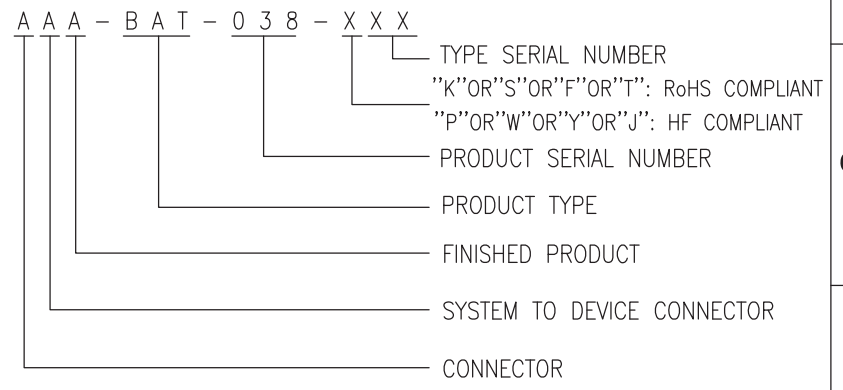

GENERAL TOLERANCES UNLESS SPECIFIED		PART NO.	LOTES			
SEE TABLE		SEE TABLE				
X ± 0.35	X° ± 3°	APPROVED BY	TITLE			
.XX ± 0.25	X° ± 2°	JIE LIAO	BATTERY HOLDER FOR CR2032			
.XXX ± 0.15	.XX° ± 1°	CHECKED BY	DWG NO.			
CUSTOMER DRAWING		YONG LIU	GAP-AAA-BAT-038			
SIZE	UNITS	DRAWN BY	DRAWN BY	SHEET	SCALE	REV
A4	mm[INCH]	PEIYU LOU				

REV.	ECN NO./DESCRIPTION	DATE
7	N130696	10/15'13
8	N150617	12/10'15
9	N160146	03/30'16

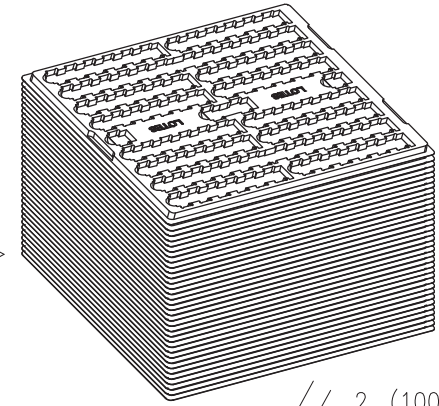
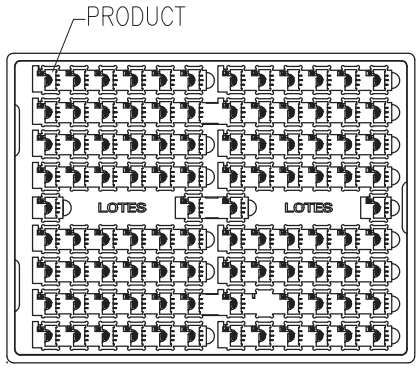
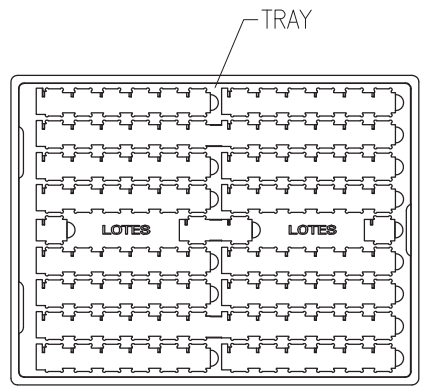

1Tray=100PCS

2. (100PCS*35Tray)+1Tray=3500PCS/Carton

TRANSPARENT GLUE TAPE

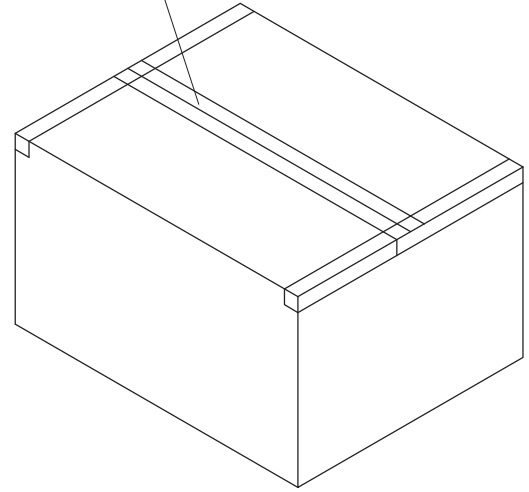

CARTON

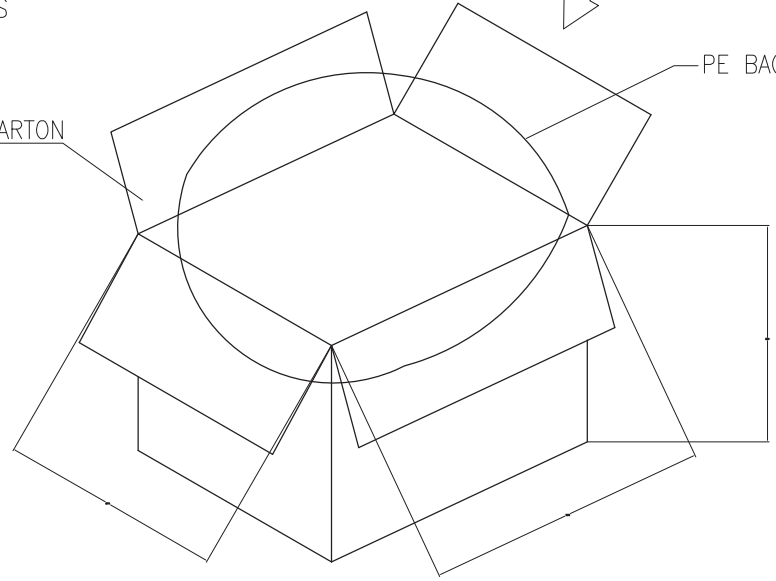

GENERAL TOLERANCES UNLESS SPECIFIED		PART NO.		LOTES				
SEE TABLE		SEE TABLE						
.X ± 0.35	X.° ± 3°	APPROVED BY		TITLE				
.XX ± 0.25	.X° ± 2°	JIE LIAO		BATTERY HOLDER FOR CR2032				
.XXX ± 0.15	.XX° ± 1°	CHECKED BY		DWG NO.				
CUSTOMER DRAWING		YONG LIU		GAP-AAA-BAT-038				
SIZE	UNITS	DRAWN BY		DRAWN BY		SHEET	SCALE	REV
A4	mm[INCH]	PEIYU LOU						
						2 / 2	1:1	9

TABLE

PART NO.	CONTACT MATERIAL	HOUSING COLOR	PLATING SPEC.	DIM"A"
AAA-BAT-038-K01 KB7566BP5L	PHOSPHOR BRONZE(C5191)	BLACK	BRIGHT TIN100u" MIN. PLATED ALL OVER;Ni50u" MIN. UNDERPLATING.	2.60
AAA-BAT-038-P01	PHOSPHOR BRONZE(C5191)	BLACK	BRIGHT TIN100u" MIN. PLATED ALL OVER;Ni50u" MIN. UNDERPLATING.	2.60
AAA-BAT-038-K02	PHOSPHOR BRONZE(C5191)	BLUE	BRIGHT TIN100u" MIN. PLATED ALL OVER;Ni50u" MIN. UNDERPLATING.	2.60
AAA-BAT-038-K03	PHOSPHOR BRONZE(C5191)	BLACK	Ni50u" MIN. UNDERPLATING;MATTE TIN100u" MIN. PLATED ON SOLDER TAIL.	2.60
AAA-BAT-038-K04	PHOSPHOR BRONZE(C5191)	BLACK	Ni50u" MIN. UNDERPLATING;MATTE TIN100u" MIN. PLATED ON SOLDER TAIL. Au1u" PLATED ON CONTACT AREA.	2.60
AAA-BAT-038-K05	PHOSPHOR BRONZE(C5191)	BLACK	Ni50u" MIN. PLATED ALL OVER	2.60
AAA-BAT-038-K07	STAINLESS STEEL(SUS304)	BLACK	Ni50u" MIN. UNDERPLATING;BRIGHT TIN100u" MIN. PLATED ON SOLDER TAIL.	2.60
AAA-BAT-038-K13	STAINLESS STEEL(SUS304)	BLACK	Ni50u" MIN. UNDERPLATING;MATTE TIN100u" MIN. PLATED ON SOLDER TAIL.	2.60
AAA-BAT-038-K11	PHOSPHOR BRONZE(C5191)	BLACK	Ni50u" MIN. UNDERPLATING;MATTE TIN100u" MIN. PLATED ON SOLDER TAIL. Au5u" PLATED ON CONTACT AREA.	2.60
AAA-BAT-038-K16	PHOSPHOR BRONZE(C5191)	BLACK	Ni50u" MIN. UNDERPLATING;MATTE TIN100u" MIN. PLATED ON SOLDER TAIL. Au1u" PLATED ON CONTACT AREA.	4.70
AAA-BAT-038-K19	PHOSPHOR BRONZE(C5191)	BLACK	Ni50u" MIN. UNDERPLATING;MATTE TIN100u" MIN. PLATED ON SOLDER TAIL. Au1u" PLATED ON CONTACT AREA.	4.70
AAA-BAT-038-K22	PHOSPHOR BRONZE(C5191)	BLACK	Ni50u" MIN. UNDERPLATING;MATTE TIN100u" MIN. PLATED ON SOLDER TAIL.	2.60
AAA-BAT-038-K20	PHOSPHOR BRONZE(C5191)	BLACK	BRIGHT TIN100u" MIN. PLATED ALL OVER;Ni50u" MIN. UNDERPLATING.	2.60