

# HSF

NOTES:  
 Rated Current:1.0AMP  
 Contact Resistance:20mΩ max  
 Withstand Voltage:500V AC/DC  
 Insulation Resistance:1000MΩ min  
 Operation Temperature:-40°C to +105°C

Contact Material:Brass  
 Contact Plating:Au or Sn Over Ni  
 Insulator Material:LCP+30%G.F UL94V-0

Recommended P.C.B Layout(Top Side)  
 (PCB BOARD TOLERANCE±0.05)

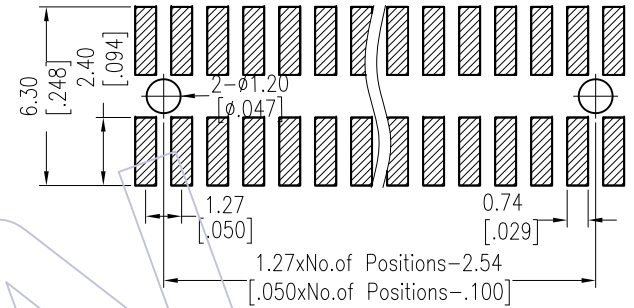
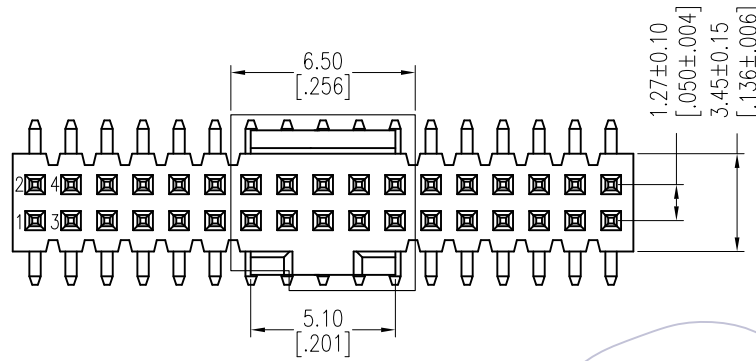

## Ordering Information

### 3132-XX M XX B K00 X X

| No.of Pins | Contact Plating   | Color Insulator | Packing         | Series No. |
|------------|-------------------|-----------------|-----------------|------------|
| 10 34      | G0=Gold Flash     | B=Black         | T=Tube          | 1=Type 1   |
| 14 40      | G3=10u"Gold       | W=White         | P=Tube+CAP      | 2=Type 2   |
| 16 44      | G4=15u"Gold       |                 | R=Tape&Reel+CAP |            |
| 20 50      | G5=30u"Gold       |                 |                 |            |
| 24 60      | S0=Gold Flash/Tin |                 |                 |            |
| 26 64      | S3=10u"Gold/Tin   |                 |                 |            |
| 30 80      | S4=15u"Gold/Tin   |                 |                 |            |
| 32 100     | S5=30u"Gold/Tin   |                 |                 |            |
|            | SN=Tin            |                 |                 |            |

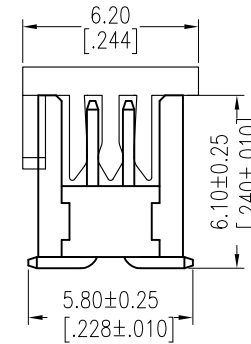
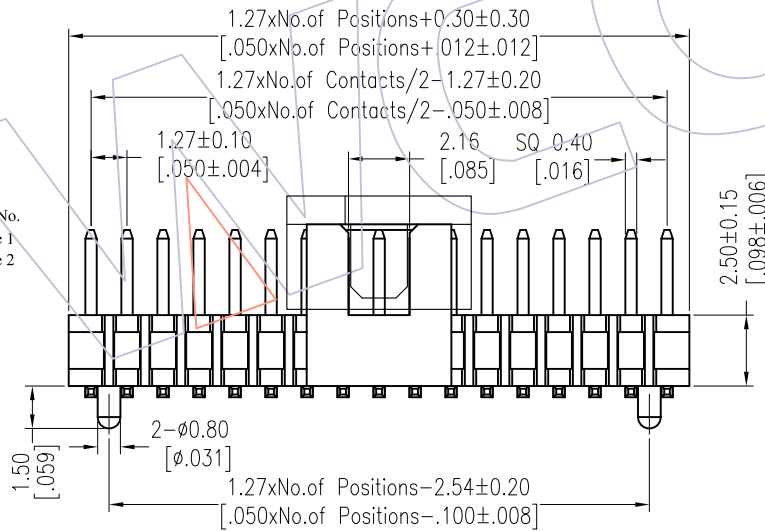

Type 1: W/O Post

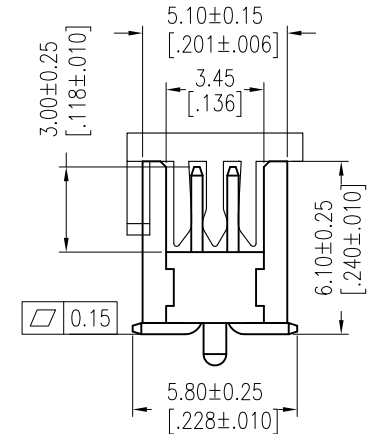

Type 2: With Post

| Item      | Pitch | Mating |
|-----------|-------|--------|
| Standard  | 1.27  | 5232   |
| Alternate |       |        |

| REV | DATE | MODIFICATION DESCRIPTION | CHANGE | OPERATION   | DRAW    | DATE       | SCALE | FIT | PART NO.                                 |
|-----|------|--------------------------|--------|-------------|---------|------------|-------|-----|--|
|     |      |                          |        | x.x ±0.40   | JYHuang | 2012/09/15 | UNIT  | mm  | 3132-XXMXXBK00XX                         |
|     |      |                          |        | x.xx ±0.25  | CHECK   | DATE       | SIZE  | A4  |  |
|     |      |                          |        | x.xxx ±0.15 | APPROVE | DATE       | SHEET | 1/1 | TITLE:<br>1.27mm BOX SMT "S" TYPE H=6.10 |
|     |      |                          |        | Angle ± 3'  |         |            | PROJ. |     | Customer NO.                             |
|     |      |                          |        | DIM TOL     |         |            |       |     |  |

**WCON**  
 Http: www.wcon.com

WCON-Dongguan  
 Tel: +86 769 85358920  
 Fax: +86 769 85358915  
 E-mail: sales@wcon.com

WCON-Kunshan  
 Tel: +86 512 57468408  
 Fax: +86 512 57468468  
 E-mail: salesks@wcon.com