

**SPECIFICATIONS:**

- INSULATION RESISTANCE: VOLTAGE OF 500V D.C. SHALL BE APPLIED TO THE TERMINALS, AFTER WHICH MEASUREMENT SHALL BE MADE. A GAUGE FOR THE MEASUREMENT SHALL BE USED THE INSULATED GAUGE.
- CONTACT RESISTANCE: 30mΩ OR LESS
- VOLTAGE PROOF: 500V AC FOR ONE MINUTE
- DURABILITY: 10,000 INSERTION/REMOVAL CYCLES (MINIMUM)
- INSERTION FORCE: 0.4KGF~2.0KGF
- WITHDRAWAL FORCE: 0.4KGF~2.0KGF
- WATER PROOFNESS: THIS PRODUCT IS CONFORM TO JIS STANDARD IPX7 BY WATERPROOF JACK
- USING PLUG: φ3.5MM, 4-POLE STEREO EARTHONE (LCH/RCH/SND/MIC)

PROVIDED THAT THEY CONFORM TO JIS C6560 9-0-RING ASSEMBLY AREA TO MAINTAIN SMOOTH, SHALL HAVE NO BURRS

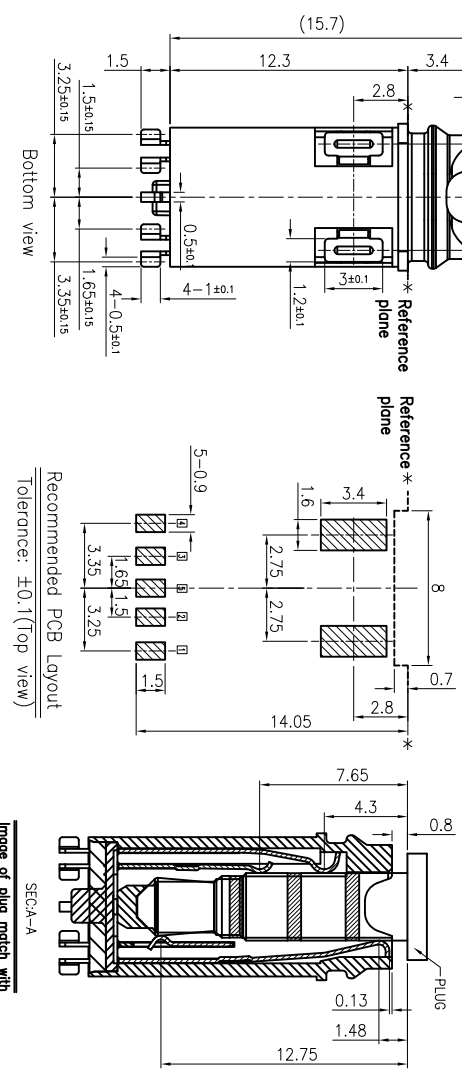
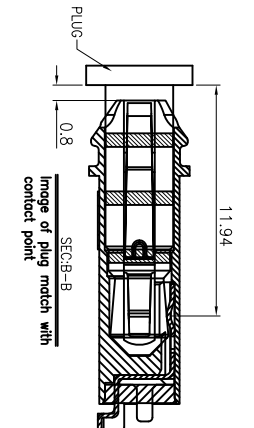
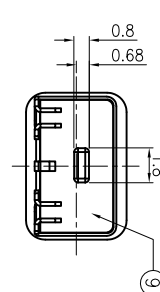
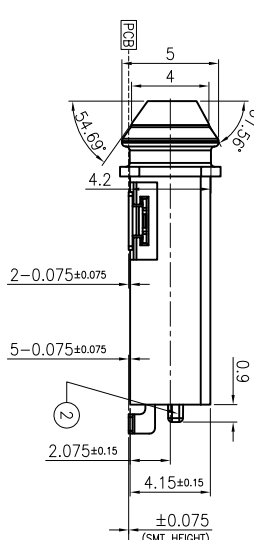
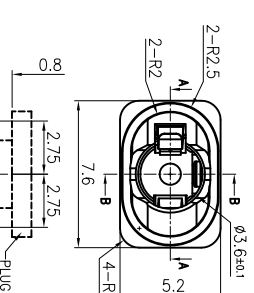

UNLESS OTHERWISE SPECIFIED, TOLERANCE ON DECIMAL: ±0.2

Image of plug match with contact point

ITEM	PART NAME	TERMINAL	QTY	MATERIAL	REMARK
①	HOUSING	---	1	PA9T(BLACK)	UL 94V-0
②	COVER	---	1	PA9T(BLACK)	UL 94V-0
③	EARTH SPRING	1	1	Ti-Cu t=0.2	tstkt(μm or mee)/znc/d(μm 0.05μm or mee)/P(μm)
④	TIP SPRING-1	1	1	Ti-Cu t=0.2	tstkt(μm or mee)/znc/d(μm 0.05μm or mee)/P(μm)
⑤	RING SPRING-1	1	1	Ti-Cu t=0.2	tstkt(μm or mee)/znc/d(μm 0.05μm or mee)/P(μm)
⑥	RING SPRING-2	1	1	Ti-Cu t=0.2	tstkt(μm or mee)/znc/d(μm 0.05μm or mee)/P(μm)
⑦	TIP SPRING-2	1	1	Ti-Cu t=0.2	tstkt(μm or mee)/znc/d(μm 0.05μm or mee)/P(μm)
⑧	TERMINAL	---	2	C2680 t=0.2	tstkt(μm or mee)/znc/d(μm 0.05μm or mee)/P(μm)
⑨	BOND	---	1	---	---

MARK	DESCRIPTION	DATE	REVISED	APPROVED	UNSPECIFIED TOLERANCES
ΔX					ANGULAR ±5°
ΔX					X.X ±0.2mm
ΔX					X.XX ±0.1mm
ΔX					X.XXX ±0.05mm
REVISIONS					
www.xk-dg.com www.hellokcb.com www.hellokcb.com					
XKB INDUSTRIAL PRECISION CO., LIMITED					
DSND	DATE	SCALE: N/A	MODEL TYPE:	3.5 PHONE JACK	
DWN	DATE	VIEW: ①	PART NO.:	PJ-3255A	
CHKD	DATE	UNIT: mm	DWG NO.:	PJ-3255A	
APPD	DATE	SIZE: A4	WEIGHT	SHEET	REVISION
			1.0g	1/1	A0

# IP-X7