

REV	LOCATIONS	DESCRIPTION	DATE	REVISER	APPD

Electrical
 Temperature Range—Operating: -25°C~+85°C
 Material
 Housing: PA66(UL 94V-0)
 Applicable Terminal: FT35001
 Mates With(Housing): FHG35002 Series
 Mates With(Wafer): FWF35001,FWF35002 Series

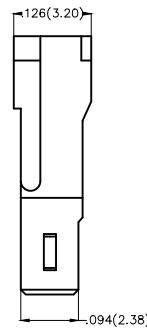
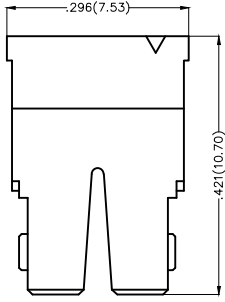
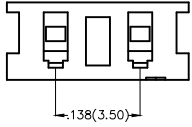

Ordering Information

FHG 350 01 — S 02 M 2 W1 B
 1 2 3 4 5 6 7 8 9

1	Category FHG—Housing	2	Series Number 350—Pitch 3.5mm	3	Distinction No. 01	4	Row Option S—Single Row	5	Circuits 02
6	Entry Type M—Male	7	Material—Resin 2—PA66	8	Color—Resin W1—White	9	Packaging B—PE Bag		

 THIRD ANGLE PROJECTION	GENERAL TOLERANCES (UNLESS SPECIFIED)		APPROVE BY FRANK	DATE 25/JUN/13	PART NO. FHG35001-S02M2W1B	ITEM NO. FHG35001	 Leader Of Industry
	DESIGN UNITS Inch (metric)	X.±.012(0.30) X.±5' X.X±.008(0.20) .X±2'	CHECKED BY JACOB	DATE 25/JUN/13	TITLE Wire to Board Pitch 3.5mm(Housing)		
SCALE 5:1	SIZE A4	X.XX±.006(0.15) .XX±1' X.XXX±.004(0.10) .XXX±0.5'	DRAWN BY CHERRY	DATE 25/JUN/13	THIS DRAWING CONTAINS INFORMATION THAT IS PROPRIETARY TO TXGA INDUSTRIAL ELECTRONICS(S.Z)CO.,LTD AND SHOULD NOT BE USED WITHOUT WRITTEN PERMISSION		