

SCHMATIC

SS24E01- X

L(MM)
2~10

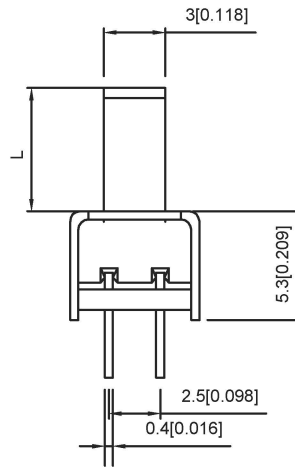
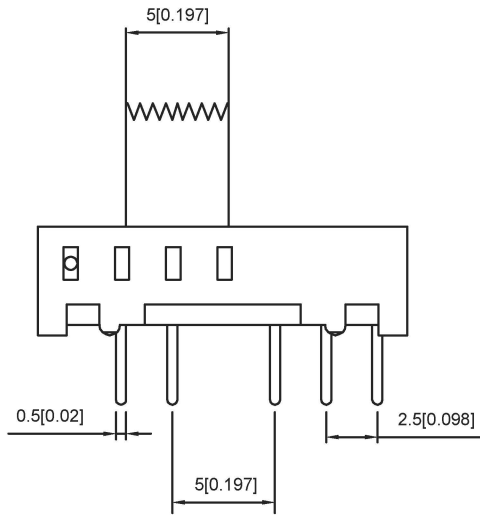

| | |
|--------------------|-------------|
| RATING | 0.3A 50V DC |
| CIRCUIT | 1P2T |
| CONTACT RESISTANCE | 100MΩ MAX |
| TRAVEL | 2MM |
| OPERATING FORCE | 250±100gf |
| OPERATING LIFE | 10000 |

广东星坤科技股份有限公司

生效日期

文件工程章

| REVISIONS | DATE | REVISED | APPROVED | DESCRIPTION |
|-----------|------|---------|----------|-------------|
| | | | | |
| | | | | |
| | | | | |

| | | | | | |
|---------------------------------------|--|------|--|----------------|-----------------------------|
| DSND | | DATE | | SCALE: N/A | MODEL TYPE: SLIDE SWITCH |
| DWN | | DATE | | VIEW: | PART NO.: SS24E01 |
| CHKD | | DATE | | UNIT: mm/in | DWG NO.: SS24E01X |
| APPD | | DATE | | SIZE: A4 | |
| XKB INDUSTRIAL PRECISION CO., LIMITED | | | | WEIGHT 1.0g | SHEET 1/1 |
| UNSPECIFIED TOLERANCES | | | | | REVISION A0 |

www.helloxkb.com www.helloxkb.cn