

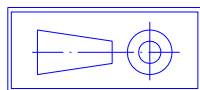

LTEM NO.:SMO-015-C

(L26.30×W19.30×H1.90 SIM CARD SOCKETS)

Unit:mm



尺寸范围	未注公差值
0~3	±0.1
3~6	±0.15
6~9	±0.2
9~12	±0.25
12~15	±0.3

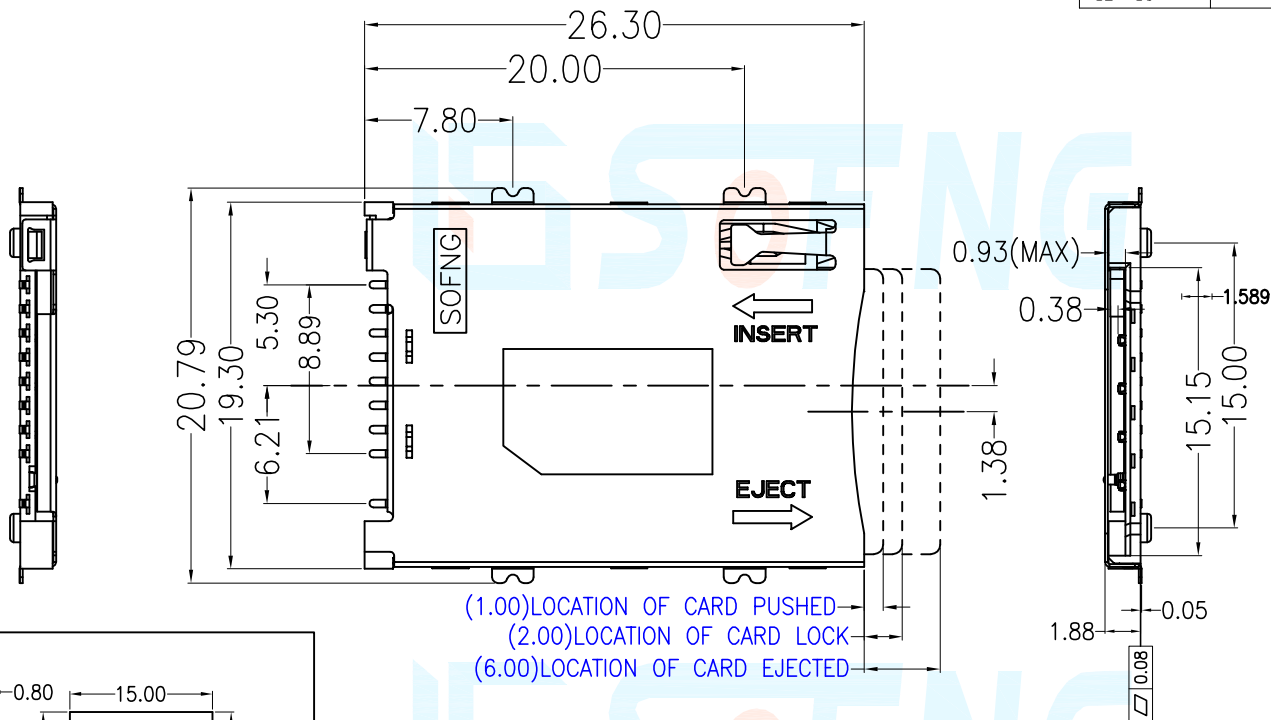
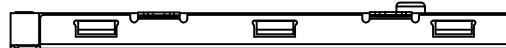

(1.00)LOCATION OF CARD PUSHED  
(2.00)LOCATION OF CARD LOCK  
(6.00)LOCATION OF CARD EJECTED

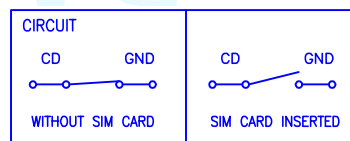
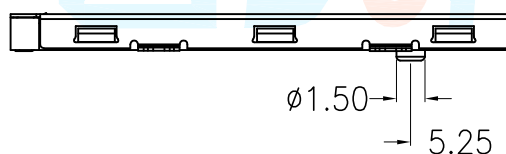
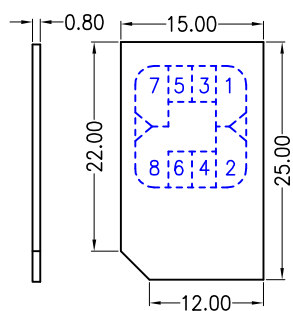

Technical parameter

PROJECT		LEVEL	A[better product]	B[average product]	C[low product]
Electrical Properties	Initial Contact Resistance		30mΩ max.	30mΩ max.	no data!
	Contact Resistance		100MΩ min. 100V DC Skey/PD: 50MΩ min. 100V DC		
	Withstand Voltage		300V AC for 1min	250 V AC for 1min	
Durable Performance	There No Load		8,000 Cycles	7,000 Cycles	no data!
	Rated Load		6,500 Cycles 50mΩ max.	5,000 Cycles 30mΩ max.	no data!
Insertion Force			4.0Kgf MAX (Springback: )		

表面貼裝 SMT

側向導入 LATERAL

精密部品 NICETY

可靠 STABILIZE

適合環保 RoHS

## CIRCUIT BOARD SIZE (Vertical view)

**Operating Force**  
Inward  
Exiting

8.0~12.0N. (1N.=100gram-force)  
10N. [±100gf]

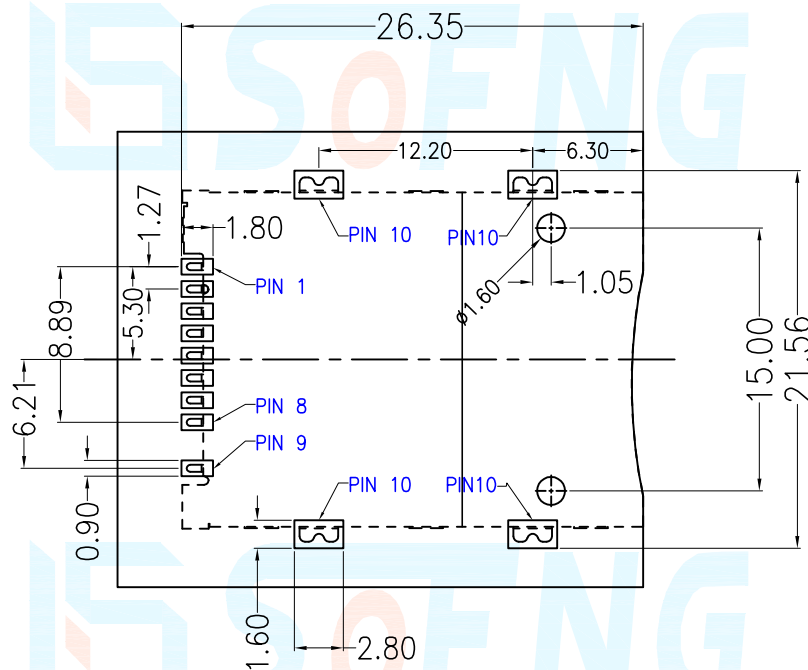

### SIM CARD Pin DESIGN

Pin No.	Pin NAME	Type	Description
PIN①	卡電源	1	VCC
PIN②	接地	1	GND
PIN③	復位	1	RST
PIN④	Vpp	1	VPP
PIN⑤	時鐘	1	CLK
PIN⑥	輸入/輸出	1	I/O
PIN⑦	DAT	1	DAT 0
PIN⑧	MCMD	1	MCMD
PIN⑨	檢測	1	CARD DETECT Switch
PIN⑩	接地	1	GND

### PIN Assignment

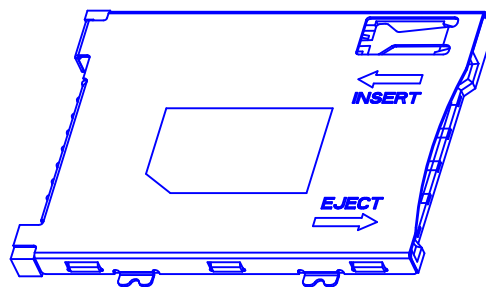

### Material declaration

No.	NAME	MATERIAL	PLATING
① A	基座	LCP 30%G/F (Black)耐热塑胶	-
② B	滑块	PA6T 30%G/F (Black)耐热尼龙	SET
③ C	接触端子	C5191R-H (t=0.15mm)磷青铜【锡 30u" 基镀金 1u"】	G/F
④ D	外壳	SUS301-3/4H(t=0.25mm)不锈钢【焊点镀金 1u"】	G/F
⑤ E	线簧	象唎钢线 OD=0.21mm	-
⑥ F	弹簧	SUS304(t=0.30mm)不锈钢	-

### 注記 NOTICE

1. 碩方電子公司擁有最終解釋權；The company reserves the right of final interpretation;
2. 文件禁止外洩、轉載；Leaked and reproduced prohibited;
3. 未經授權修改無效。Modify is invalid.