



NOTES:

Current Rating: 2.0AMP
 Contact Resistance: 20mΩ Max
 Withstand Voltage: 500V AC/DC
 Insulation Resistance: 1000MΩ Min
 Operation Temperature: -40°C to +105°C

Contact Material: Brass
 Contact plating: Au Or Sn over Ni
 Insulator Material: PA9T+30%G.F. UL94V-0

Ordering Information

3220 - XX S XX B X X 1

- | | | | | |
|-------------|-------------------|-----------------|---------------|---------|
| No. of Pins | Contact Plating | Insulator Color | Latch type | Packing |
| 08 30 | GF=Gold Flash | B=Black | L=Long Latch | T=Tube |
| 10 34 | G3=10" Gold | U=Blue | S=Short Latch | |
| 14 40 | G4=15" Gold | G=Grey(427C) | | |
| 16 44 | G5=30" Gold | F=Grey(413C) | | |
| 20 50 | S0=Gold Flash/Tin | | | |
| 24 60 | S3=10" Gold/Tin | | | |
| 26 64 | S4=15" Gold/Tin | | | |
| 68 | S5=30" Gold/Tin | | | |
| | SN=Tin | | | |

Item	Pitch	Mating
Standard	2.00	5222
Alternate		

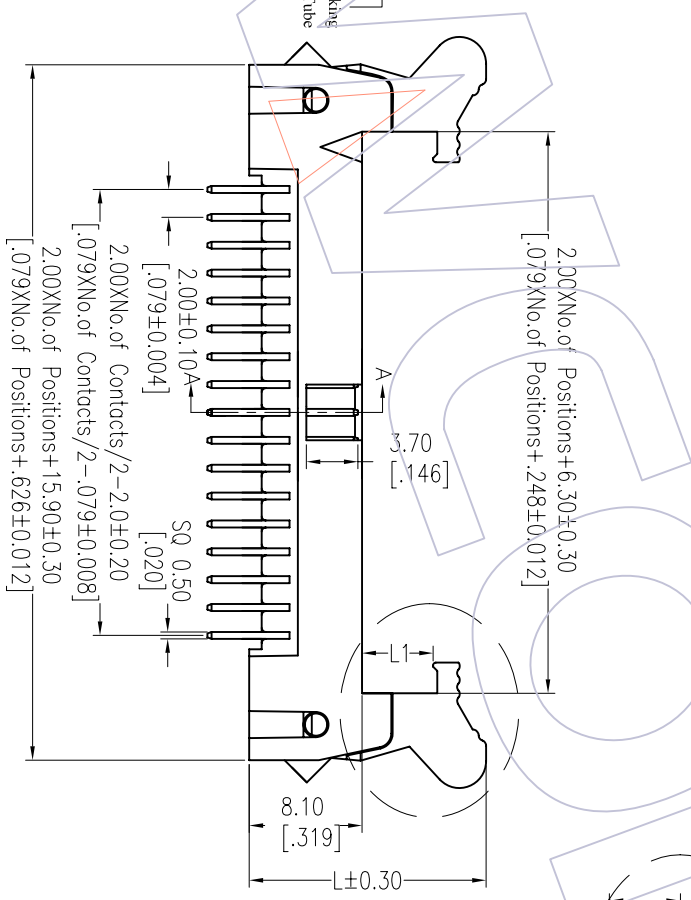
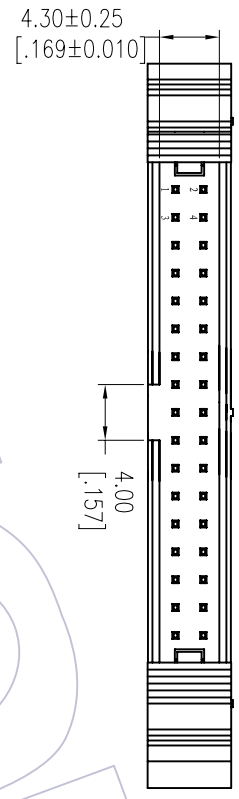

Recommended P.C.B Layout(Top Side)
 (PCB BOARD TOLERANCE±0.05)

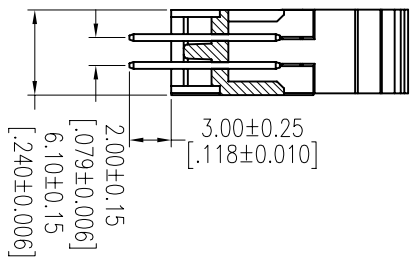
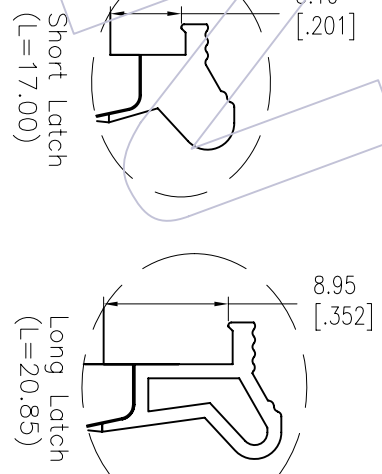
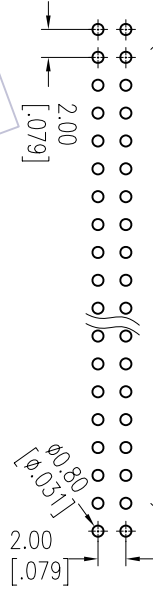

REV	DATE	MODIFICATION DESCRIPTION	CHANGE
A1	2012/12/24	MODIFY THE NOTES:Phosphor Bronze→Brass	
A0	2012/10/08	NEW	

OPERATION	DRAW	DATE	SCALE	FIT	PART NO.
XX	JYHuang	2012/12/24	mm		3220-XXXXXXBXX1
CHECK	CHECK	DATE	UNIT		TITLE:
XX			A4		2.00 EJECTOR HEADER 180°
APPROVE	APPROVE	DATE	SHEET		Customer NO.
			1/1		
PROJ.					



Http: www.wcon.com

WCON-Dongguan
 Tel: +86 769 85358920
 Fax: +86 769 85358915
 E-mail: sales@wcon.com

WCON-Kunshan
 Tel: +86 512 57468408
 Fax: +86 512 57468468
 E-mail: sales@wcon.com