

NOTES:
 Current Rating: 3.0AMP
 Contact Resistance: 20mΩ Max
 Withstand Voltage: 500V AC/DC
 Insulation Resistance: 1000MΩ Min
 Operation Temperature: -55℃ to +105℃

Contact Material: Phosphor Bronze/Brass
 Contact plating: Sel. Au over Ni
 Insulator Material: PBT+30%G.F UL94V-0
 Sheel: Cold Roller Steel, Ni Plated
 Nut: Brass, Sn over Ni Plated

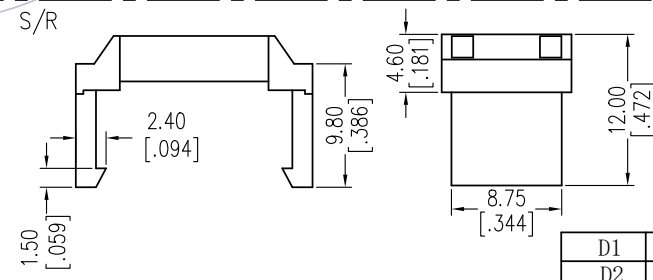
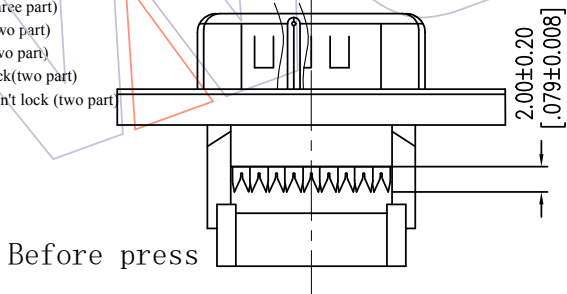
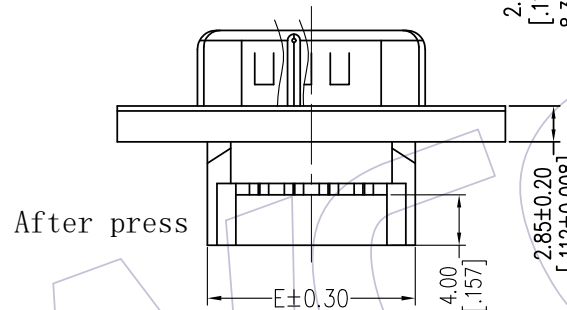
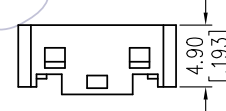
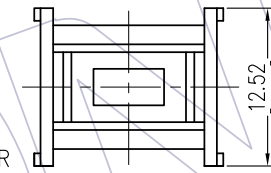
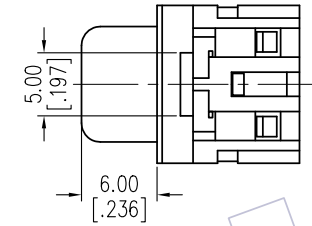
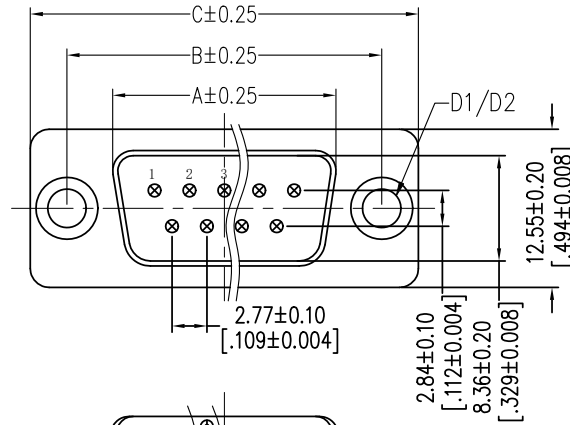

Ordering Information

6224-XX M N XX X 0 X

- | | | | |
|--------------|--|-------------------|---|
| No. of Pins | Contact Plating | Insulator Color | Screw |
| 09,15,25,37P | S0=Gold Flash/Ni
S3=10u"Gold/Ni
S4=15u"Gold/Ni
S5=30u"Gold/Ni | B:Black
U:Blue | 1=W/O Screw thread(three part)
2=W/T Screw thread(three part)
3=W/O Screw thread(two part)
4=W/T Screw thread(two part)
5=W/T Screw thread,Don't lock(two part)
6=W/T Screw thread&Nut,Don't lock (two part) |



D1	6224-XXMNXXX01/3
D2	6224-XXMNXXX02/4

No. of Positions	DIM "A"	DIM "B"	DIM "C"	DIM "D"		DIM "E"
				W/O Screw thread	W/T Screw thread	
09	17.78	24.99	30.82			16.90
15	26.15	33.32	39.24	∅3.05	∅3.05, #4-40	25.60
25	39.94	47.04	53.04			38.90
37	56.56	63.50	69.62			55.60

A3	2019/07/30	Modify		OPERATION	DRAW	DATE	SCALE	FIT	PART NO.
A2	2017/03/01	Modify		x.x ±0.40	Ding	2019/07/30	UNIT	mm	SEE TABLE
A1	2015/12/14	Modify	-----	x.xx ±0.25	CHECK	DATE	SIZE	A4	TITLE:
A0	2012/12/06	NEW	-----	x.xxx ±0.15	APPROVE	DATE	SHEET	1/1	D-SUB MALE DUAL ROW IDC TYPE
REV	DATE	MODIFICATION DESCRIPTION	CHANGE	Angle ± 3°			PROJ.		Customer NO.
				DIM	TOL				

WCON
 Http: www.wcon.com

WCON-Dongguan
 Tel: +86 769 85358920
 Fax: +86 769 85358915
 E-mail: sales@wcon.com

WCON-Kunshan
 Tel: +86 512 57468408
 Fax: +86 512 57468468
 E-mail: salesks@wcon.com