

# HSF

NOTES:  
 Rated Current: 1.0AMP  
 Contact Resistance: 20mΩ Max.  
 Withstand Voltage: 500V AC/DC  
 Insulation Resistance: 1000MΩ Min.  
 Operation Temperature: -40°C to +105°C

Contact Material: Brass  
 Contact Plating: Au or Sn Over Ni  
 Insulator Material: PA9T+33%G.F UL94V-0 BK

Recommended P.C.B Layout (Top Side)  
 (PCB BOARD TOLERANCE ±0.05)

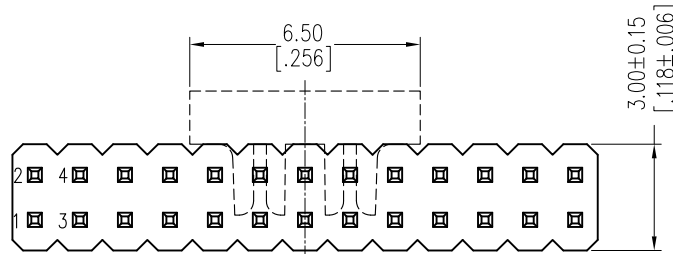

Odd Number

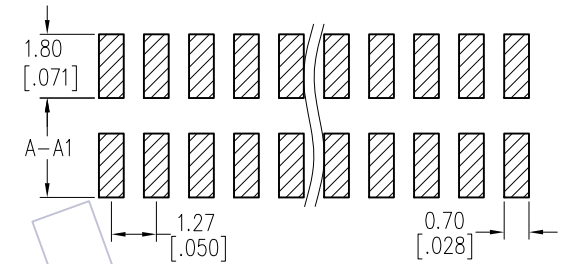

Dual Numbers  $\triangle$

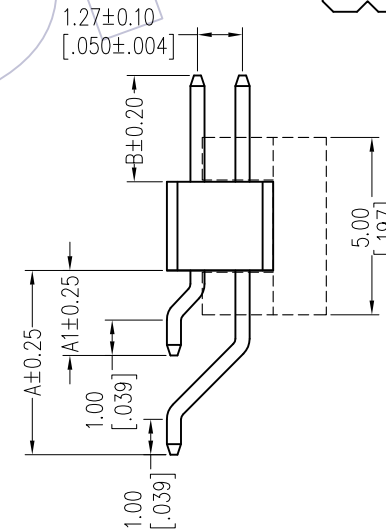
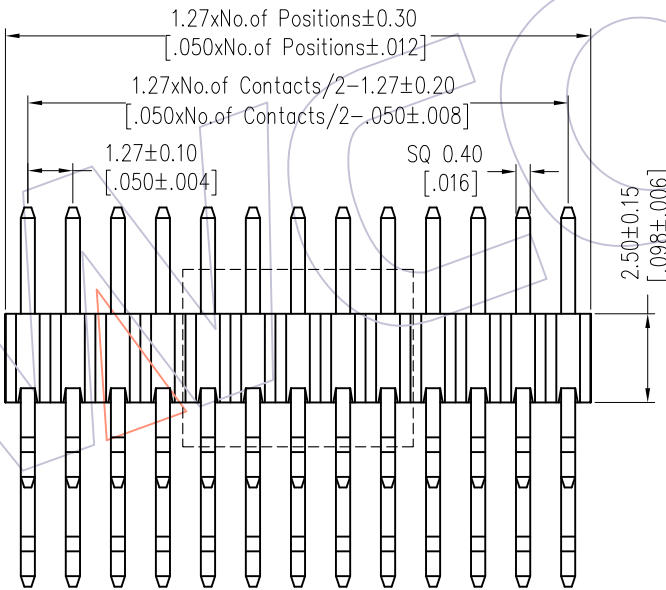

## Ordering Information

1325-12 XX XX Z XXX C R XX

No. of Pins	Contact Plating	Pin Length(Short)	Insulator	Series No.
Per Row: 01~50	G0=Gold Flash	L=A1+B+2.8	C=PA9T	01~99
	G3=10u"Gold	Standard: 071=7.1		
	G4=15u"Gold	082=8.2		
	G5=30u"Gold	092=9.2		
	S0=Gold Flash/Tin			Packing
	S3=10u"Gold/Tin			A=Tray
	S4=15u"Gold/Tin			T=Tube
	S5=30u"Gold/Tin			P=Tube+CAP
	SN=Tin			R=Tape&Reel+CAP
	SM=Matte Tin			

Item	Pin Length	A1	A	B	Mating
Standard	7.1	2.40	5.20	1.90	2321
	8.2	2.40	5.20	3.00	2334
	9.2	2.40	5.20	4.00	2344
Alternate					

REV	DATE	MODIFICATION DESCRIPTION	CHANGE	OPERATION	DRAW	DATE	SCALE	Fit	PART NO.
A2	2018/01/18	MODIFY PART NO.	-----	x.X ±0.40	William Chen	2018/01/18	UNIT	mm [inch]	1325-12XXXXZXXXCXXX $\triangle$
A1	2013/06/07	Modify Drawing	-----	x.XX ±0.25	CHECK	DATE	SIZE	A4	TITLE:
A0	2012/03/31	NEW	-----	x.XXX ±0.15	APPROVE	DATE	SHEET	1/1	1.27 Pin Header, DUAL ROW, R/A&SMT, WITHOUT POST, H=2.5
				Angle ± 3°			PROJ.	$\phi$	Customer NO.
				DIM TOL					

# WCON

Http: www.wcon.com

WCON-Dongguan Tel: +86 769 85358920  
 WCON-Kunshan Tel: +86 512 57468408  
 Fax: +86 769 85358915  
 Fax: +86 512 57468468  
 E-mail: sales@wcon.com  
 E-mail: salesks@wcon.com