

REV	LOCATIONS	DESCRIPTION	DATE	REVISER	APPD

Electrical

Current Rating: 0.5A AC(rms)/DC
Voltage Rating: 50V AC(rms)/DC
Contact Resistance: 50 mΩ Max
Insulation Resistance: 500 MΩ MIN
Withstanding Voltage: 250V AC r.m.s
Temperature Range—Operating: -40°C~+105°C

Material and Plating

Housing: LCP(UL 94V-0)
Contact Pin: Phosphor Bronze
Plating: Gold Plated

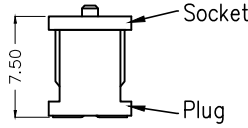
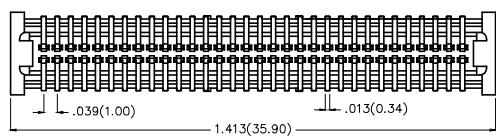
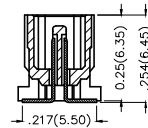
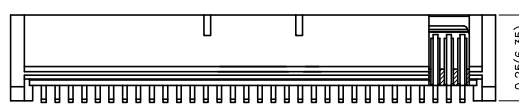
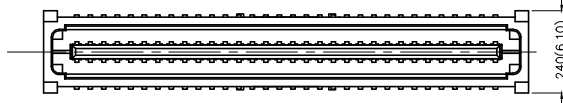

Mating Section

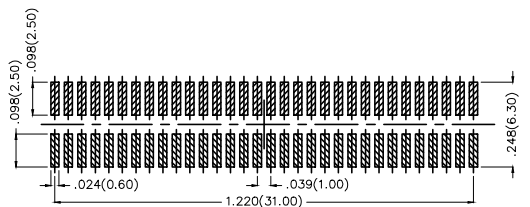

Recommended P.C.Board Layout

Ordering Information

FBB 100 01 — M 64 S 1 XX 3 W5 M
1 2 3 4 5 6 7 8 9 10 11

1 Category FBB—Board To Board	2 Series Number 100—Pitch1.0mm	3 Distinction No. 01	4 Type M—Male	5 Circuits 64	6 Entry Angle S—180° Vertical
7 Plating 1—Gold Plated	8 Thickness of Plating 00—Gold Flash 02—2μ" Custom plate available	9 Material—Resin 3—LCP	10 Color—Resin W5—Natural	11 Packaging M—Reel	

 THIRD ANGLE PROJECTION	GENERAL TOLERANCES (UNLESS SPECIFIED)		APPROVE BY FRANK	DATE 26/SEPT/13	PART NO. FBB10001—M64S1XX3W5M	TEM NO. FBB10001—M	 Leader Of Industry	
	DESIGN UNITS Inch (metric)	X.X±.012(0.30) X.XX±.008(0.20) X.XXX±.004(0.10)	X.'±5" .X'±2" .XX'±1" .XXX'±0.5"	CHECKED BY CHERRY	DATE 26/SEPT/13	TITLE Board to Board Pitch 1.0mm 180° Vertical (SMT)		REV 0
SCALE 5:1	SIZE A4		DRAWN BY JACOB	DATE 26/SEPT/13	THIS DRAWING CONTAINS INFORMATION THAT IS PROPRIETARY TO TXGA INDUSTRIAL ELECTRONICS(S.Z.)CO.,LTD AND SHOULD NOT BE USED WITHOUT WRITTEN PERMISSION			