

CUSTOMER :
CUSTOMER P/N:

PRODUCT DIMENSIONS

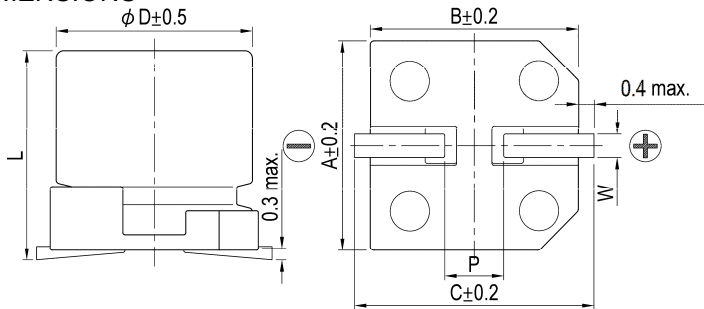

Unit: mm

ϕ D	6.3
L	5.9+0.1/-0.3
A	6.6
B	6.6
C	7.2
W	0.5~0.8
P	2.0 \pm 0.2

Items	Performance																		
Rated Voltage V_R	25 V																		
Capacitance C_R	56 μ F (120 Hz, 20 $^\circ$ C)																		
Category Temperature Range	-55 $^\circ$ C ~ +105 $^\circ$ C																		
Capacitance Tolerance	-20 % ~ +20 % (120 Hz, 20 $^\circ$ C)																		
Surge Voltage V_S	29.0 V _{DC}																		
Leakage Current (20 $^\circ$ C)	$I_{LEAK} \leq 280 \mu$ A After 2 minutes																		
Tan δ	≤ 0.12 (120 Hz, 20 $^\circ$ C)																		
ESR _{max.}	< 49 m Ω (100k ~300k Hz, 20 $^\circ$ C)																		
Ripple Current ($I_{AC, R}$ / rms)	1300 mA (100k Hz, 105 $^\circ$ C)																		
Ripple Current (mA) and Frequency Multipliers	<table border="1"> <thead> <tr> <th>Frequency (Hz)</th> <th>120 \leq f < 1k</th> <th>1k \leq f < 10k</th> <th>10k \leq f < 100k</th> <th>100k \leq f < 500k</th> </tr> </thead> <tbody> <tr> <td>Multiplier</td> <td>0.05</td> <td>0.3</td> <td>0.7</td> <td>1.0</td> </tr> </tbody> </table>	Frequency (Hz)	120 \leq f < 1k	1k \leq f < 10k	10k \leq f < 100k	100k \leq f < 500k	Multiplier	0.05	0.3	0.7	1.0								
Frequency (Hz)	120 \leq f < 1k	1k \leq f < 10k	10k \leq f < 100k	100k \leq f < 500k															
Multiplier	0.05	0.3	0.7	1.0															
Endurance and Moisture Resistance	<table border="1"> <thead> <tr> <th>Items</th> <th>Endurance</th> <th>Moisture Resistance</th> </tr> </thead> <tbody> <tr> <td>Test Time</td> <td>5,000 Hrs at 105$^\circ$C; V_R</td> <td>1,000 Hrs at 60$^\circ$C; 90 ~ 95% R. H.</td> </tr> <tr> <td>Cap. Change</td> <td>Within \pm20 % of initial value</td> <td>Within \pm20 % of initial value</td> </tr> <tr> <td>Tan δ</td> <td>Less than 150% of specified value</td> <td>Less than 150% of specified value</td> </tr> <tr> <td>ESR</td> <td>Less than 150% of specified value</td> <td>Less than 150% of specified value</td> </tr> <tr> <td>Leakage Current*</td> <td>Within specified value</td> <td>Within specified value</td> </tr> </tbody> </table>	Items	Endurance	Moisture Resistance	Test Time	5,000 Hrs at 105 $^\circ$ C; V_R	1,000 Hrs at 60 $^\circ$ C; 90 ~ 95% R. H.	Cap. Change	Within \pm 20 % of initial value	Within \pm 20 % of initial value	Tan δ	Less than 150% of specified value	Less than 150% of specified value	ESR	Less than 150% of specified value	Less than 150% of specified value	Leakage Current*	Within specified value	Within specified value
Items	Endurance	Moisture Resistance																	
Test Time	5,000 Hrs at 105 $^\circ$ C; V_R	1,000 Hrs at 60 $^\circ$ C; 90 ~ 95% R. H.																	
Cap. Change	Within \pm 20 % of initial value	Within \pm 20 % of initial value																	
Tan δ	Less than 150% of specified value	Less than 150% of specified value																	
ESR	Less than 150% of specified value	Less than 150% of specified value																	
Leakage Current*	Within specified value	Within specified value																	
Standards	JIS C 5101-25, IEC 60384-4																		
Remarks	RoHS Compliance, Halogen-free																		

* For any doubt about measured values, measure the leakage current again after the following voltage treatment.
Voltage treatment: Applying DC rated voltage to the capacitors for 2 hours at 105 $^\circ$ C.

Marking: Each capacitor shall be marked with the following information.

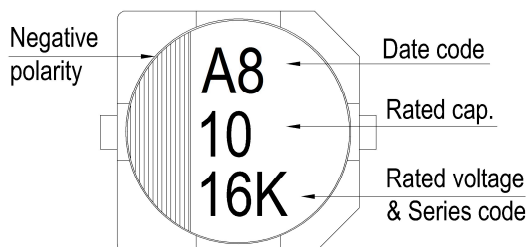

A 8 \rightarrow January, 2018
 \rightarrow The suffix of A. D.
 \rightarrow Month of manufacture

Month	1	2	3	4	5	6
Code	A	B	C	D	E	F
Month	7	8	9	10	11	12
Code	G	H	I	J	K	L

Marking color: Blue

* Please refer to "Precautions and Guidelines for Aluminum Electrolytic Capacitors" section in Lelon's catalog for further details.

Publication Date	May 21, 2018	Approval Signatures:	Approved	Checked	Designed
Revision Date					
Version No.	1		Please return one copy with your approval		