

5	6	7	8
REV.	DATE	ECN NO.	MODIFICATION
A	2009/08/29	/	NEW
			APPROVER
			Vicky

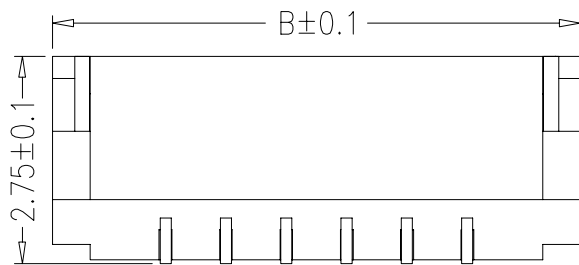
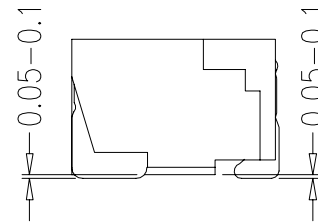
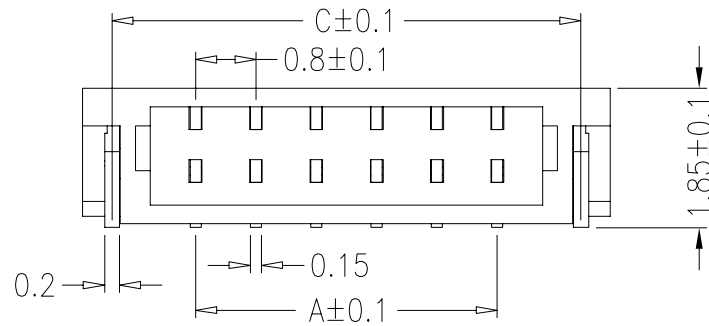

SPECIFICATIONS

Poles: 2~22

Voltage rating: DC,30V(50HZ)

Current rating: 0.2A,DC(AWG#36)

0.5A,DC(AWG#32)

Withstand voltage: 200V AC/minute

Operating Temperature: -25°C~+85°C

Insulation resistance: ≥100MΩ

Contact resistance: ≤20mΩ

MATERIAL

Terminal: Phosphor Bronze, Tin/Gold Plated

Housing: Thermoplastic, UL94V-0

极数	尺寸				备注
	A	B	C	D	
2	0.80	3.80	3.00	4.60	
3	1.60	4.60	3.80	5.40	
4	2.40	5.40	4.60	6.20	
5	3.20	6.20	5.40	7.00	
6	4.00	7.00	6.20	7.80	
7	4.80	7.80	7.00	8.60	
8	5.60	8.60	7.80	9.40	
9	6.40	9.40	8.60	10.20	
10	7.20	10.20	9.40	11.00	
11	8.00	11.00	10.20	11.80	
12	8.80	11.80	11.00	12.60	
13	9.60	12.60	11.80	13.40	
14	10.40	13.40	12.60	14.20	
15	11.20	14.20	13.40	15.00	
16	12.00	15.00	14.20	15.80	
17	12.80	15.80	15.00	16.60	
18	13.60	16.60	15.80	17.40	
19	14.40	17.40	16.60	18.20	
20	15.20	18.20	17.40	19.00	
21	16.00	19.00	18.20	19.80	
22	16.80	19.80	19.00	20.60	

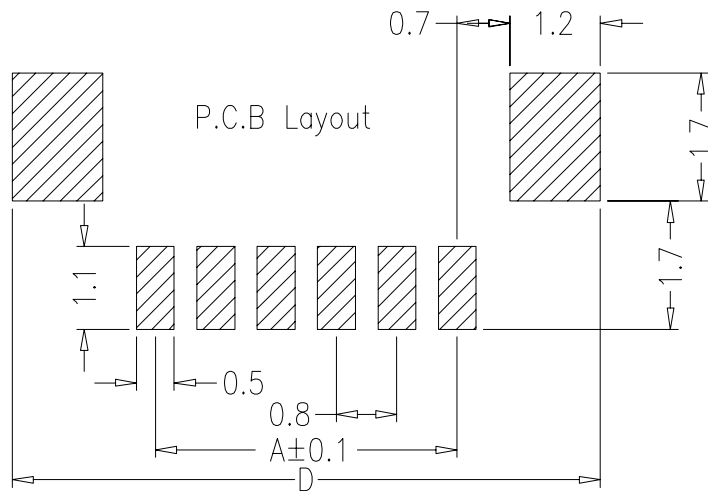

GENERAL TOLERANCE			UNITS	NAME:	WF	ATOM [®] 深圳市爱特姆科技有限公司 SHENZHEN ATOM TECHNOLOGY CO.,LTD.
SELECT	✓		mm	PART NO:	WF080**-01***	
NO.	1	2	3	MAT'L		DWG NO. ATOM-A04169
X.XXX		±0.05	±0.15	FINISH	APPD: Jason	 SCALE SHEET REV 1:1 1/1 A
X.XX		±0.05	±0.25	Q'TY	CHKD: Vicky	
X.X		±0.15	±0.50		DR: tom	
X.		±0.20	±0.38			
ANGLE	±2'					