

本公司智慧財產，未經同意不得複製
DAILYWELL copyright, may not be used
without permission from DAILYWELL

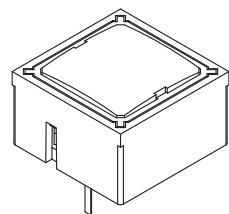

CAP Type "B"
Actuator

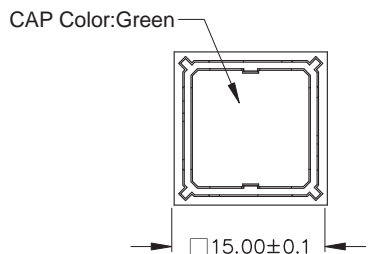

SCHMATIC

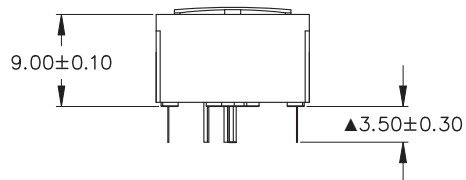

SPECIFICATIONS

RATING: 100mA max, 42 VAC/DC
MECHANICAL LIFE: 1,000,000 cycles
CONTACT RESISTANCE: 100 mΩ max.(initial)
INSULATION RESISTANCE: 1000 MΩ min.
DIELECTRIC STRENGTH: 1,000 VAC
FORCE: 3N±0.75N
TRAVEL: 0.6±0.2mm

MATERIALS

SWITCH HOUSING: PBT
ACTUATOR: ABS
Ⓐ CONTACT: Stainless
TERMINALS: Brass, Ag plated
TERMINAL SEAL: Epoxy
RoHS & Lead Free

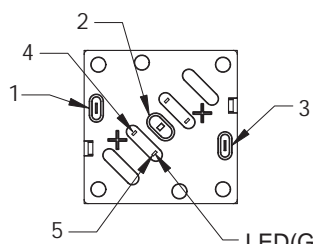

LED(Green)
※ Kindly take a reference
for LED spec

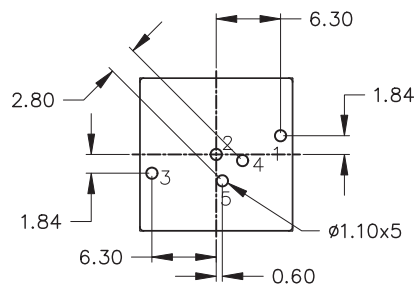

P.C. MOUNTING

德利威電子股份有限公司
DAILYWELL ELECTRONICS CO.,LTD.

符號	原尺寸	修改後尺寸	變更日期	SCALE (比例) : 1:1	TITLE 圖名	SIZE 圖紙	
1	Ⓐ	取消跳板電鍍	MAY-07-2019	Ⓢ Ⓜ TOLERANCE (公差) : 0.00mm±0.25mm 0.0mm±0.40mm ANGULAR: ±5° FILE NAME : KS0130	Short-travel keyswitches	A4	
2	Ⓑ				DWG NO. 圖號	UNIT 單位	
3	Ⓒ				REV. 版本	DATE 日期	SHEET 張數
4	Ⓓ				APPROVE 審核	CHECK 確認	DRAW 製圖
5	Ⓔ					IRENE	1 of 1