

## CTX50 UN-SEALED RECEPTACLE CRIMP TERMINAL

### 1.0 SCOPE

This specification details the crimping information and common practices of general crimps for the Molex CTX50 Un-Sealed Receptacle Terminal. Please refer to sales drawing SD-560023-002 for additional part information. The information in this document is for reference and benchmark purposes only. Customers are required to complete their own validation testing if tooling and/or wire is different than what is shown in this specification.

All measurements are in millimeters and Newton unless specified otherwise.

Terminals shown in this document are generic representations. They are not intended to be an image of any terminal listed in the scope.

### 2.0 PRODUCT DESCRIPTION

#### DEFINITION OF TERMS:

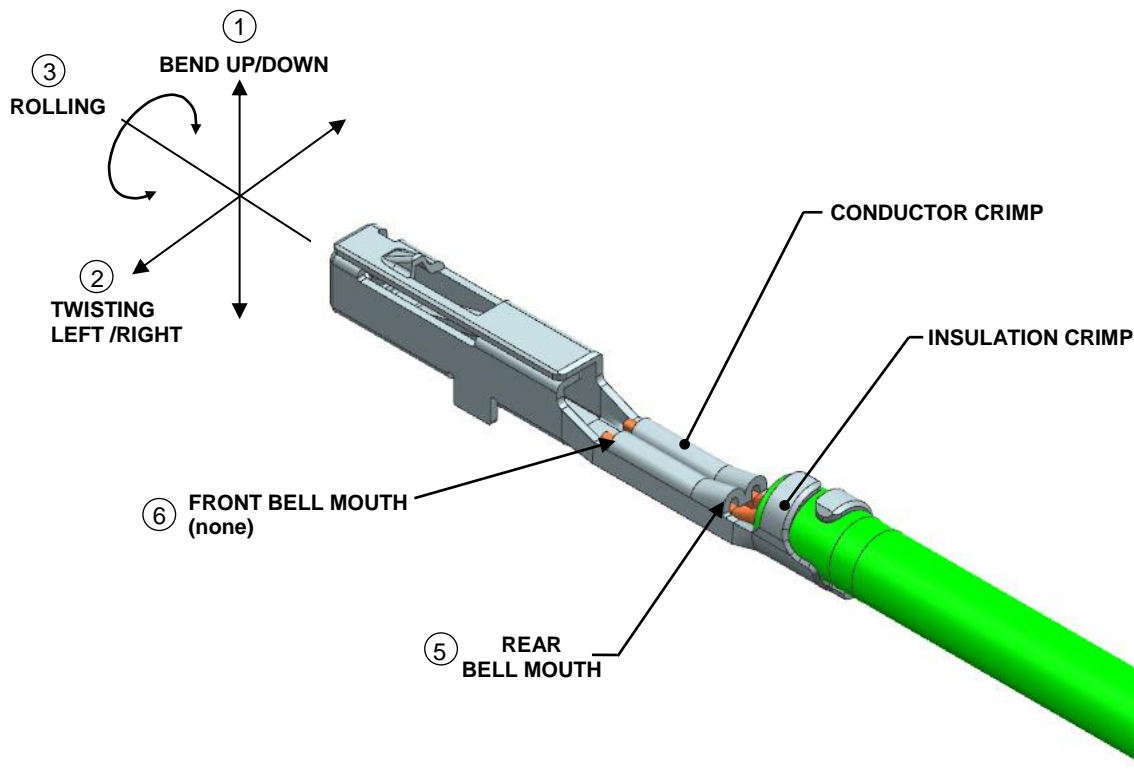

THIS DOCUMENT CONTAINS INFORMATION THAT IS PROPRIETARY TO MOLEX ELECTRONIC TECHNOLOGIES, LLC AND SHOULD NOT BE USED WITHOUT WRITTEN PERMISSION.

<b>REVISION:</b> <b>K</b>	<b>EC INFORMATION:</b> EC No: 633932 DATE: 2020/03/23	<b>TITLE:</b> <b>CTX50 UNSEALED RECEPTACLE TERMINAL APPLICATION SPEC</b>			<b>SHEET No.</b> <b>1 of 24</b>
<b>DOCUMENT NUMBER:</b> <b>AS-560023-001</b>	<b>DOC TYPE:</b> <b>PS</b>	<b>DOC PART:</b> <b>001</b>	<b>CREATED / REVISED BY:</b> <b>RGV</b>	<b>CHECKED BY:</b> <b>SMAHADIK</b>	<b>APPROVED BY:</b> <b>JCUATACERVAN</b>
<small>TEMPLATE FILENAME: APPLICATION_SPEC[SIZE_A4] (V.4).DOCX</small>					

DEFINITIONS OF TERMS (CONT.):

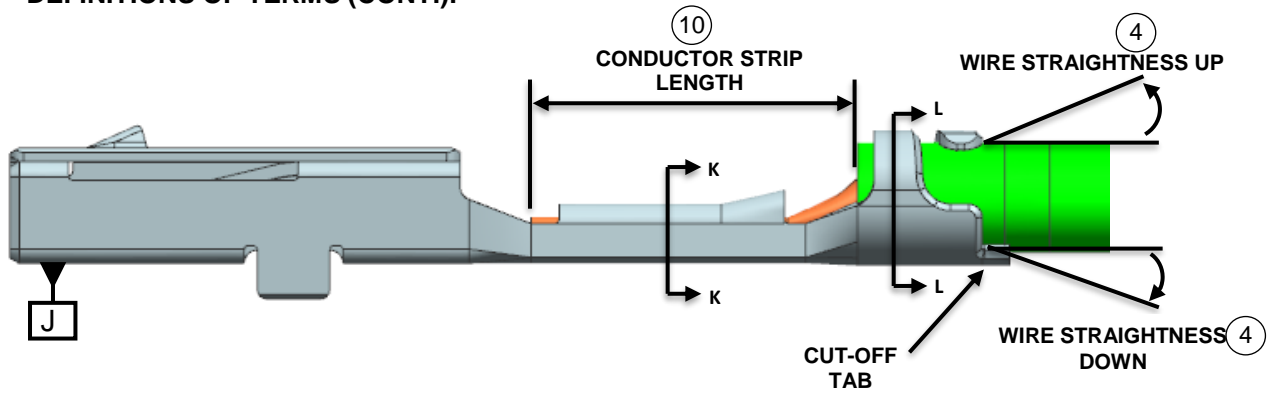

Figure 2

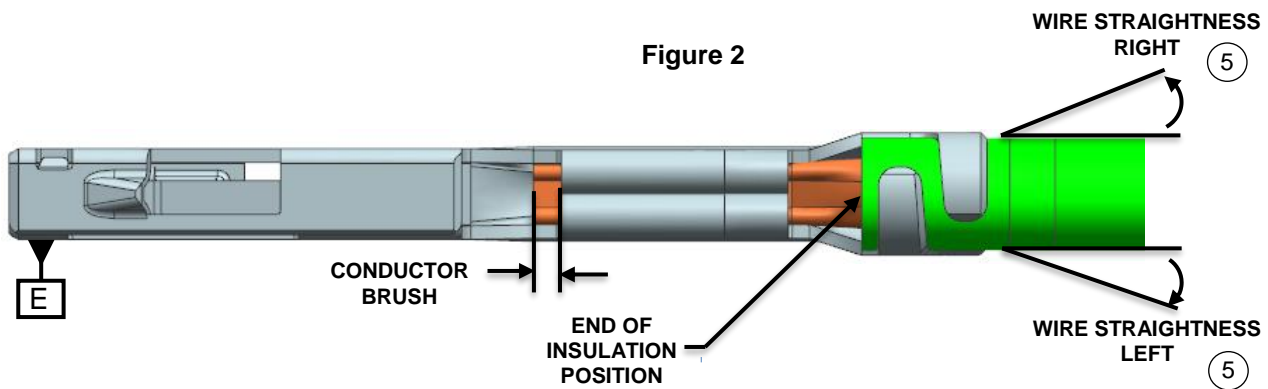

Figure 2

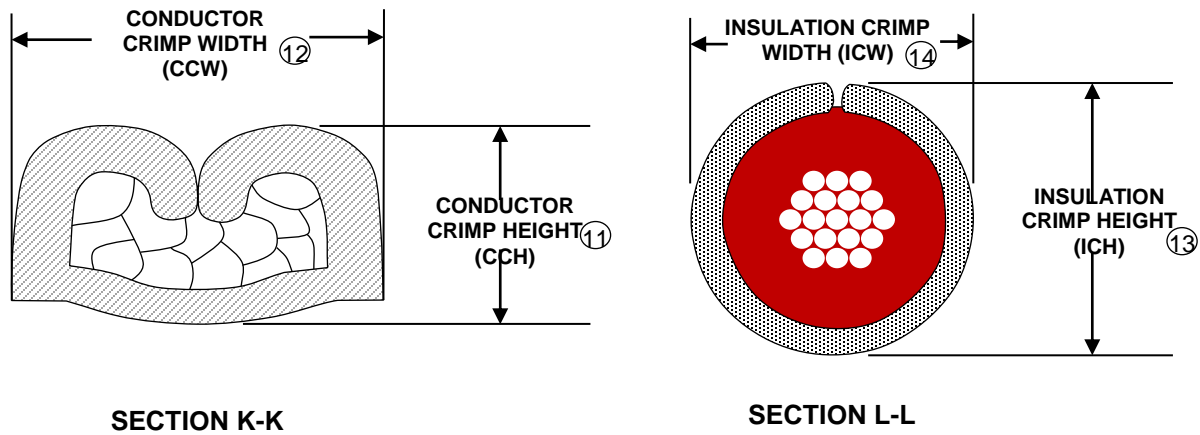

Figure 3

THIS DOCUMENT CONTAINS INFORMATION THAT IS PROPRIETARY TO MOLEX ELECTRONIC TECHNOLOGIES, LLC AND SHOULD NOT BE USED WITHOUT WRITTEN PERMISSION.

REVISION: <b>K</b>	EC INFORMATION: EC No: 633932 DATE: 2020/03/23	TITLE: <b>CTX50 UNSEALED RECEPTACLE TERMINAL APPLICATION SPEC</b>			SHEET No. <b>2 of 24</b>
DOCUMENT NUMBER: <b>AS-560023-001</b>	DOC TYPE: <b>PS</b>	DOC PART: <b>001</b>	CREATED / REVISED BY: <b>RGV</b>	CHECKED BY: <b>SMAHADIK</b>	APPROVED BY: <b>JCUATACERVAN</b>
TEMPLATE FILENAME: APPLICATION_SPEC[SIZE_A4] (V.4).DOCX					

## STRAIGHTNESS ①②③④

The crimping process may result in some bending between the conductor crimp and the terminal box. This bending must not exceed the limits shown in **Table 3**

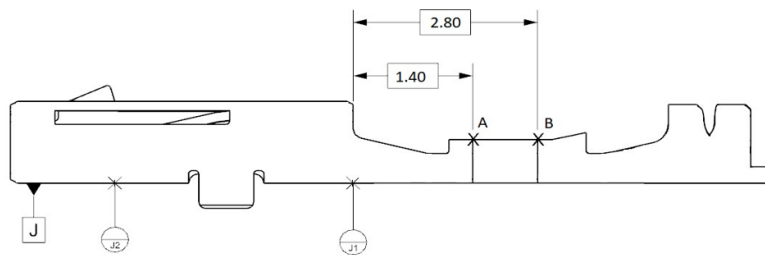

Figure 4

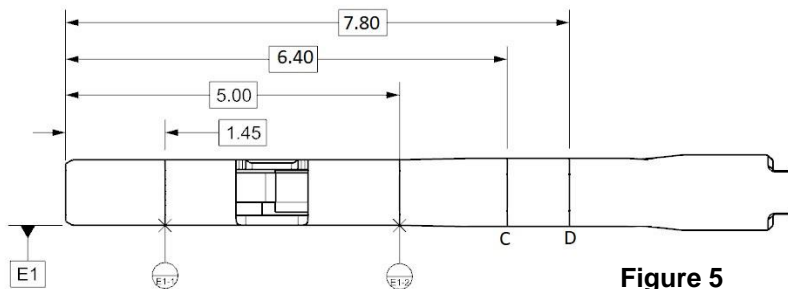
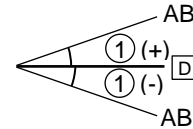
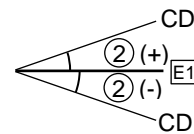

Figure 5



## BEND UP/DOWN

To measure bend up/down, establish datum J as shown in Figure 4. Then measure the angle of the line defined by points A and B with respect to the datum. Positive angles are defined as bend up and negative angles are defined as bend down.

## TWISTING ②

To measure twisting, establish datum E1 as shown in Figure 5. Then measure the angle of the line defined by points C and D with respect to the datum.

## Rolling ③

To measure rolling, cross section the part  $2.65 \pm 0.05$  mm behind datum F, then clamp the part in a vice as shown in Figure 6. Using a shadowgraph, focus the graph to see the bottom edge of terminal and establish line X. With line X established, refocus the graph to sectioned crimp edge. Measure the angle of the line defined by points E and F with respect to line X.

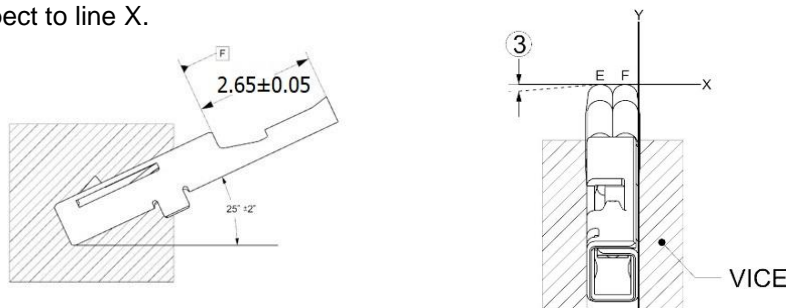
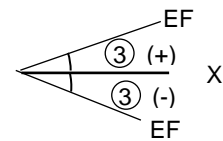

Figure 6



THIS DOCUMENT CONTAINS INFORMATION THAT IS PROPRIETARY TO MOLEX ELECTRONIC TECHNOLOGIES, LLC AND SHOULD NOT BE USED WITHOUT WRITTEN PERMISSION.

REVISION: <b>K</b>	EC INFORMATION: EC No: 633932 DATE: 2020/03/23	TITLE: <b>CTX50 UNSEALED RECEPTACLE TERMINAL APPLICATION SPEC</b>	SHEET No. <b>3 of 24</b>
DOCUMENT NUMBER: <b>AS-560023-001</b>	DOC TYPE: <b>PS</b>	DOC PART: <b>001</b>	CREATED / REVISED BY: <b>RGV</b>
		CHECKED BY: <b>SMAHADIK</b>	APPROVED BY: <b>JCUATACERVAN</b>

### BELLMOUTH (FLARE) ⑥a ⑥b ⑥c ⑦

The flare that is formed on the edge of the conductor crimp acts as a funnel for the wire strands. This funnel reduces the possibility that a sharp edge on the conductor crimp will cut or nick the wire strands. A rear bellmouth is required on the conductor crimp. CAUTION: Excessively large/small bellmouth may affect mechanical / electrical performance. See Table 3 for bellmouth specifications.

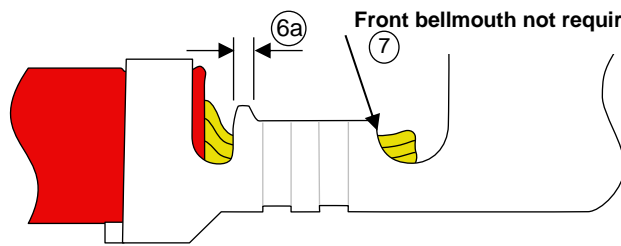

Figure 7a

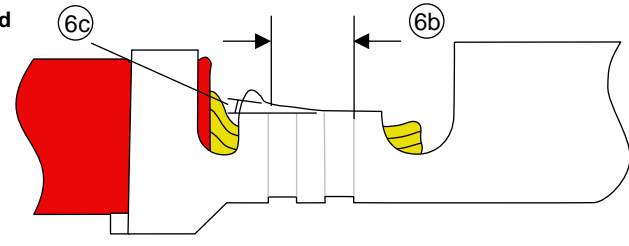

Figure 7b

560023-0444/0445 only

### CUT-OFF TAB ⑧a ⑧b

This is the material that protrudes outside the insulation crimp after the terminal is separated from the carrier strip. A cut-off tab that is too long may expose a terminal outside the housing; it may fail electrical spacing requirements. See Table 3 for cut-off tab length specifications.

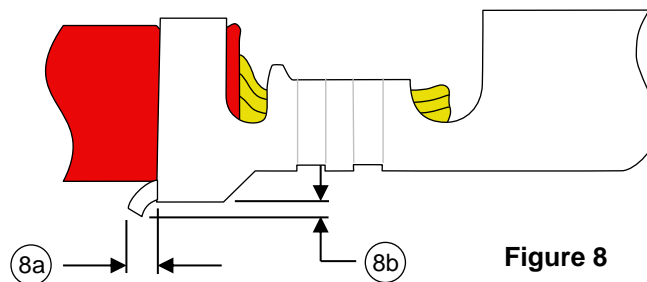

Figure 8

### CONDUCTOR BRUSH ⑨a ⑨b

The conductor brush is made up of the wire strands that extend past the conductor crimp into the transition area towards the terminal box. This helps ensure that mechanical compression occurs over the full length of the conductor crimp. The conductor brush should not extend past the transition area into the terminal box or above the conductor crimp/transition wall height (whichever is tallest). CAUTION: Excessive conductor brush extended above the transition/crimp area can cause terminal retention issues inside plastic cavity.

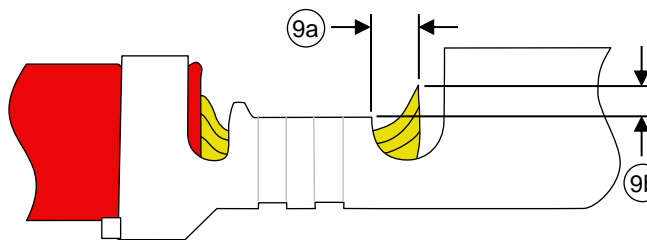

Figure 10

THIS DOCUMENT CONTAINS INFORMATION THAT IS PROPRIETARY TO MOLEX ELECTRONIC TECHNOLOGIES, LLC AND SHOULD NOT BE USED WITHOUT WRITTEN PERMISSION.

REVISION: <b>K</b>	EC INFORMATION: EC No: 633932 DATE: 2020/03/23	TITLE: <b>CTX50 UNSEALED RECEPTACLE TERMINAL APPLICATION SPEC</b>			SHEET No. <b>4 of 24</b>
DOCUMENT NUMBER: <b>AS-560023-001</b>	DOC TYPE: <b>PS</b>	DOC PART: <b>001</b>	CREATED / REVISED BY: <b>RGV</b>	CHECKED BY: <b>SMAHADIK</b>	APPROVED BY: <b>JCUATACERVAN</b>
TEMPLATE FILENAME: APPLICATION_SPEC[SIZE_A4] (V.4).DOCX					

## CONDUCTOR STRIP LENGTH ⑩

The strip length is determined by measuring the exposed conductor strands after the insulation is removed. The strip length determines the conductor brush length when the end-of-insulation position is centered in the transition area between conductor and insulation crimps. See Table 3 for the length requirement

**CAUTION:** Care must be taken to ensure that all conductor strands are equal in length (no diagonally cut strands). No scratched or missing strands are permitted. The insulation cut must be uniform (no diagonally cut insulation and no extrusions of insulation).

## CONDUCTOR CRIMP

This is the metallurgical compression of a terminal around the wire's conductor. This connection creates a common electrical path with low resistance and high current carrying capabilities.

## CONDUCTOR CRIMP HEIGHT/WIDTH ⑪ ⑫

The conductor crimp height is measured from the top surface of the formed crimp to the bottom most radial surface. The conductor crimp width is measured across the widest portion of the crimp. Do not include the extrusion points in these measurements. Measuring crimp height/width is a quick, non-destructive way to help ensure the correct metallurgical compression of a terminal around the wire's conductor and is an excellent attribute for process control. The crimp height/width specification is typically set as a balance between electrical and mechanical performance over the complete range of wire stranding and coatings, and terminal materials and plating. Although it is possible to optimize a crimp height/width to individual wire strands and terminal plating, one crimp height/width specification is normally created. See Table 2 for crimp height/width specifications.

## INSULATION CRIMP HEIGHT/WIDTH ⑬ ⑭

Insulation crimp heights/widths are specified in **Table 2**. CTX50 Un-Sealed Receptacle Terminals are designed to accommodate multiple wire sizes. Although within the terminal range, an insulation grip may not completely surround the wire, an acceptable insulation crimp will still be provided.

The insulation crimp should be visually evaluated to confirm it provides adequate compression on the wire. It should also be evaluated by sectioning through the center of the crimped insulation grip. The grip should compress the insulation but not pierce it or otherwise damage the integrity of the insulation. The grip should not contact the conductors under any circumstance. Mechanically, the insulation grip should withstand repeated flexing of the wire as shown in Figure 7 without pulling out of the grip. The wire is flexed 5 times each in two perpendicular planes in the following sequence: b to a, a to b, b to c, c to b, then repeat (**see Figure 7**).

Once the optimum setting for an insulation crimp height is determined, it is important to document it. The operator can then check it as part of the setup procedure.

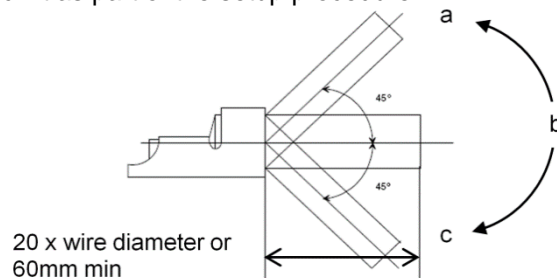

Figure 7

THIS DOCUMENT CONTAINS INFORMATION THAT IS PROPRIETARY TO MOLEX ELECTRONIC TECHNOLOGIES, LLC AND SHOULD NOT BE USED WITHOUT WRITTEN PERMISSION.

REVISION: <b>K</b>	EC INFORMATION: EC No: 633932 DATE: 2020/03/23	TITLE: <b>CTX50 UNSEALED RECEPTACLE TERMINAL APPLICATION SPEC</b>				SHEET No. <b>5 of 24</b>
DOCUMENT NUMBER: <b>AS-560023-001</b>	DOC TYPE: <b>PS</b>	DOC PART: <b>001</b>	CREATED / REVISED BY: <b>RGV</b>	CHECKED BY: <b>SMAHADIK</b>	APPROVED BY: <b>JCUATACERVAN</b>	
TEMPLATE FILENAME: APPLICATION_SPEC[SIZE_A4] (V.4).DOCX						

## CONDUCTOR ANVIL FLASH (EXTRUSIONS / BURR) (15a) (15b)

These are the small flares that form on the bottom of the conductor crimp resulting from the clearance between the punch and anvil tooling. If the anvil is worn or the terminal is over-crimped, excessive extrusion can result.

An uneven extrusion may also result if the punch and anvil are misaligned, if the feed is misadjusted or if there is insufficient or excessive terminal drag (see Figure 8 and Table 3).

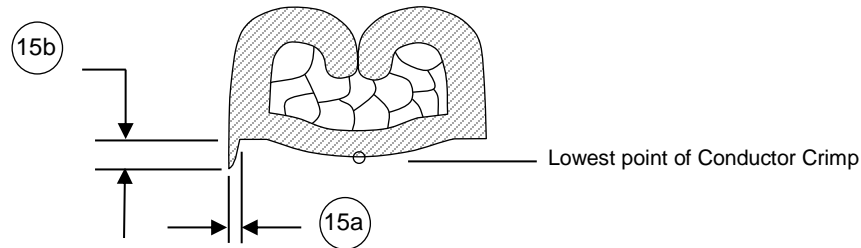

Figure 8

## INSULATION AND CONDUCTOR GRIP STEP (16) (17)

The insulation grip step is the designed offset between the conductor grip and the insulation grip which must be met by the crimp process (see Figure 9 and Table 3).

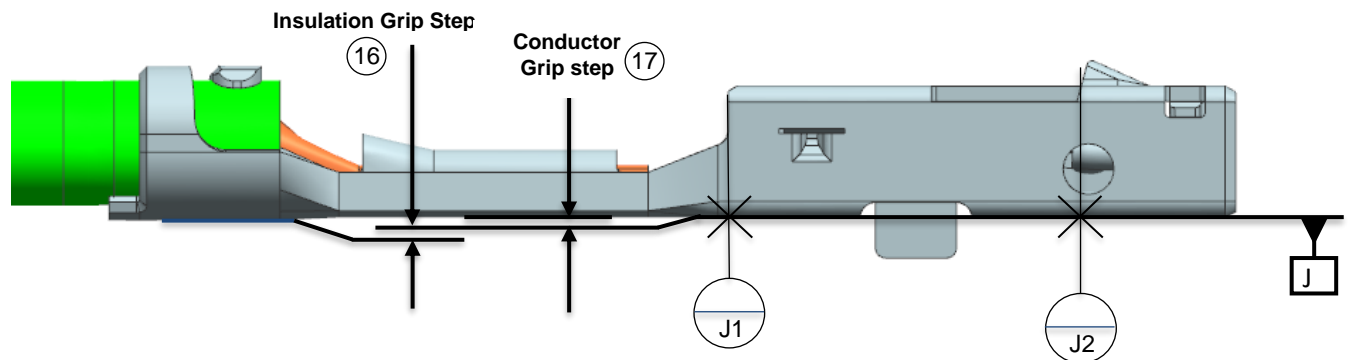

Figure 9

## END-OF-INSULATION POSITION

This is the location of the insulation in relation to the transition area between the conductor and insulation crimps. Equal amounts of the conductor strands and insulation needs to be visible in the transition area. The end-of insulation position ensures that the insulation is crimped along the full length of the insulation crimp and that no insulation gets crimped under the conductor crimp. The end-of-insulation position is set by the wire stop and strip length for bench applications. For automatic wire processing applications, the end-of-insulation position is set by the in/out press adjustment (see Figure 2).

THIS DOCUMENT CONTAINS INFORMATION THAT IS PROPRIETARY TO MOLEX ELECTRONIC TECHNOLOGIES, LLC AND SHOULD NOT BE USED WITHOUT WRITTEN PERMISSION.

REVISION: <b>K</b>	EC INFORMATION: EC No: 633932 DATE: 2020/03/23	TITLE: <b>CTX50 UNSEALED RECEPTACLE TERMINAL APPLICATION SPEC</b>			SHEET No. <b>6 of 24</b>
DOCUMENT NUMBER: <b>AS-560023-001</b>	DOC TYPE: <b>PS</b>	DOC PART: <b>001</b>	CREATED / REVISED BY: <b>RGV</b>	CHECKED BY: <b>SMAHADIK</b>	APPROVED BY: <b>JCUATACERVAN</b>
<small>TEMPLATE FILENAME: APPLICATION_SPEC[SIZE_A4] (V.4).DOCX</small>					

### WING DISSYMMETRY <sup>(18)</sup>

Wing dissymmetry is the crimped offset between the ends of core wings (see Figure 10 and Table 3).

### SPACE BETWEEN WING TIPS AND CRIMP BOTTOM <sup>(19)</sup>

The space between the crimp wing tips and the bottom of the crimp is designed to assure no contact between wing tips and the crimp bottom. Shortest distance is measured. (See Figure 10 and Table 3).

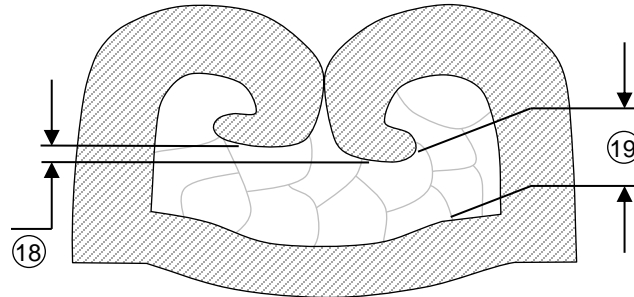
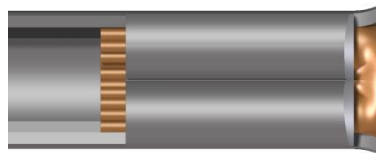

Figure 10

### CRIMP BULGE <sup>(20a)</sup> <sup>(20b)</sup>

Caution needs to be taken with the crimp tooling to prevent a bulge in the transition area during crimping. The transition should generally flow smoothly from the conductor crimp to the terminal box. Any bulge must not exceed the width shown in Table 3. See Figure 11 for an example of crimp bulge.



Good Crimp (No Bulge)

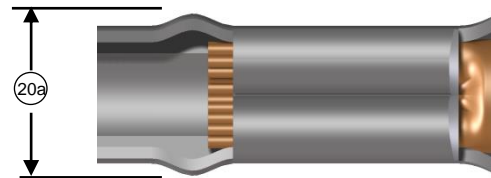

Bad Crimp (Bulge)

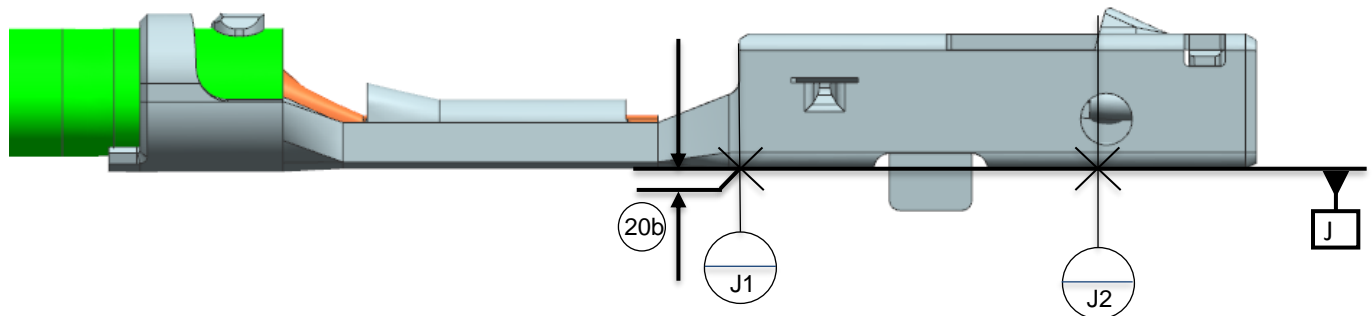

Figure 11

THIS DOCUMENT CONTAINS INFORMATION THAT IS PROPRIETARY TO MOLEX ELECTRONIC TECHNOLOGIES, LLC AND SHOULD NOT BE USED WITHOUT WRITTEN PERMISSION.

REVISION: <b>K</b>	EC INFORMATION: EC No: 633932 DATE: 2020/03/23	TITLE: <b>CTX50 UNSEALED RECEPTACLE TERMINAL APPLICATION SPEC</b>			SHEET No. <b>7 of 24</b>
DOCUMENT NUMBER: <b>AS-560023-001</b>	DOC TYPE: <b>PS</b>	DOC PART: <b>001</b>	CREATED / REVISED BY: <b>RGV</b>	CHECKED BY: <b>SMAHADIK</b>	APPROVED BY: <b>JCUATACERVAN</b>
TEMPLATE FILENAME: APPLICATION_SPEC[SIZE_A4] (V.4).DOCX					

### BOX DEFORMATION

Care must be taken to ensure that the terminal box is not deformed during crimping and handling. Any deformation of the terminal box must not exceed the tolerances specified in sales drawing

### WIRE CONDITION AFTER CRIMP

The wire, after crimping, should not have any scratches, grooves or dents. At a minimum, check the condition of the wire on a sample length of 26mm as shown in Figure 12.

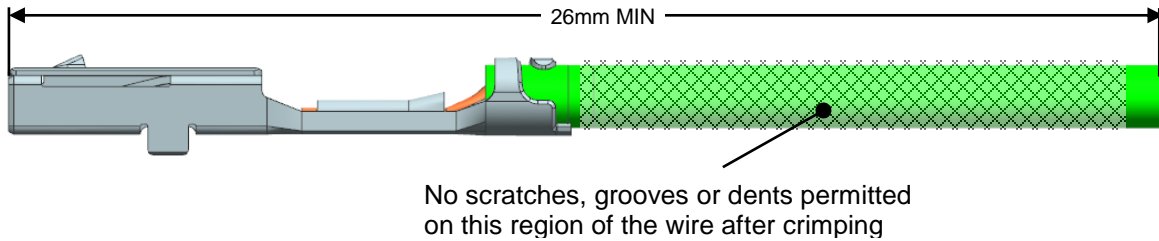

Figure 12

## 3.0 PRODUCT SPECIFICATIONS

Table 1

Terminal Family	Gender	Sealing	Part Number	Plating	Special Characteristics	Grip Code	Wire Size	Insulation Diameter Range (mm)
CTX50	Receptacle	Unsealed	560023-0444/0445	Sn	Standard Performance Sn	S	0.13mm <sup>2</sup> / 26AWG	0.75 - 1.05
			560023-0544/0545	Au	Standard Performance Au		0.13mm <sup>2</sup> / 26AWG	0.75 - 1.05
			560023-0421/0423	Sn	Standard Performance Sn	M	0.22mm <sup>2</sup> / 24AWG	0.95 - 1.05
			560023-0448/0450	Sn	Standard Performance Sn	L	0.35mm <sup>2</sup> / 22AWG	1.10 - 1.40
			560023-0548/0550	Au	Standard Performance Au		0.35mm <sup>2</sup> / 22AWG	1.10 - 1.40

THIS DOCUMENT CONTAINS INFORMATION THAT IS PROPRIETARY TO MOLEX ELECTRONIC TECHNOLOGIES, LLC AND SHOULD NOT BE USED WITHOUT WRITTEN PERMISSION.

<b>REVISION:</b> <b>K</b>	<b>EC INFORMATION:</b> EC No: 633932 DATE: 2020/03/23	<b>TITLE:</b> <b>CTX50 UNSEALED RECEPTACLE TERMINAL APPLICATION SPEC</b>				<b>SHEET No.</b> <b>8 of 24</b>
<b>DOCUMENT NUMBER:</b> <b>AS-560023-001</b>	<b>DOC TYPE:</b> <b>PS</b>	<b>DOC PART:</b> <b>001</b>	<b>CREATED / REVISED BY:</b> <b>RGV</b>	<b>CHECKED BY:</b> <b>SMAHADIK</b>	<b>APPROVED BY:</b> <b>JCUATACERVAN</b>	
<small>TEMPLATE FILENAME: APPLICATION_SPEC[SIZE_A4] (V.4).DOCX</small>						





# APPLICATION SPECIFICATION

Table 2

Molex Product Attribute			Validated Wire				Conductor Crimp		Insulation Crimp		Pull Force Minimum (N)
Grip Size	Left Payoff 'D-Wind' (Default)	Right Payoff 'B-Wind'	Size	Type	No. of Strands	Insulation Max OD (mm)	CCH (±0.03mm)	CCW (±0.03mm)	ICH (±0.05mm)	ICW (±0.05mm)	
S	560023-0444	560023-0445	0.13mm <sup>2</sup>	FLCUSN03RY <sup>1,a,b,c,d</sup>	7	1.10	0.53	0.83	1.20	1.10	50
	560023-0544	560023-0545	0.13mm <sup>2</sup>	FLCUSN03RY <sup>2,a,b,c,d</sup>	7	1.10	0.56				40
M	560023-0421	560023-0423	0.22mm <sup>2</sup>	CHFUS <sup>3,d,e</sup>	7	1.05	0.69	1.04	1.25	1.15	40
	560023-0421	560023-0423	24AWG	UL1332 <sup>2,f</sup>	19	1.35	0.69				
L	560023-0448	560023-0450	0.35mm <sup>2</sup>	FLR2X A3ZH <sup>1,a,d,e,g</sup>	7	1.40	0.67±0.02	1.04	1.53	1.38	50
			0.35mm <sup>2</sup>	FLR13Y-A <sup>4,c,h</sup>	7	1.40	0.67±0.02				
			0.35mm <sup>2</sup>	A3Z <sup>5,d,g,i</sup>	7	1.35	0.61±0.02				
			0.35mm <sup>2</sup>	*FTP: 00949 10 00766 <sup>6,d,g,L</sup>	7	1.35	0.67±0.02				
			0.35mm <sup>2</sup>	FHLR9Y <sup>1,m</sup>	7	1.30	0.67±0.02				
			22AWG	UL10086 <sup>2,e,j,k</sup>	19	1.40	0.65±0.02				
			22AWG	UL10316 <sup>2</sup>	19	1.30	0.71±0.02				
	22AWG	UL10588 <sup>2</sup>	19	1.27	0.65±0.02						
	560023-0548	560023-0550	0.35mm <sup>2</sup>	FLR2X A3ZH <sup>2,a,d,e,g</sup>	7	1.40	0.67±0.02				
			22AWG	UL10086 <sup>2,e,j,k</sup>	19	1.40	0.65±0.02				
22AWG			UL10316 <sup>2</sup>	19	1.30	0.71±0.02					
22AWG			UL10588 <sup>2</sup>	19	1.27	0.65±0.02					

\* 0.35mm<sup>2</sup> FTP: 00949\_10\_00766 wire is equivalent to 0.35mm<sup>2</sup> T3ZHID wire

The above specifications are guidelines for an optimum crimp. Crimp heights/widths are applicable for punch/anvil tooling shown in Figures 15-25.

Pull force should be measured with no influence from the insulation crimp.

Customers are required to complete their own validation testing if tooling and/or wire is different than what is shown in this specification.

Terminal crimps are validated to the following specifications:

- <sup>1</sup>USCAR-21, Revision-3, Nov-2014; Sections 4.3, 4.4 & 4.5.2
- <sup>2</sup>USCAR-21, Revision-3, Nov-2014; Sections 4.3 & 4.5.2
- <sup>3</sup>PSA STE 96 34115099 Rev. 2007-2008; Sections 5.6.4, 5.6.5.2, 5.6.5.4, 5.6.6.1, 5.6.6.2, 5.6.7.1
- <sup>4</sup>AK LV214, Mar 2010; Sections PG0 & PG10. VW 60330 Section 4.3.4 & VW 75174-2 Section 3.4
- <sup>5</sup>RSA 36-05-019 Rev J
- <sup>6</sup>PSA STE 96 34115099 Rev. 2007-2008; Sections 4.3.5.3, 5.6.4, 5.6.5.1, 5.6.5.2, 5.6.5.4, 5.6.6.2, 5.6.7.1
- <sup>7</sup>RNDS-B-00029 v2.0 24012NDS07 36-05-019-L; Sections 13.1, 13.2, 13.3, 13.4, 13.5

Wires are in accordance with following specifications:

- <sup>a</sup>GMW15626
- <sup>b</sup>Ford ES-BR-1A348-AA
- <sup>c</sup>LV 112-4
- <sup>d</sup>ISO 6722
- <sup>e</sup>RoHS
- <sup>f</sup>UL758, UL1581
- <sup>g</sup>DIN EN13602
- <sup>h</sup>VW60330
- <sup>i</sup>RSA 36-05-009/L
- <sup>j</sup>REACH
- <sup>k</sup>FDA
- <sup>l</sup>B25 11 10
- <sup>m</sup>LV112-1, LV 216-1

THIS DOCUMENT CONTAINS INFORMATION THAT IS PROPRIETARY TO MOLEX ELECTRONIC TECHNOLOGIES, LLC AND SHOULD NOT BE USED WITHOUT WRITTEN PERMISSION.

REVISION: <b>K</b>	EC INFORMATION: EC No: <b>633932</b>	TITLE: <b>CTX50 UNSEALED RECEPTACLE TERMINAL APPLICATION SPEC</b>			SHEET No. <b>9 of 24</b>
	DATE: <b>2020/03/23</b>	DOCUMENT NUMBER: <b>AS-560023-001</b>	DOC TYPE: <b>PS</b>	DOC PART: <b>001</b>	CREATED / REVISED BY: <b>RGV</b>
				CHECKED BY: <b>SMAHADIK</b>	APPROVED BY: <b>JCUATACERVAN</b>
TEMPLATE FILENAME: APPLICATION_SPEC[SIZE_A4] (V.4).DOCX					



# APPLICATION SPECIFICATION

Table 3

Specifications

Balloon #	Feature	Requirement	
1	Bend Up/Down	1° MAX	
2	Twisting Left/Right	2° MAX	
3	Rolling	N/A	
4	Wire Straightness Up/Down from datum J	3° MAX	
5	Wire Straightness Left/Right from datum E	3° MAX	
6a	Rear Bell Mouth	Grip Code S	0.30 MAX
		Grip Code M	0.50 ± 0.10
		Grip Code L	0.70 ± 0.10
		Grip Code XL	0.55 ± 0.10
6b	Conductor Crimp Angle Horizontal Length	Grip Code S	1.50 ± 0.50
6c	Conductor Crimp Angle	Grip Code S	7.5° ± 2.5°
7	Front Bell Mouth	None	
8a	Cut-Off Tab	0.30 MAX	
8b		No burrs	
9a	Conductor Brush	0.55 MAX	
9b		Not to extend above conductor crimp/ transition height	
10	Conductor Strip Length	0.13mm <sup>2</sup> wire	3.6 for reference
		0.22mm <sup>2</sup> wire	2.9 for reference
		0.35mm <sup>2</sup> wire	3.1 for reference
		0.50mm <sup>2</sup> wire	3.1 for reference
11	Conductor Crimp Height	See Table 2	
12	Conductor Crimp Width	See Table 2	
13	Insulation Crimp Height	See Table 2	
14	Insulation Crimp Width	See Table 2	
15a	Conductor Anvil Flash	0.10 MAX	
15b		0.10 MAX	
16	Insulation Grip Step From J1-J2 (see Figure 9)	Grip Codes S and M	0.00 ± 0.05
		Grip Code L and XL	0.03 ± 0.05
17	Conductor Grip Step From J1-J2 (see Figure 9)	0.00 ± 0.05	
18	Wing Dissymmetry	0.20 MAX	
19	Space Between Wing Tips and Crimp Bottom	Wire ≤ 0.22mm <sup>2</sup>	No contact
		Wire ≥ 0.35mm <sup>2</sup>	0.10 MIN
20a	Crimp Bulge	Grip Codes S, M, L and XL	1.07 MAX
20b		Grip Code S	0.10 MAX

THIS DOCUMENT CONTAINS INFORMATION THAT IS PROPRIETARY TO MOLEX ELECTRONIC TECHNOLOGIES, LLC AND SHOULD NOT BE USED WITHOUT WRITTEN PERMISSION.

<u>REVISION:</u>  <b>K</b>	<u>EC INFORMATION:</u> EC No: 633932  DATE: 2020/03/23	<u>TITLE:</u> <b>CTX50 UNSEALED RECEPTACLE TERMINAL APPLICATION SPEC</b>			<u>SHEET No.</u>  <b>10 of 24</b>
	<u>DOCUMENT NUMBER:</u>  <b>AS-560023-001</b>	<u>DOC TYPE:</u> <b>PS</b>	<u>DOC PART:</u> <b>001</b>	<u>CREATED / REVISED BY:</u>  <b>RGV</b>	<u>CHECKED BY:</u>  <b>SMAHADIK</b>
<small>TEMPLATE FILENAME: APPLICATION_SPEC[SIZE_A4] (V.4).DOCX</small>					

## 4.0 REFERENCE DOCUMENTS

Reference documentation for general practices is located on the website per the below links:

1. Molex Quality Crimping Handbook [http://www.molex.com/images/products/apptool/qual\\_crimp.pdf](http://www.molex.com/images/products/apptool/qual_crimp.pdf)
2. Molex-Recognizing Good Crimps <http://www.molex.com>, search for Application Tooling

## 5.0 PROCEDURE

### 5.1 GENERAL MEASUREMENT AND EVALUATION REQUIREMENTS

#### Crimp Height Measurement (Anvil Flash Evaluation)

1. Complete tool set-up procedure.
2. Crimp a minimum of 5 samples.
3. Place the flat blade of the crimp micrometer across the center of the dual radii of the conductor crimp. Do not take the measurement near the conductor bell mouth (see Figure 13).
4. Rotate the micrometer dial until the point contacts the bottom most radial surface. If using a caliper, be certain not to measure the conductor anvil flash (extrusions) of the crimp (see Figure 14).

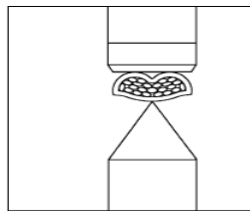

Figure 13

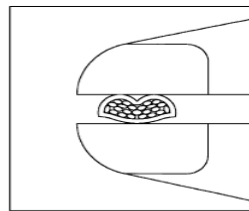
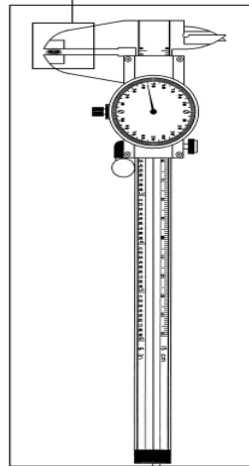
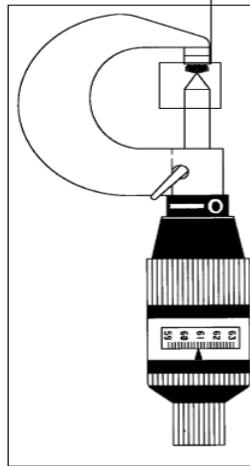

Figure 14



## 6.0 CRIMP TOOLING GEOMETRY

The crimp tooling information shown below defines the tooling used by Molex to perform validation testing to establish recommended crimp height and widths. The user is responsible for validating crimp performance based on tooling, equipment and wire that is being used.

*THIS DOCUMENT CONTAINS INFORMATION THAT IS PROPRIETARY TO MOLEX ELECTRONIC TECHNOLOGIES, LLC AND SHOULD NOT BE USED WITHOUT WRITTEN PERMISSION.*

REVISION: <b>K</b>	EC INFORMATION: EC No: 633932 DATE: 2020/03/23	TITLE: <b>CTX50 UNSEALED RECEPTACLE TERMINAL APPLICATION SPEC</b>			SHEET No. <b>11 of 24</b>
DOCUMENT NUMBER: <b>AS-560023-001</b>	DOC TYPE: <b>PS</b>	DOC PART: <b>001</b>	CREATED / REVISED BY: <b>RGV</b>	CHECKED BY: <b>SMAHADIK</b>	APPROVED BY: <b>JCUATACERVAN</b>
<small>TEMPLATE FILENAME: APPLICATION_SPEC[SIZE_A4] (V.4).DOCX</small>					

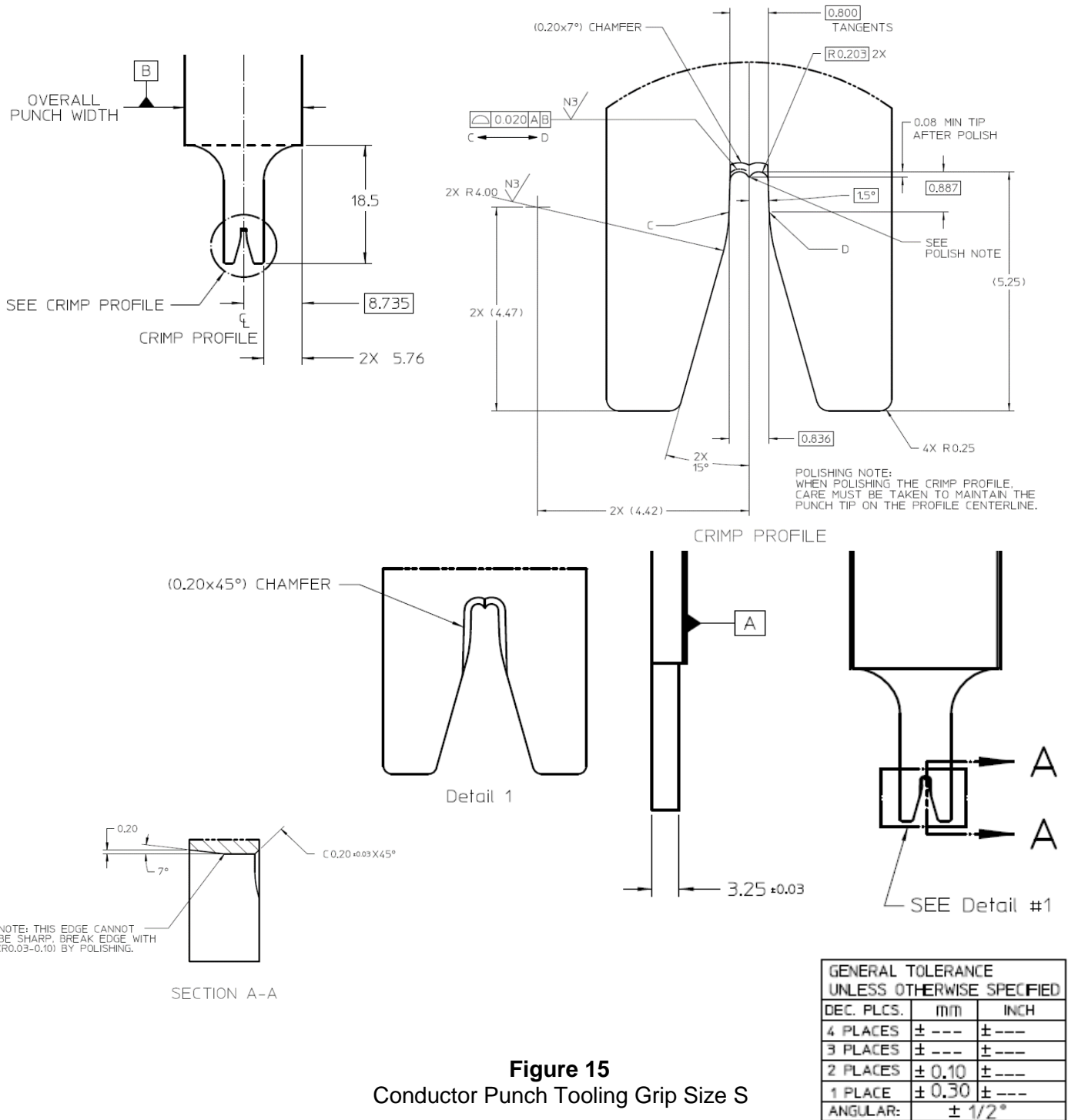

**Figure 15**  
Conductor Punch Tooling Grip Size S

THIS DOCUMENT CONTAINS INFORMATION THAT IS PROPRIETARY TO MOLEX ELECTRONIC TECHNOLOGIES, LLC AND SHOULD NOT BE USED WITHOUT WRITTEN PERMISSION.

<b>REVISION:</b>  <b>K</b>	<b>EC INFORMATION:</b> EC No: 633932 DATE: 2020/03/23	<b>TITLE:</b> <b>CTX50 UNSEALED RECEPTACLE TERMINAL APPLICATION SPEC</b>			<b>SHEET No.</b>  <b>12 of 24</b>
	<b>DOCUMENT NUMBER:</b> <b>AS-560023-001</b>	<b>DOC TYPE:</b> <b>PS</b>	<b>DOC PART:</b> <b>001</b>	<b>CREATED / REVISED BY:</b> <b>RGV</b>	<b>CHECKED BY:</b> <b>SMAHADIK</b>

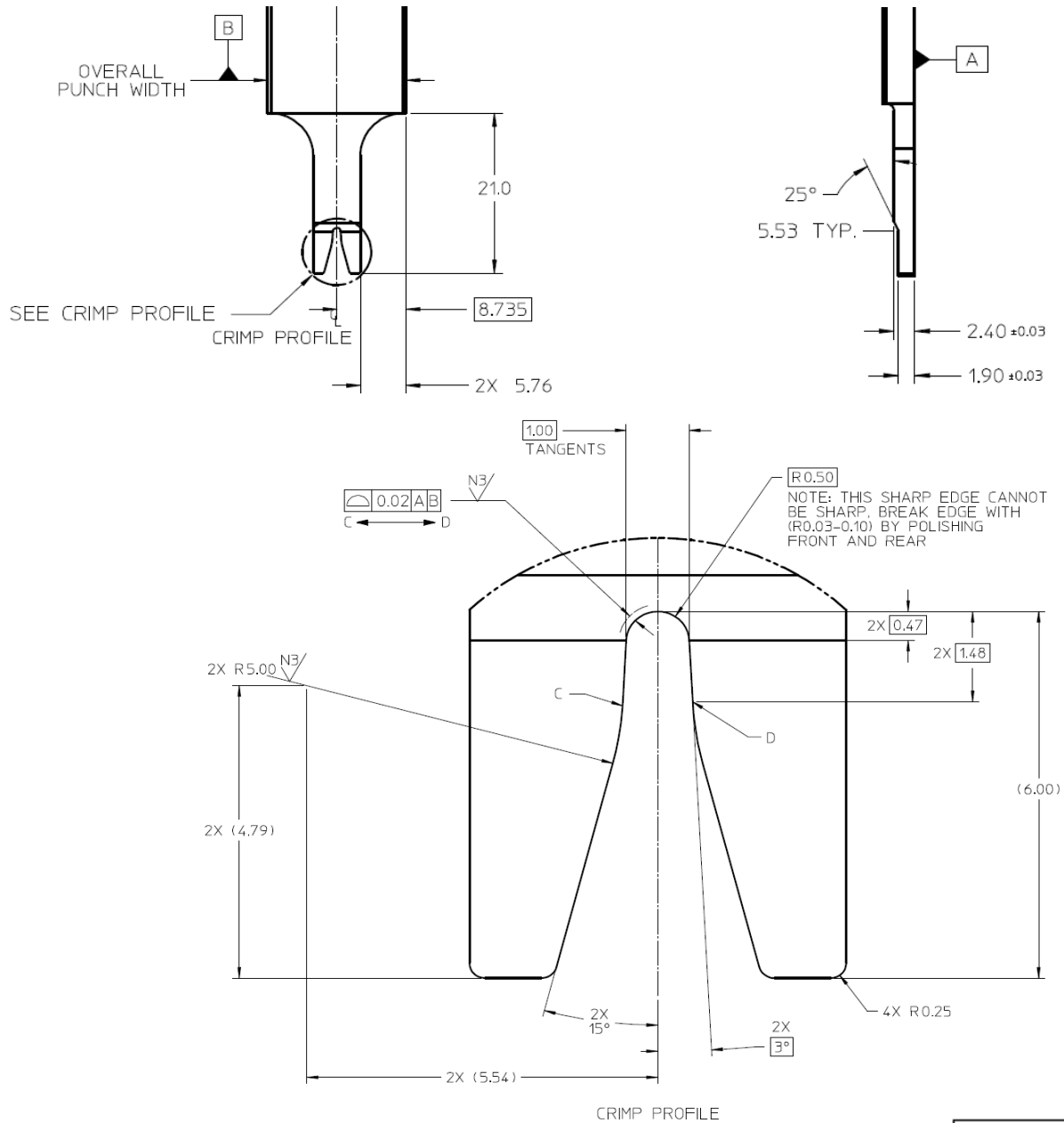
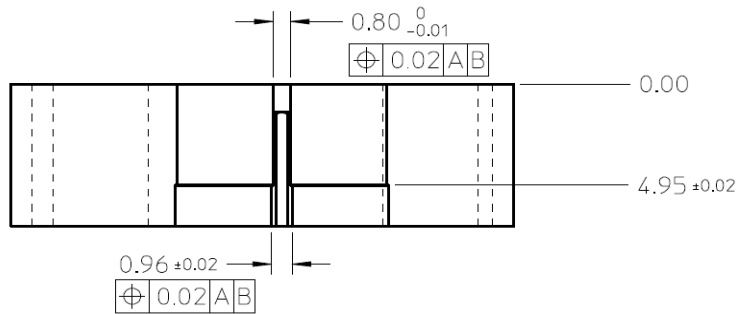

**Figure 16**  
Insulator Punch Tooling Grip Size S

GENERAL TOLERANCE UNLESS OTHERWISE SPECIFIED		
DEC. PLCS.	mm	INCH
4 PLACES	± ---	± ---
3 PLACES	± ---	± ---
2 PLACES	± 0.10	± ---
1 PLACE	± 0.30	± ---
ANGULAR:	± 1/2°	

THIS DOCUMENT CONTAINS INFORMATION THAT IS PROPRIETARY TO MOLEX ELECTRONIC TECHNOLOGIES, LLC AND SHOULD NOT BE USED WITHOUT WRITTEN PERMISSION.

REVISION: <b>K</b>	EC INFORMATION: EC No: 633932 DATE: 2020/03/23	TITLE: <b>CTX50 UNSEALED RECEPTACLE TERMINAL APPLICATION SPEC</b>	SHEET No. <b>13 of 24</b>
DOCUMENT NUMBER: <b>AS-560023-001</b>	DOC TYPE: <b>PS</b>	DOC PART: <b>001</b>	CREATED / REVISED BY: <b>RGV</b>
		CHECKED BY: <b>SMAHADIK</b>	APPROVED BY: <b>JCUATACERVAN</b>
TEMPLATE FILENAME: APPLICATION_SPEC[SIZE_A4] (V.4).DOCX			



**NOTE:**  
 CONDUCTOR ANVIL SURFACE FINISH.  
 EDM FINISH ACCEPTABLE 4.5 - 2.3 μm.  
 NO POLISHING OR GRINDING EDM SURFACES.  
 ACCEPTABLE FINISH CAN BE DETERMINED VISUALLY BY  
 USING AN EDM SURFACE FINISH COMPARATOR SCALE.

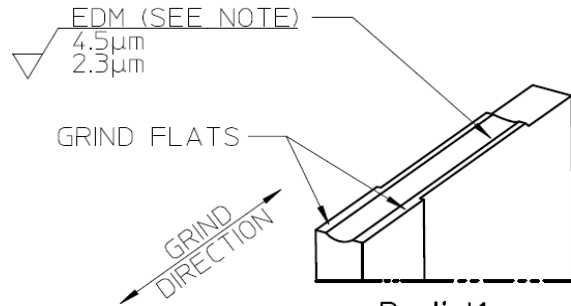

Partial 1  
 SCALE 10:1

**NOTE:**  
 ANVIL RADIUS CREATED BY EDM  
 (ELECTRICAL DISCHARGE MACHING)

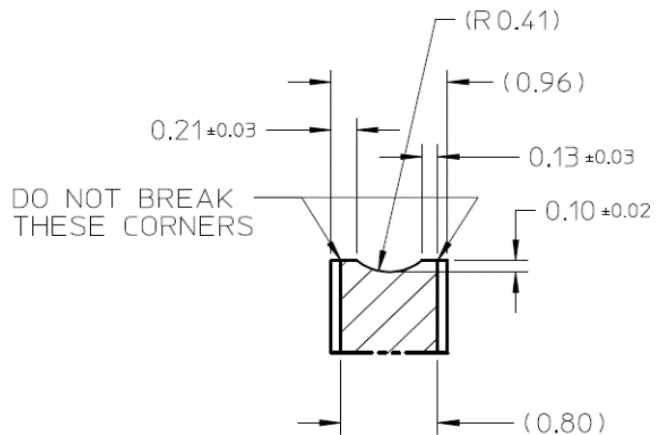
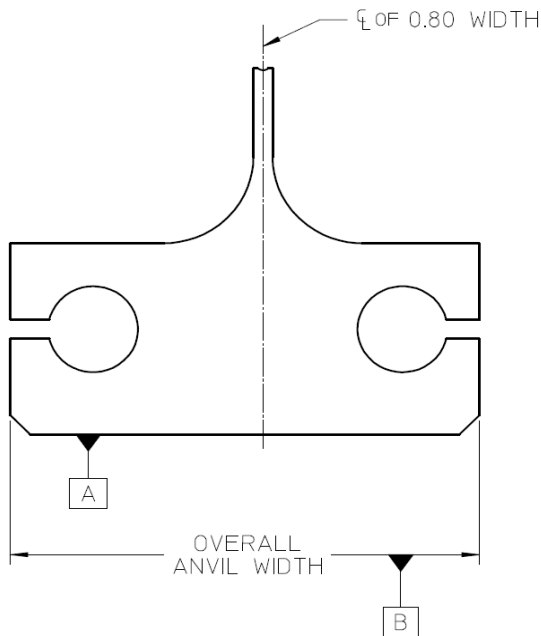

SECTION A-A

GENERAL TOLERANCE UNLESS OTHERWISE SPECIFIED		
DEC. PLCS.	mm	INCH
4 PLACES	± ---	± ---
3 PLACES	± ---	± ---
2 PLACES	± 0.10	± ---
1 PLACE	± 0.30	± ---
ANGULAR:	± 1/2°	

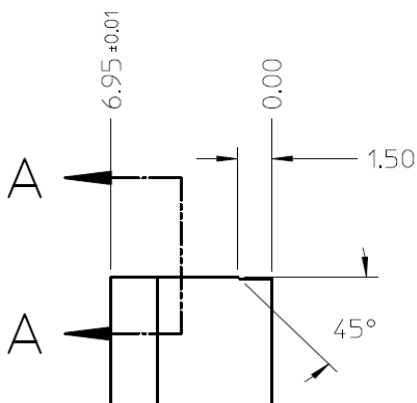

**Figure 17**  
 Combination Anvil Tooling Grip Size S

THIS DOCUMENT CONTAINS INFORMATION THAT IS PROPRIETARY TO MOLEX ELECTRONIC TECHNOLOGIES, LLC AND SHOULD NOT BE USED WITHOUT WRITTEN PERMISSION.

REVISION: <b>K</b>	EC INFORMATION: EC No: 633932	TITLE: <b>CTX50 UNSEALED RECEPTACLE TERMINAL APPLICATION SPEC</b>				SHEET No. <b>14 of 24</b>
	DATE: 2020/03/23					
DOCUMENT NUMBER: <b>AS-560023-001</b>	DOC TYPE: <b>PS</b>	DOC PART: <b>001</b>	CREATED / REVISED BY: <b>RGV</b>	CHECKED BY: <b>SMAHADIK</b>	APPROVED BY: <b>JCUATACERVAN</b>	
TEMPLATE FILENAME: APPLICATION_SPEC[SIZE_A4] (V.4).DOCX						

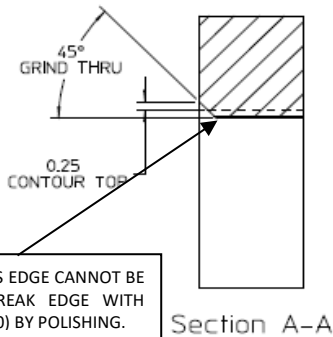
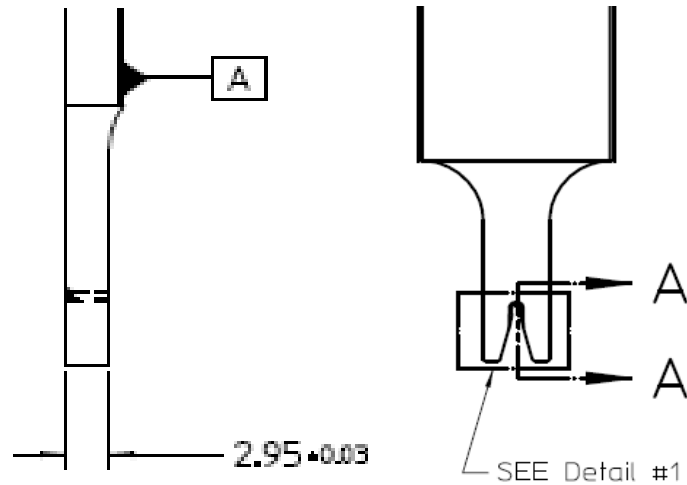
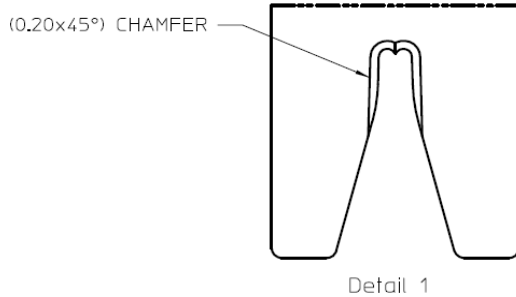
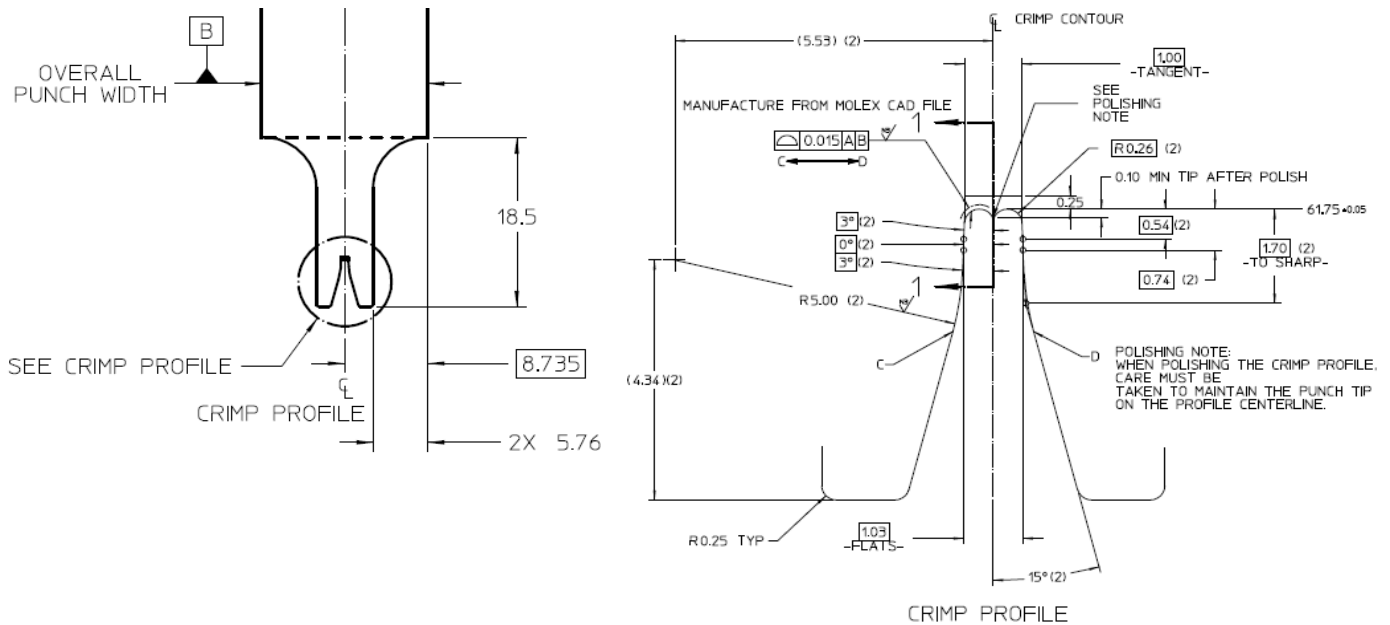

NOTE: THIS EDGE CANNOT BE SHARP. BREAK EDGE WITH (R0.03-1.10) BY POLISHING.

GENERAL TOLERANCE UNLESS OTHERWISE SPECIFIED		
DEC. PLCS.	MM	INCH
4 PLACES	± ---	± ---
3 PLACES	± ---	± ---
2 PLACES	± 0.10	± ---
1 PLACE	± 0.30	± ---
ANGULAR:	± 1/2°	

**Figure 18**  
Conductor Punch Tooling Grip Size M

THIS DOCUMENT CONTAINS INFORMATION THAT IS PROPRIETARY TO MOLEX ELECTRONIC TECHNOLOGIES, LLC AND SHOULD NOT BE USED WITHOUT WRITTEN PERMISSION.

<b>REVISION:</b>  <b>K</b>	<b>EC INFORMATION:</b> EC No: 633932 DATE: 2020/03/23	<b>TITLE:</b> <b>CTX50 UNSEALED RECEPTACLE TERMINAL APPLICATION SPEC</b>			<b>SHEET No.</b>  15 of 24
	<b>DOCUMENT NUMBER:</b> <b>AS-560023-001</b>	<b>DOC TYPE:</b> PS	<b>DOC PART:</b> 001	<b>CREATED / REVISED BY:</b> RGV	<b>CHECKED BY:</b> SMAHADIK

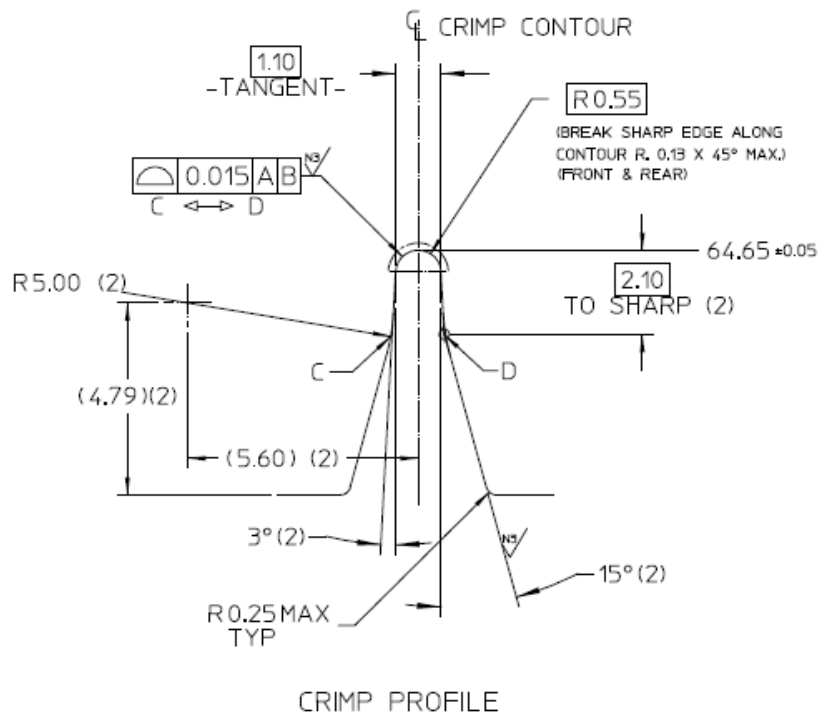
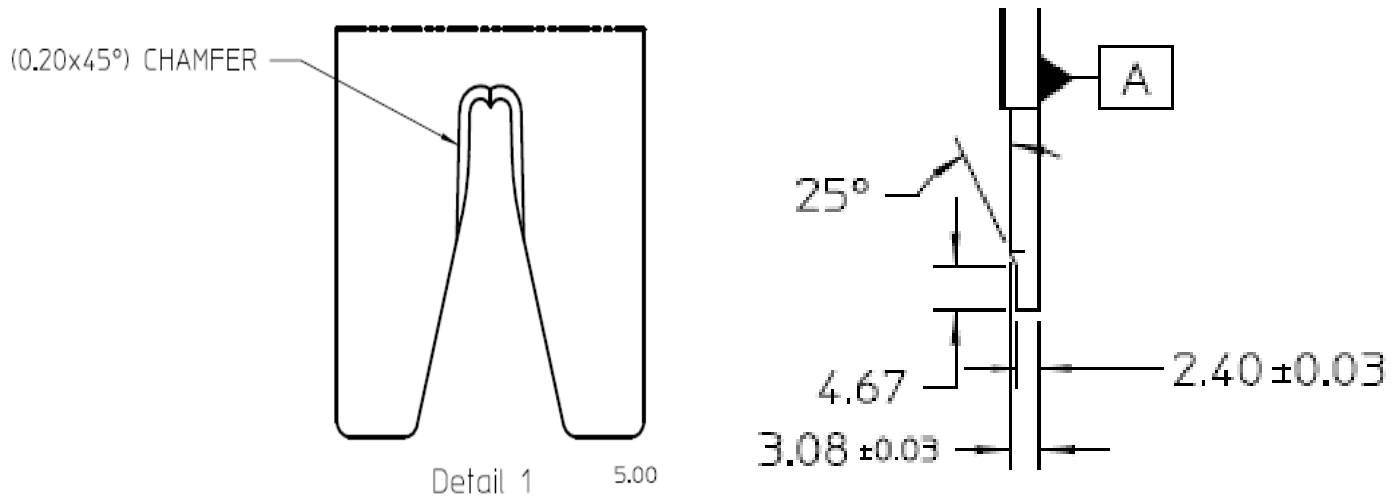

GENERAL TOLERANCE UNLESS OTHERWISE SPECIFIED		
DEC. PLCS.	mm	INCH
4 PLACES	± ---	± ---
3 PLACES	± ---	± ---
2 PLACES	± 0.10	± ---
1 PLACE	± 0.30	± ---
ANGULAR:	± 1/2°	

**Figure 19**  
Insulator Punch Tooling Grip Size M

THIS DOCUMENT CONTAINS INFORMATION THAT IS PROPRIETARY TO MOLEX ELECTRONIC TECHNOLOGIES, LLC AND SHOULD NOT BE USED WITHOUT WRITTEN PERMISSION.

REVISION: <b>K</b>	EC INFORMATION: EC No: 633932 DATE: 2020/03/23	TITLE: <b>CTX50 UNSEALED RECEPTACLE TERMINAL APPLICATION SPEC</b>	SHEET No. <b>16 of 24</b>
DOCUMENT NUMBER: <b>AS-560023-001</b>	DOC TYPE: <b>PS</b>	DOC PART: <b>001</b>	CREATED / REVISED BY: <b>RGV</b>
CHECKED BY: <b>SMAHADIK</b>		APPROVED BY: <b>JCUATACERVAN</b>	



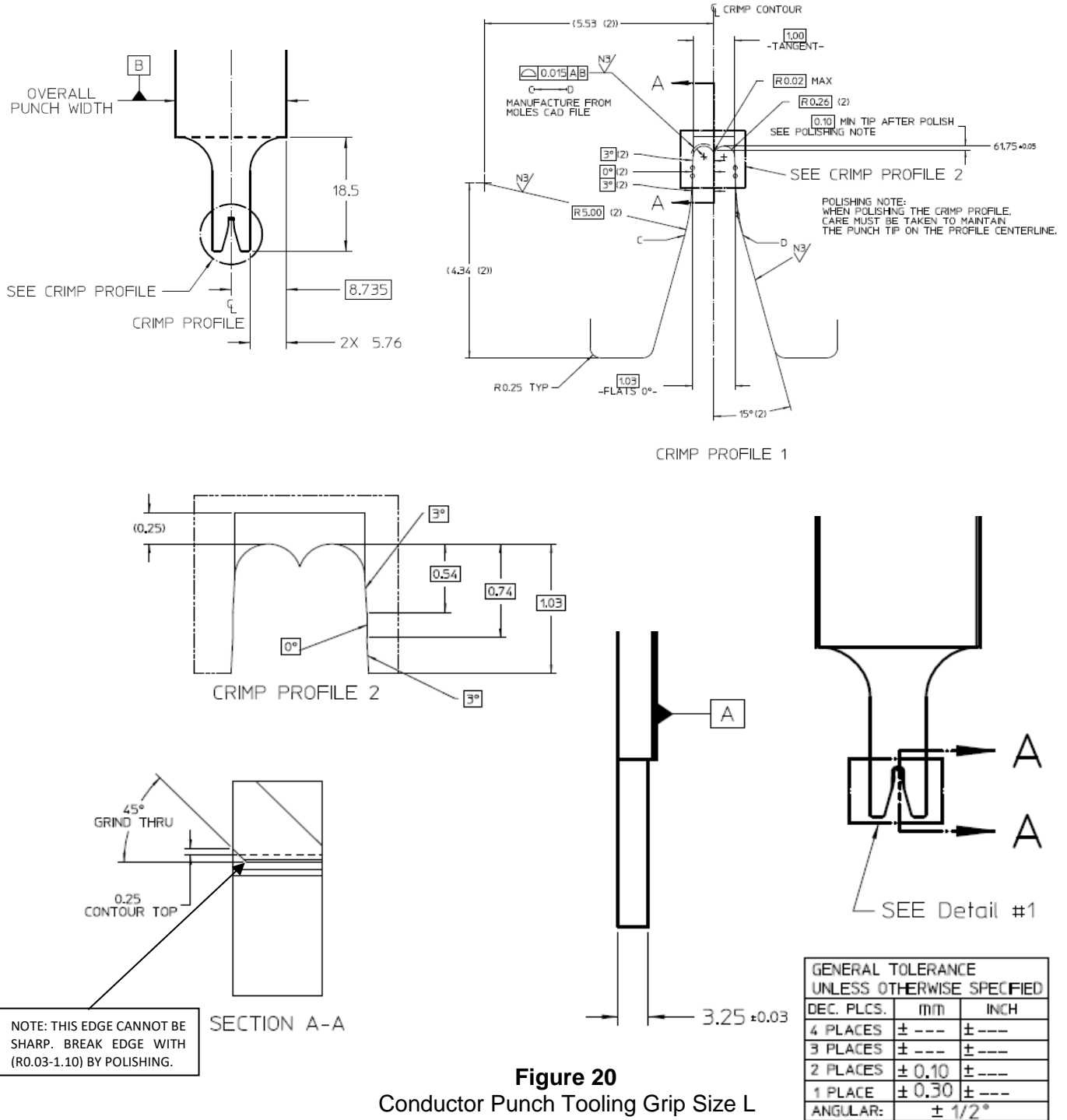

THIS DOCUMENT CONTAINS INFORMATION THAT IS PROPRIETARY TO MOLEX ELECTRONIC TECHNOLOGIES, LLC AND SHOULD NOT BE USED WITHOUT WRITTEN PERMISSION.

<b>REVISION:</b>  <b>K</b>	<b>EC INFORMATION:</b> EC No: 633932 DATE: 2020/03/23	<b>TITLE:</b> <b>CTX50 UNSEALED RECEPTACLE TERMINAL APPLICATION SPEC</b>			<b>SHEET No.</b>  17 of 24
	<b>DOCUMENT NUMBER:</b> <b>AS-560023-001</b>	<b>DOC TYPE:</b> <b>PS</b>	<b>DOC PART:</b> <b>001</b>	<b>CREATED / REVISED BY:</b> <b>RGV</b>	<b>CHECKED BY:</b> <b>SMAHADIK</b>

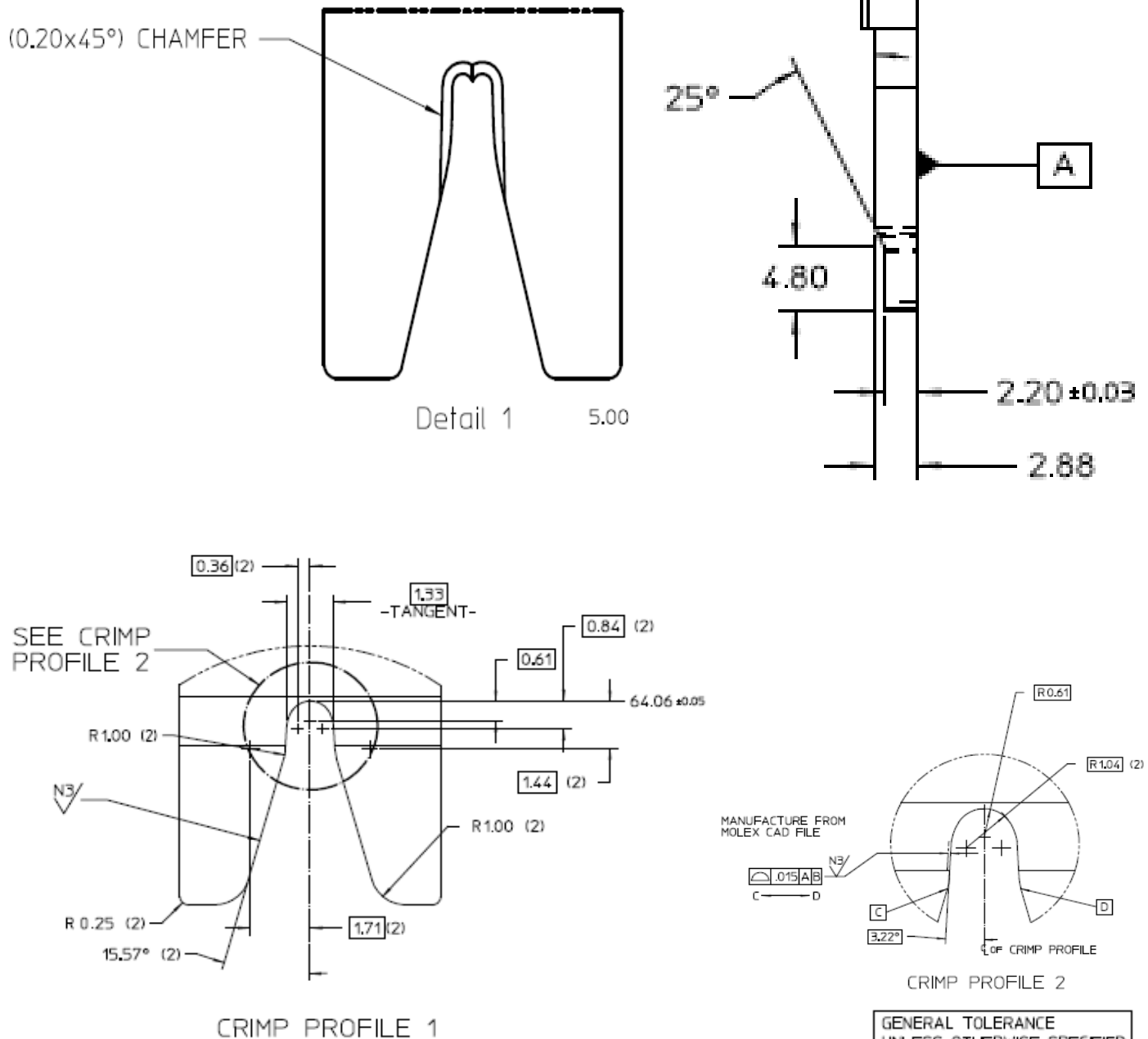

**Figure 21**  
Insulator Punch Tooling Grip Size L

THIS DOCUMENT CONTAINS INFORMATION THAT IS PROPRIETARY TO MOLEX ELECTRONIC TECHNOLOGIES, LLC AND SHOULD NOT BE USED WITHOUT WRITTEN PERMISSION.

REVISION: <b>K</b>	EC INFORMATION: EC No: 633932 DATE: 2020/03/23	TITLE: <b>CTX50 UNSEALED RECEPTACLE TERMINAL APPLICATION SPEC</b>				SHEET No. <b>18 of 24</b>
DOCUMENT NUMBER: <b>AS-560023-001</b>	DOC TYPE: <b>PS</b>	DOC PART: <b>001</b>	CREATED / REVISED BY: <b>RGV</b>	CHECKED BY: <b>SMAHADIK</b>	APPROVED BY: <b>JCUATACERVAN</b>	
TEMPLATE FILENAME: APPLICATION_SPEC[SIZE_A4] (V.4).DOCX						

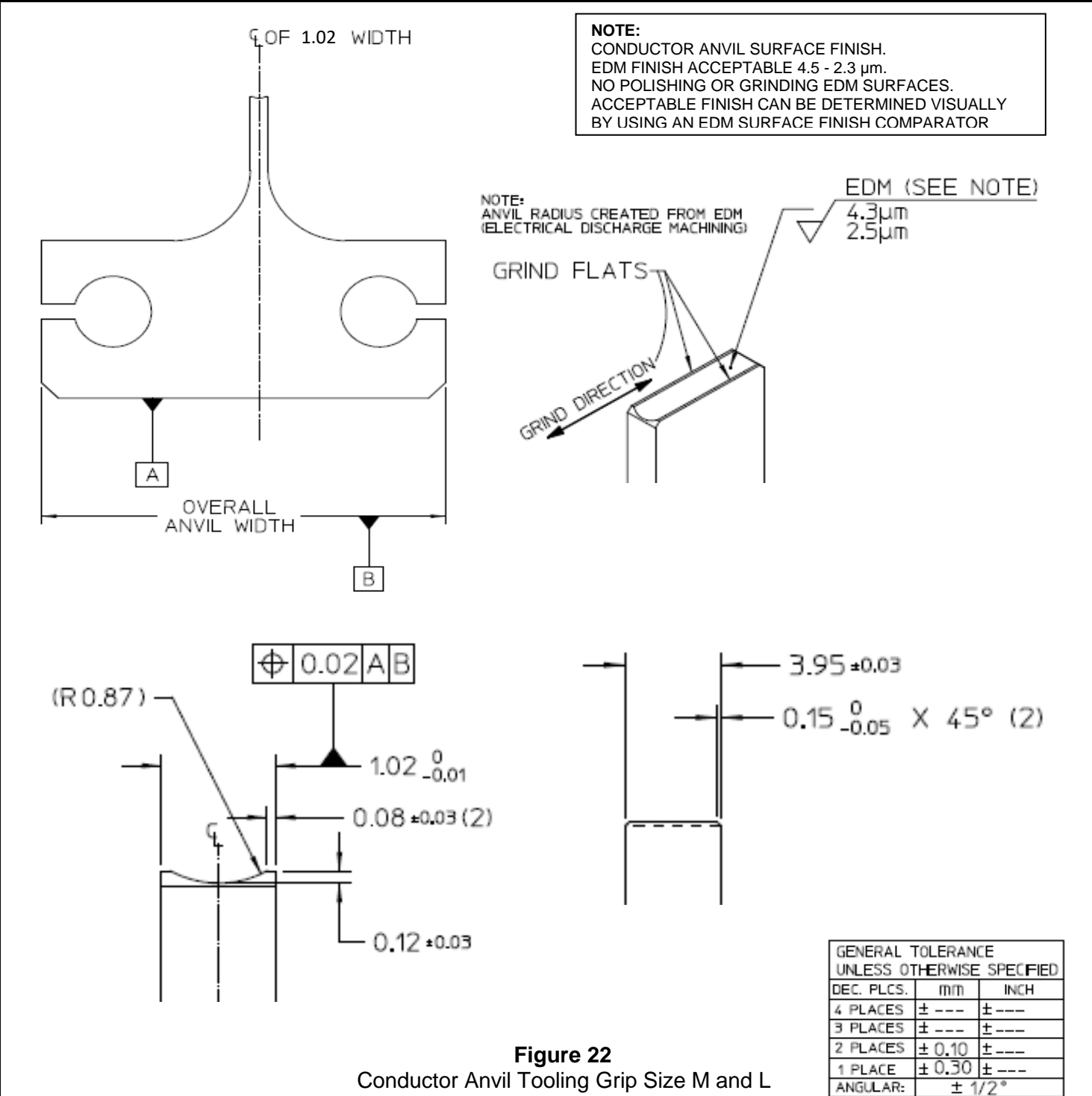
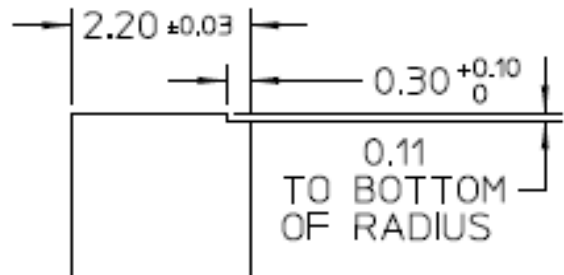
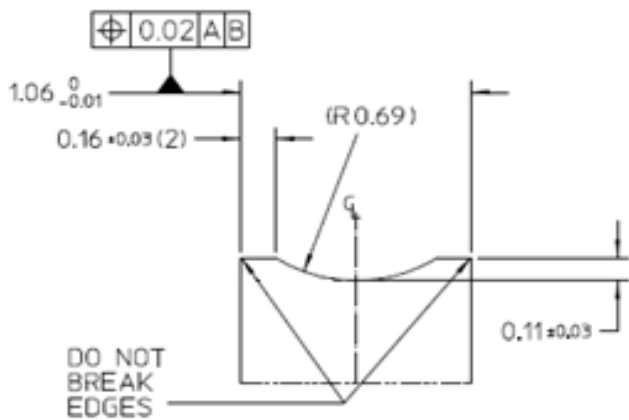
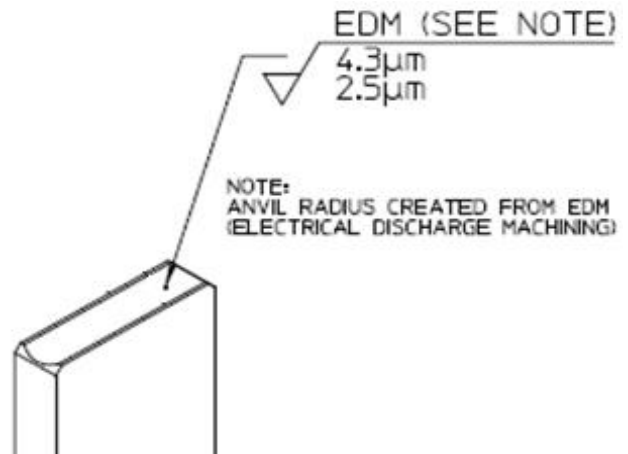
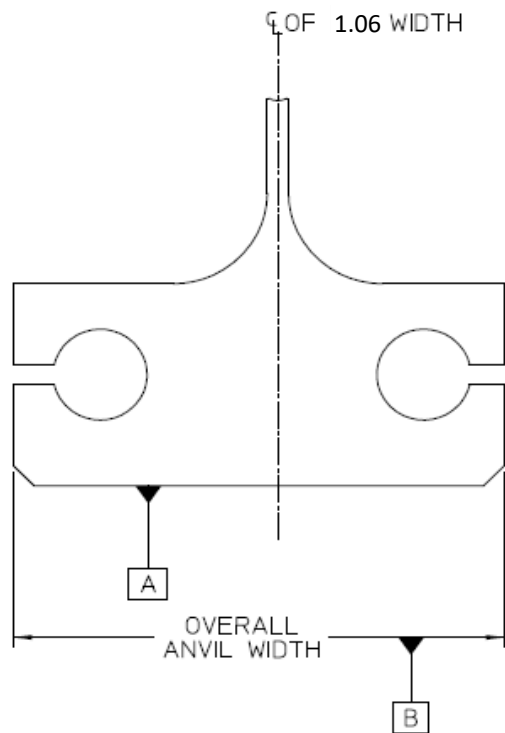

**Figure 22**  
 Conductor Anvil Tooling Grip Size M and L

THIS DOCUMENT CONTAINS INFORMATION THAT IS PROPRIETARY TO MOLEX ELECTRONIC TECHNOLOGIES, LLC AND SHOULD NOT BE USED WITHOUT WRITTEN PERMISSION.

REVISION: <b>K</b>	EC INFORMATION: EC No: 633932 DATE: 2020/03/23	TITLE: <b>CTX50 UNSEALED RECEPTACLE TERMINAL APPLICATION SPEC</b>	SHEET No. <b>19 of 24</b>
DOCUMENT NUMBER: <b>AS-560023-001</b>	DOC TYPE: <b>PS</b>	DOC PART: <b>001</b>	CREATED / REVISED BY: <b>RGV</b>
CHECKED BY: <b>SMAHADIK</b>		APPROVED BY: <b>JCUATACERVAN</b>	

**NOTE:**  
 CONDUCTOR ANVIL SURFACE FINISH.  
 EDM FINISH ACCEPTABLE 4.5 - 2.3  $\mu\text{m}$ .  
 NO POLISHING OR GRINDING EDM SURFACES.  
 ACCEPTABLE FINISH CAN BE DETERMINED VISUALLY  
 BY USING AN EDM SURFACE FINISH COMPARATOR



GENERAL TOLERANCE UNLESS OTHERWISE SPECIFIED		
DEC. PLCS.	mm	INCH
4 PLACES	± ---	± ---
3 PLACES	± ---	± ---
2 PLACES	± 0.10	± ---
1 PLACE	± 0.30	± ---
ANGULAR:	± 1/2°	

**Figure 23**  
 Insulator Anvil Tooling Grip Size M

THIS DOCUMENT CONTAINS INFORMATION THAT IS PROPRIETARY TO MOLEX ELECTRONIC TECHNOLOGIES, LLC AND SHOULD NOT BE USED WITHOUT WRITTEN PERMISSION.

<b>REVISION:</b> <b>K</b>	<b>EC INFORMATION:</b> EC No: 633932 DATE: 2020/03/23	<b>TITLE:</b> <b>CTX50 UNSEALED RECEPTACLE TERMINAL APPLICATION SPEC</b>				<b>SHEET No.</b> <b>20 of 24</b>
<b>DOCUMENT NUMBER:</b> <b>AS-560023-001</b>	<b>DOC TYPE:</b> <b>PS</b>	<b>DOC PART:</b> <b>001</b>	<b>CREATED / REVISED BY:</b> <b>RGV</b>	<b>CHECKED BY:</b> <b>SMAHADIK</b>	<b>APPROVED BY:</b> <b>JCUATACERVAN</b>	

**NOTE:**  
 CONDUCTOR ANVIL SURFACE FINISH.  
 EDM FINISH ACCEPTABLE 4.5 - 2.3  $\mu\text{m}$ .  
 NO POLISHING OR GRINDING EDM SURFACES.  
 ACCEPTABLE FINISH CAN BE DETERMINED VISUALLY  
 BY USING AN EDM SURFACE FINISH COMPARATOR

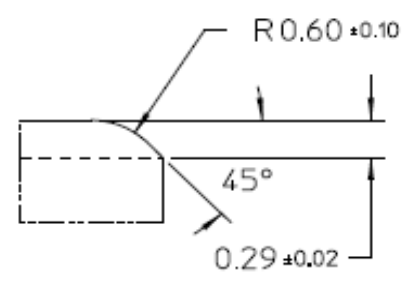
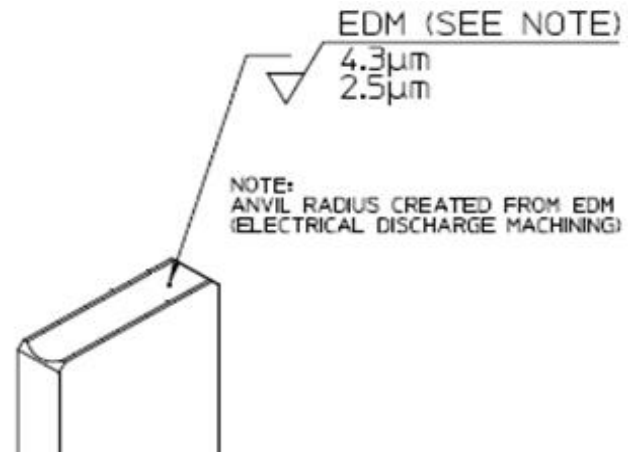
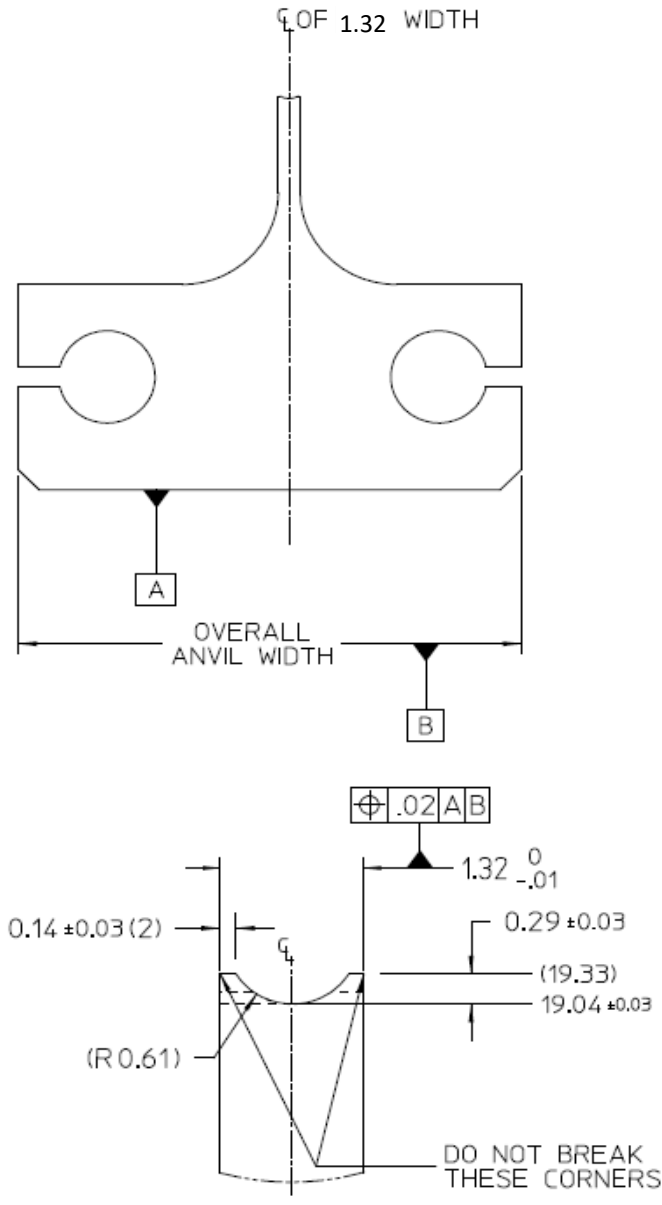

**CUTTING EDGE  
 KEEP SHARP**

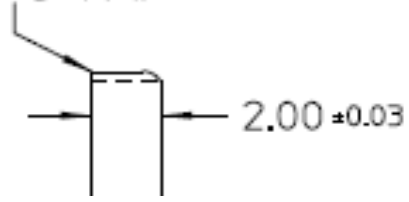

GENERAL TOLERANCE UNLESS OTHERWISE SPECIFIED		
DEC. PLCS.	mm	INCH
4 PLACES	± ----	± ----
3 PLACES	± ----	± ----
2 PLACES	± 0.10	± ----
1 PLACE	± 0.30	± ----
ANGULAR:	± 1/2°	

**Figure 24**  
 Insulator Anvil Tooling Grip Size L

THIS DOCUMENT CONTAINS INFORMATION THAT IS PROPRIETARY TO MOLEX ELECTRONIC TECHNOLOGIES, LLC AND SHOULD NOT BE USED WITHOUT WRITTEN PERMISSION.

<b>REVISION:</b> <b>K</b>	<b>EC INFORMATION:</b> EC No: 633932	<b>TITLE:</b> <b>CTX50 UNSEALED RECEPTACLE TERMINAL APPLICATION SPEC</b>				<b>SHEET No.</b> 21 of 24
	DATE: 2020/03/23	<b>DOC TYPE:</b> PS	<b>DOC PART:</b> 001	<b>CREATED / REVISED BY:</b> RGV	<b>CHECKED BY:</b> SMAHADIK	<b>APPROVED BY:</b> JCUATACERVAN
<b>DOCUMENT NUMBER:</b> AS-560023-001		TEMPLATE FILENAME: APPLICATION_SPEC(SIZE_A4) (V.4).DOCX				

### 7.0 CRIMP STRAIGHTNESS

A sample method for maintaining crimp straightness is shown in Figure 22 below.

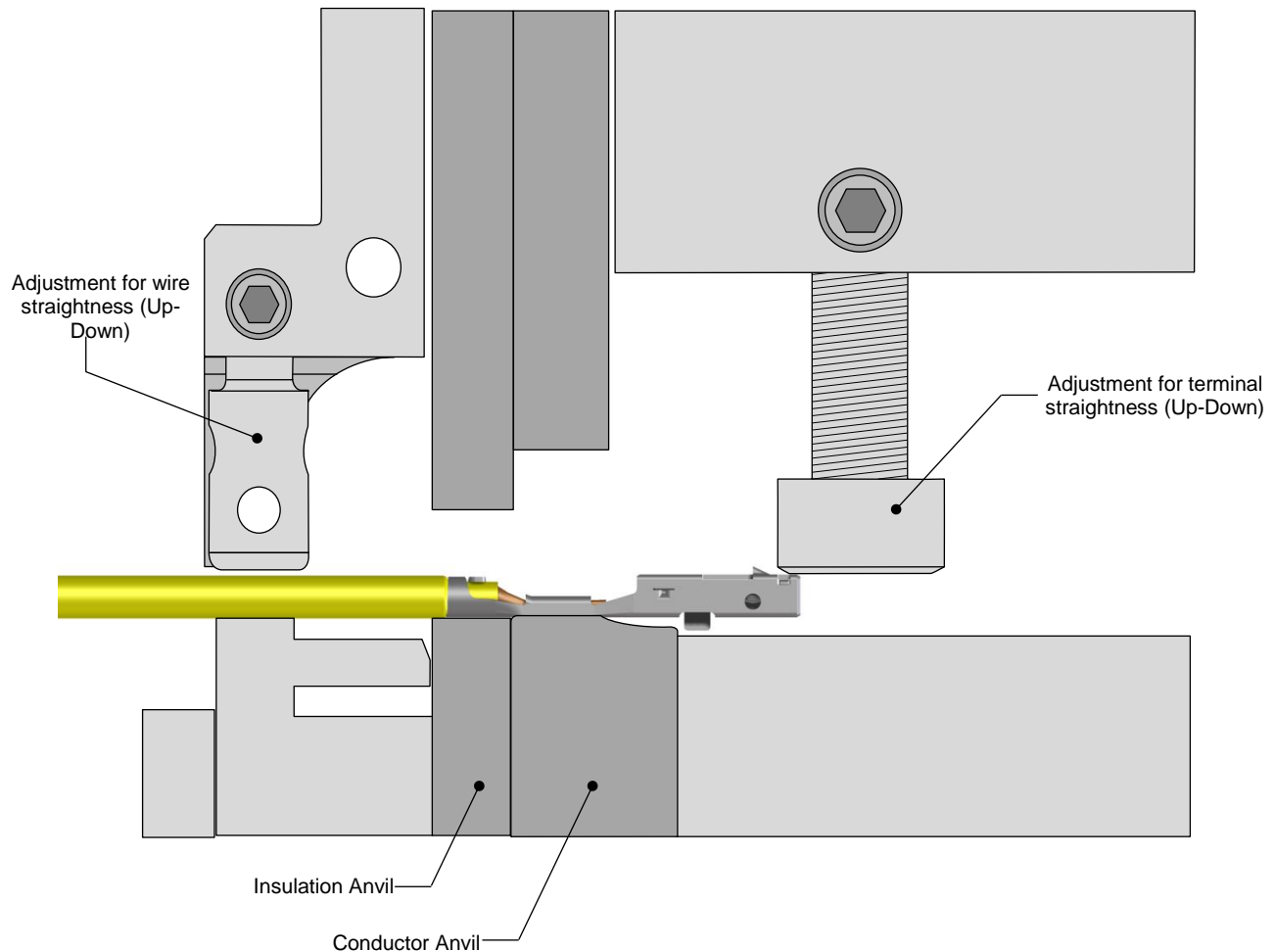

Figure 25

THIS DOCUMENT CONTAINS INFORMATION THAT IS PROPRIETARY TO MOLEX ELECTRONIC TECHNOLOGIES, LLC AND SHOULD NOT BE USED WITHOUT WRITTEN PERMISSION.

REVISION: <b>K</b>	EC INFORMATION: EC No: 633932 DATE: 2020/03/23	TITLE: <b>CTX50 UNSEALED RECEPTACLE TERMINAL APPLICATION SPEC</b>			SHEET No. <b>22 of 24</b>
DOCUMENT NUMBER: <b>AS-560023-001</b>	DOC TYPE: <b>PS</b>	DOC PART: <b>001</b>	CREATED / REVISED BY: <b>RGV</b>	CHECKED BY: <b>SMAHADIK</b>	APPROVED BY: <b>JCUATACERVAN</b>
TEMPLATE FILENAME: APPLICATION_SPEC[SIZE_A4] (V.4).DOCX					

## 8.0 APPLICATION TOOLING

Application Tooling for the CTX50 Receptacle Terminal can be obtained directly from Molex.

To find the proper and latest Molex Application Tooling

1. Go to <http://www.molex.com>
2. Enter the terminal / connector part number into the search box and select the "Go" button.
  - a. Molex part numbers can also be found by searching on the product description.
3. Review the Application Tooling available on the right side of the product window.
  - a. It may be necessary to scroll down on the right side of the terminal / connector product page to view all the tooling options.
  - b. Hand tools and manual type tools require the loose terminal / connector part number to be used in the search.
  - c. Applicator or semi-automatic type tools require the reeled terminal / connector part number to be used in the search.
4. Select the tool part number link
5. Review the tooling page for general tool information
6. Open the link for the Application Tooling Specification (ATS) (located on the left under *Specifications & Other Documents*) for additional details such as:
  - a. Termination specifications: crimp height, pull force, wire strip length, insulation diameter, etc.
  - b. Tool information: tool diagram, tool parts list, repair parts, perishable parts list.
7. Order Molex Application Tooling through your preferred distributor

Notes:

1. Hand crimp tooling can only be used with certain wires and terminal part numbers. Check the Application Tooling Specification Sheet on the Molex website for details.
2. Application Tooling product numbers are subject to change without prior notice. Customers are advised to check the Molex website for the most up-to-date information.
3. Molex FineAdjust™ and MiniMac™ Application Tooling requires the use of left payoff ("D" Wind) parts.

THIS DOCUMENT CONTAINS INFORMATION THAT IS PROPRIETARY TO MOLEX ELECTRONIC TECHNOLOGIES, LLC AND SHOULD NOT BE USED WITHOUT WRITTEN PERMISSION.

<u>REVISION:</u> <b>K</b>	<u>EC INFORMATION:</u> EC No: <b>633932</b>  DATE: <b>2020/03/23</b>	<u>TITLE:</u> <b>CTX50 UNSEALED RECEPTACLE TERMINAL APPLICATION SPEC</b>			<u>SHEET No.</u> <b>23 of 24</b>
<u>DOCUMENT NUMBER:</u> <b>AS-560023-001</b>	<u>DOC TYPE:</u> <b>PS</b>	<u>DOC PART:</u> <b>001</b>	<u>CREATED / REVISED BY:</u> <b>RGV</b>	<u>CHECKED BY:</u> <b>SMAHADIK</b>	<u>APPROVED BY:</u> <b>JCUATACERVAN</b>
<small>TEMPLATE FILENAME: APPLICATION_SPEC[SIZE_A4] (V.4).DOCX</small>					



# APPLICATION SPECIFICATION

## Application Spec Revision Log

Change	By	Date	Revision Number
Added min tip dimension and radius of tip for small grip conductor punch and changed value to 0.10 for medium and large grip conductor punches. All crimp tooling drawings updated to reflect current AH tooling. Added dimensions for Anvil Step of crimp tooling. Insulation Grip Step tolerance increased to ±0.05. Crimp Bulge (balloon 17) changed to 1.07 MAX. Table 3: Removed rolling requirement. Twisting requirement increased to 2° MAX.	J. Burgio	07/19/2016	D
Addition of new small grip part number specifications, crimp tooling views, and crimp bulge requirements. Updates to Figure 4, Figure 12, Table 2, Table 3, and Section 6.	J. Burgio	11/03/2016	E
Corrected missing flat to flat dimension on Figures 19 & 20. Addition of FLR13Y-A wire in Table 2.	J. Burgio	12/20/2016	E1
Insulator punch tooling thickness reduced for P/N 560023-0444/0445: Figure 16. Revision is "steel safe".	J. Burgio	02/23/2017	E2
Addition of L-grip Au terminals (Table 1 & Table 2). A3Z wire validated for L-grip Sn terminals (Table 2).	J. Burgio	5/16/2017	F
Adding PSA wire: FTP: 00949_10_00766	F. Petit-Pierre	12/06/2017	G
Rear Bell mouth (Balloon 5a) tolerance on grip code L changed from 0.05 to 0.10	F. Petit-Pierre	05/02/2018	H
Page 8: Modification of A3Z CCH in Table 3 - FTP: 00949_10_00766 is equivalent to 0.35mm2 T3ZHID wire	F. Petit-Pierre	05/02/2018	H
Removed obsoleted S-grip part number 560023-0422/0424. Released Au S-grip. Added UL10086, UL10588, UL10316, UL1332 wires, number of strands column and outer diameter of wire column to table 2. Cleaned up table 1 and 3. Edited crimp tooling figures, Edited front bell mouth value. Added EDM finish notes to anvil sheets.	S. Mahadik	09/27/2018	J
Added FHLR9Y wire, number of strands column and outer diameter of wire column to table 2	B.Skantharaju	02/17/2020	J1
Updated missed information on Terminal straightness from Rev J in page 2	B.Skantharaju	02/26/2020	J2
Updated to latest template format, Added conductor grip and wire straightness callout	RGV	03/12/2020	K

THIS DOCUMENT CONTAINS INFORMATION THAT IS PROPRIETARY TO MOLEX ELECTRONIC TECHNOLOGIES, LLC AND SHOULD NOT BE USED WITHOUT WRITTEN PERMISSION.

<b>REVISION:</b> <b>K</b>	<b>EC INFORMATION:</b> EC No: 633932 DATE: 2020/03/23	<b>TITLE:</b> <b>CTX50 UNSEALED RECEPTACLE TERMINAL APPLICATION SPEC</b>			<b>SHEET No.</b> <b>24 of 24</b>
<b>DOCUMENT NUMBER:</b> <b>AS-560023-001</b>	<b>DOC TYPE:</b> <b>PS</b>	<b>DOC PART:</b> <b>001</b>	<b>CREATED / REVISED BY:</b> <b>RGV</b>	<b>CHECKED BY:</b> <b>SMAHADIK</b>	<b>APPROVED BY:</b> <b>JCUATACERVAN</b>
<small>TEMPLATE FILENAME: APPLICATION_SPEC[SIZE_A4] (V.4).DOCX</small>					