

REV	ECN	DESCRIPTION	APPD
A		RELEASE	

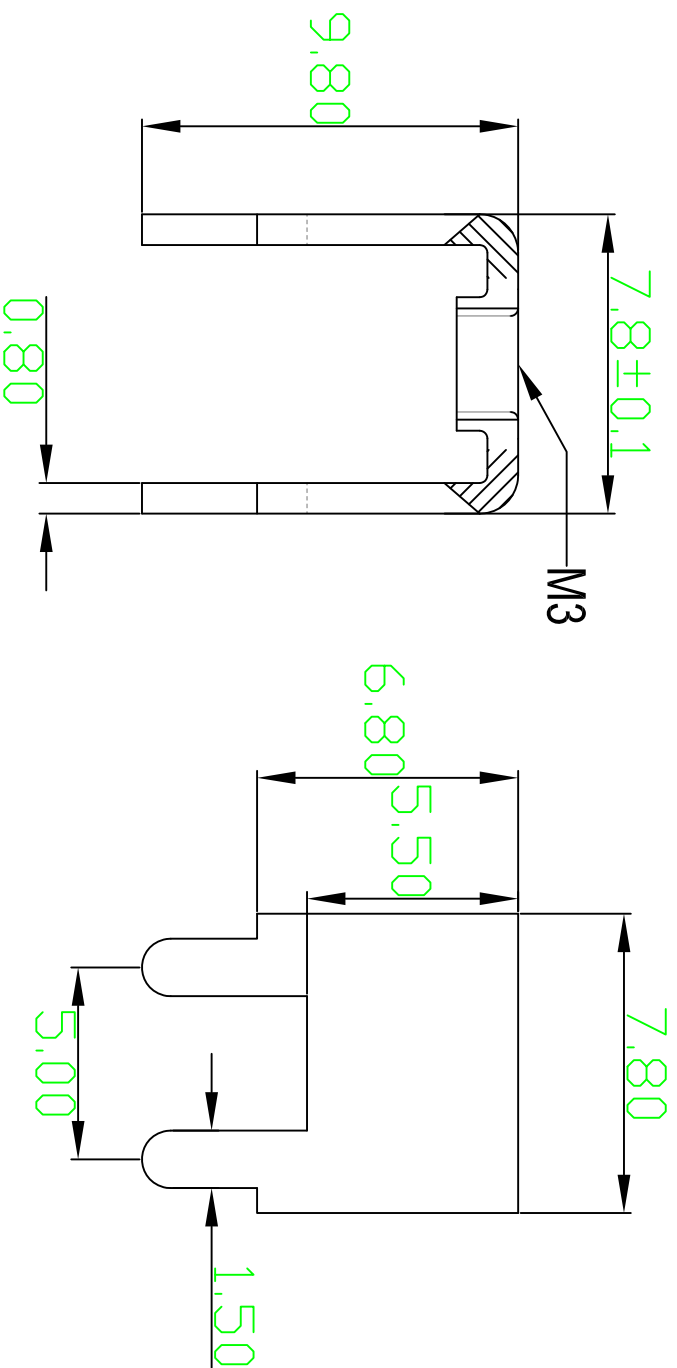

技术要求:

1. 攻牙不能有毛刺，牙裂现象。
2. 引脚尖部符合可焊性要求。
3. 螺纹需符合通止规要求。
4. 螺纹扭矩：7 lbf·in。
5. 先打铜底0.5μm，再镀锌2.5μm，最后镀雾锡3μm。
6. 注⊗为重点检测尺寸。

DIMENSIONS		TOLERANCES		PROJECTION		TERMINAL INC		TITLE	
ANSI Y14.5M	.XX	±0.2	⊙	ENGR	CHKD	MFP 04311-T1金属插脚		SIZE	REV
UNITS: MM	ANGLES	±0.10	▽	OF APPD	B	DWG NO.	550400088	DWG NO.	A
Proj FILE	±1°					CODE: 58982	SCALE: 1:1		SHEET 1 OF 1
ORIGINAL NOT FOR CUSTOMER DISTRIBUTION	THIS DOCUMENT CONTAINS PROPRIETARY INFORMATION WHICH IS THE CONFIDENTIAL PROPERTY OF TERMINAL INC., DONGGUAN CHINA								