

TACT SWITCH  
**T1B** SERIES

2.6\*1.6 J Terminal SMT Type  
(H=0.55mm)

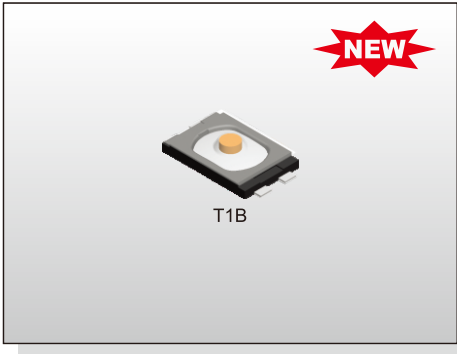

T1B

**FEATURES**

- ※ Compact-size 2.6\*1.6mm
- ※ Low profile with 0.55mm
- ※ 200,000 operation cycles

**APPLICATION**

- ※ Smart phone
- ※ Digital camera, Medical
- ※ Portable electronic device
- ※ 3C products

**SPECIFICATION**

Contact Rating	10uA, 2V DC to 20mA, 15V DC
Contact Resistance	500mΩ max.
Insulation Resistance	50MΩ min. 100V DC
Dielectric Strength	250V AC/1 minute
Operating Force	160±50gf
Travel	0.11mm
Operating Life	300,000 cycles
Operating Temp.	-40°C ~ +85°C
Storage Temp.	-40°C ~ +85°C

**HOW TO ORDER**

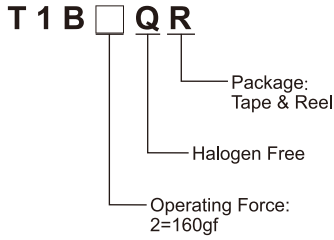

**CIRCUIT**

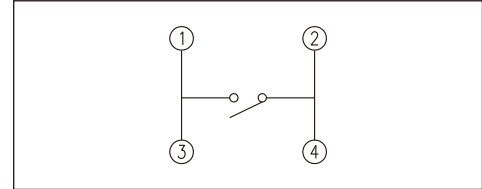

**PACKAGE**

<Tape & Reel>  
5000 pcs

TACT SWITCH

**T1B**

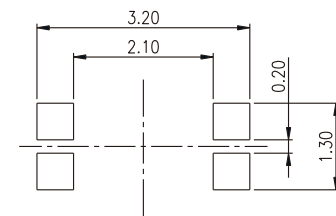
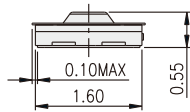
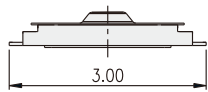
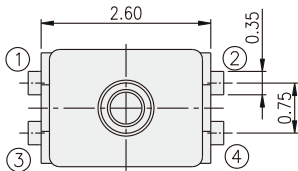

P.C.B. LAYOUT