

■ Specifications :

- Voltage rating: 600V AC / DC
- Current rating: 15A AC / DC
- Withstanding voltage: 5000V AC/minute
- Temperature range: -25°C~+85°C
- Insulation resistance: $\geq 1000M\Omega$
- Contact resistance: $\leq 3.5m\Omega$
- After environmental testing: $\leq 10m\Omega$

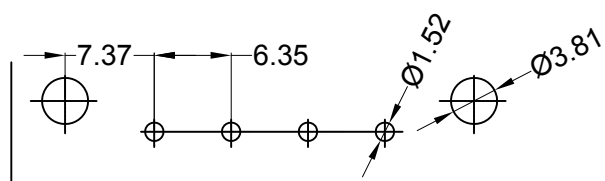

Recommended P.C.B Layout
General Tolerance ± 0.05

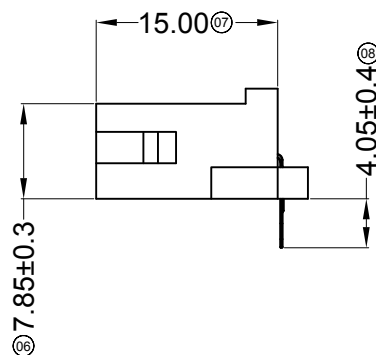
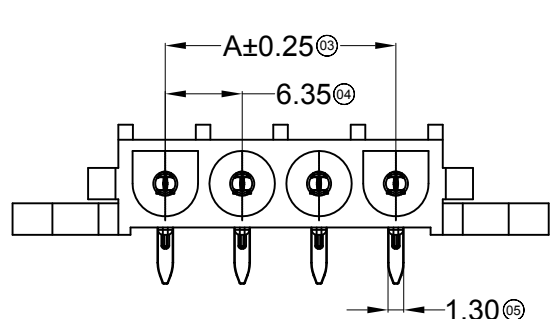
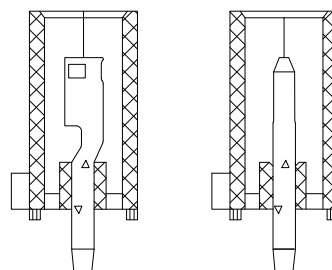

TYPE 1

TYPE 2

Poles	Dimensions(mm)	
	A	B
02	6.35	14.10
03	12.70	20.45
04	19.05	26.80
05	25.40	33.16
06	31.75	39.50
07	38.10	45.85
08	44.45	52.20

				TOLERANCE UNLESS OTHERWISE		DRAWN	CK tan	XFCN 兴飞连接器有限公司 CONNECTORS XFCN CONNECTORS CO., LTD.		SHEET	1/1
				X.	± 0.30	X°	$\pm 5^\circ$			CHKD	DATE
				.X	± 0.20	.X°	$\pm 2^\circ$	APPD	PRODUCT NAME	6.35mm Crimp Style Connectors	
				.XX	± 0.08	.XX°	$\pm 1^\circ$	VIEW	PART. NO.	M9848R-1xX	
				.XXX	± 0.03	.XXX°	$\pm 0.5^\circ$			SCALE	1:1
AO	MODIFICATION		DRAW	DATE					DWG NO.	009	