

NOTES:  
 1.MATERIAL AND FINISH SEE THE TABLE.  
 2.MECHANICAL CHARACTERISTICS  
 INSERTION FORCE: 44.1N MAX  
 EXTROCTION FORCE: 9.8N MIN, 39.2N MAX  
 MATING CYCLE:10000 CYCLES  
 3.ELECTRICAL CHARACTERISTICS  
 RATING CURRENT: 0.5A  
 RATING VOLTAGE: 40V  
 CONTACT RESISTANCE: 10 MILLOHMS OHMS MAX  
 (EXCLDUING CONDUCTOR RESISTANCE)  
 INSULATION RESISTANCE:  
 a, UNMATED: 100M OHMS MIN AT 500 VDC  
 b, MATED: 10M OHMS MIN AT 150 VDC  
 DIELECTRIC WITHSTANDING VOLTAGE:  
 500V AC/1MINUTE  
 OPERATING TEMPERATURE: -20°C--+85°C  
 STORAGE TEMPERATURE: -20°C--+65°C

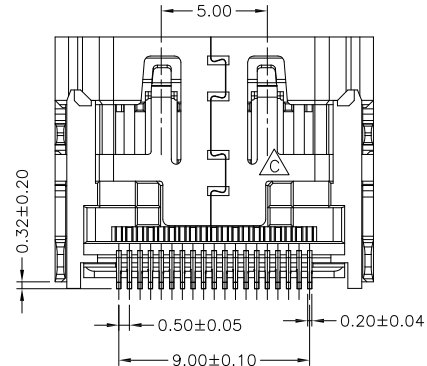
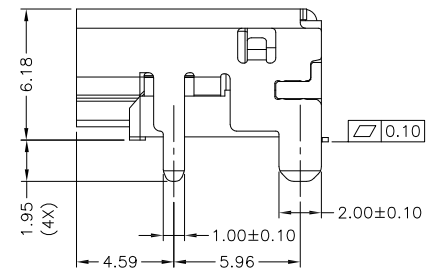
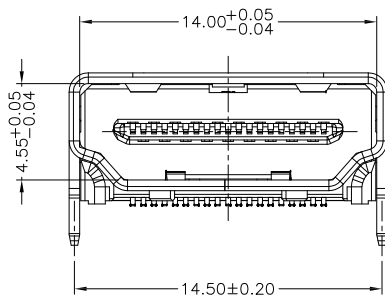

03	端子	C2680, T=0.20	底镀50u"Min. 接触区见料号说明, 尾部镀锡80u"Min.	1set
02	铜壳	C2680, T=0.50	镀可焊镍50u"Min. (无 LOGO)	1
01	半成品	LCP UL94V-0	黑色	1
NO.	名称	材质	电镀/颜色	数量

					ANGLAR	±5°	DSND		DATE		SCALE: N/A	MODEL TYPE: HDMI AF 19P SMT CONN		
△X					L ≤ 4	±0.2	DWN		DATE		VIEW:	PART NO.:		
△X					4 < L ≤ 16	±0.3	CHKD		DATE		UNIT: mm	DWG NO.:		
△X					16 < L ≤ 63	±0.4	APPD		DATE		SIZE: A4	A71-05H9-111N1		
MARK	DESCRIPTION	DATE	REVISED	APPROVED	L > 63	±0.5	UNSPECIFIED TOLERANCES					WEIGHT	SHEET	REVISION
REVISIONS						KXB INDUSTRIAL PRECISION CO.,LIMITED						1.0g	1/1	A0
www.xk-dg.cn www.helloxkb.com www.helloxkb.cn														