

REV	LOCATIONS	DESCRIPTION	DATE	REVISER	APPD

**SPECIFICATIONS**

**Electrical**

Current Rating: 0.5A AC(rms)/DC  
Voltage Rating: 50V AC(rms)/DC  
Contact Resistance: 30 mΩ Max  
Insulation Resistance: 500 MΩ MIN  
Withstanding Voltage: 500V AC r.m.s  
Temperature Range—Operating: -25°C~+85°C

**Material and Plating**

Housing: PA46 UL94V-0/ Natural  
Terminal: Phosphor Bronze/ Tin Plated Over Nickel  
Actuator: PPS UL94V-0/ Natural

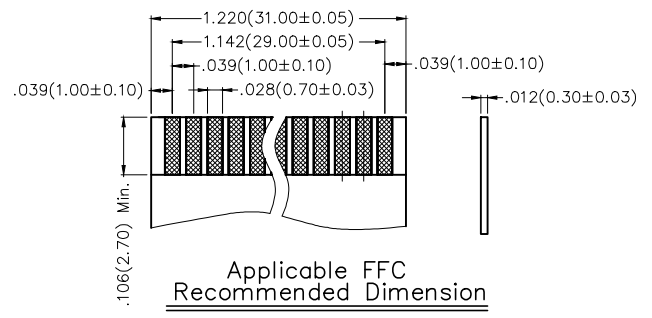
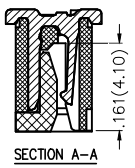
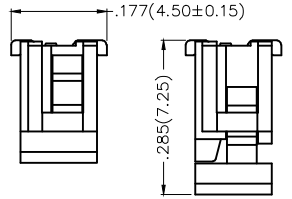
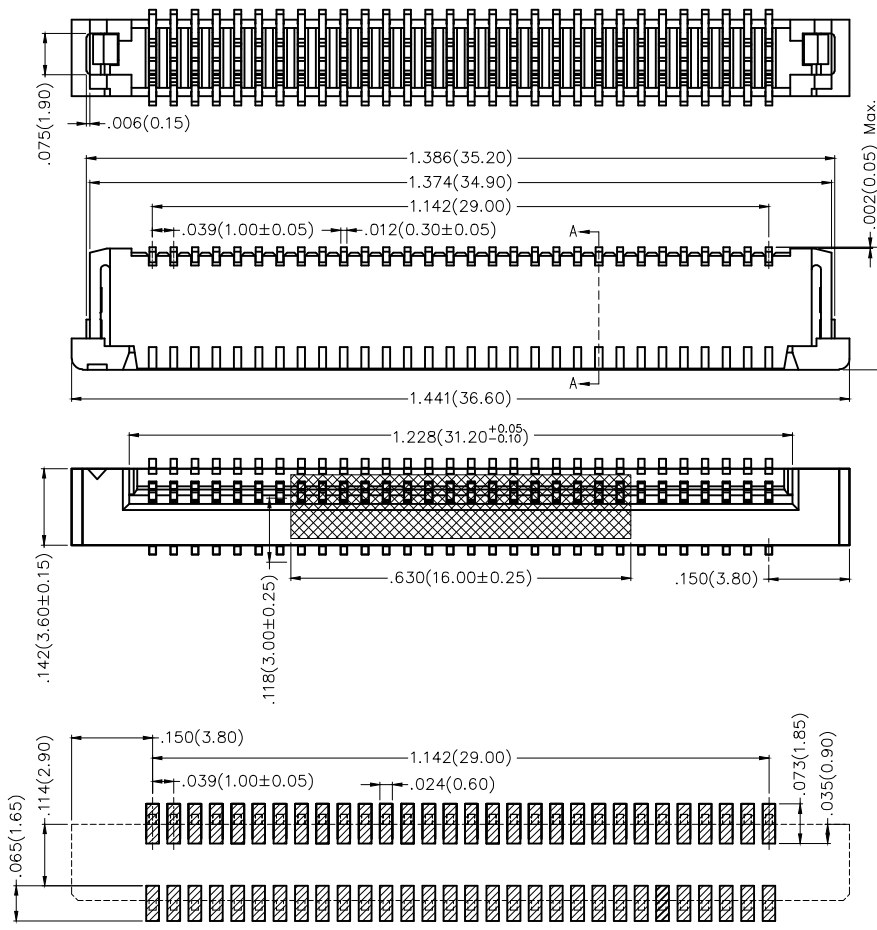

Recommended P.C.Board Layout  
General Tolerances: 0.05mm

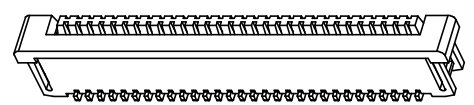

**Ordering Information**

FFC	100	50	—	30	S	S	1	2	6	W5	M
1	2	3	4	5	6	7	8	9	10	11	

1   Category FFC—FPC	2   Series Number 100—Pitch1.00mm	3   Distinction No. 50	4   Circuits 30	5   Assemble Layout S—SMT	6   Entry Angle S—Vertical
7   ZIF 1—ZIF	8   Plating 2—Tin Plated All	9   Material—Resin 6—PA46	10   Color—Resin W5— Natural	11   Packaging M—Reel	

 THIRD ANGLE PROJECTION	GENERAL TOLERANCES (UNLESS SPECIFIED)		APPROVE BY FRANK	DATE 12/JUL/16	PART NO. FFC10050-30SS126W5M	ITEM NO. FFC10050	 Leader Of Industry	
	X.±.012(0.30)	X'.±5'	CHECKED BY CHERRY	DATE 12/JUL/16	TITLE FPC/FFC Connector 1.00mm Positive Needle DIP			REV 0
DESIGN UNITS Inch (metric)	X.X±.008(0.20)	.X'±2'	DRAWN BY KATE	DATE 12/JUL/16	THIS DRAWING CONTAINS INFORMATION THAT IS PROPRIETARY TO TXGA INDUSTRIAL ELECTRONICS(S,Z)CO.,LTD AND SHOULD NOT BE USED WITHOUT WRITTEN PERMISSION			
SCALE 5:1	SIZE A4	X.XX±.006(0.15)						
		X.XXX±.004(0.10)						

1 2 3 4 5 6 7 8

REV	LOCATIONS	DESCRIPTION	DATE	REVISER	APPD

- Note:
- 10 sprocket hole cumulative tolerance  $\pm 0.2$
  - Carrier camber is within 1.0mm in 250mm
  - Material: White Conductive polystyrene Alloy 100% recyclable
  - All dimensions meet EIA-481-3 requirements
  - Peel off force of cover tape & carrier tape: 20g~130g(0.2N~1.3N)
  - Component load per 13" reel: 1,000 pcs

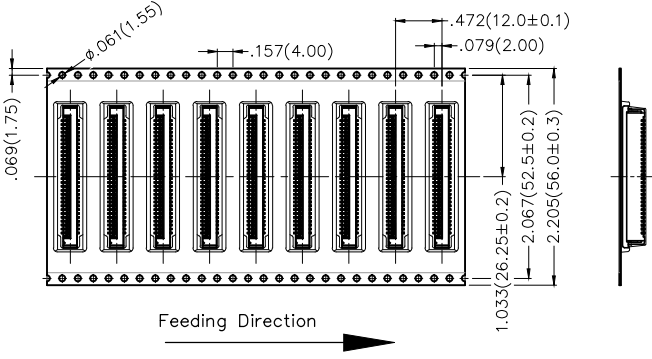
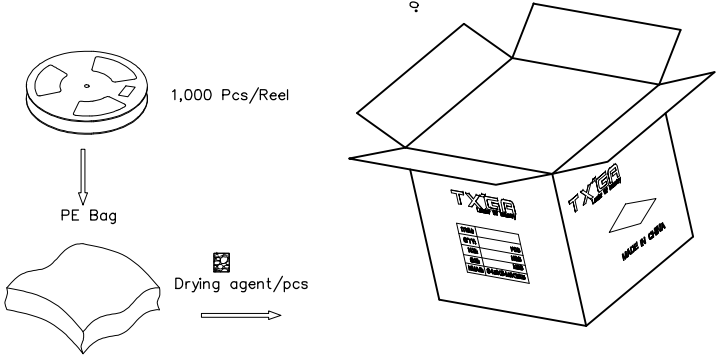
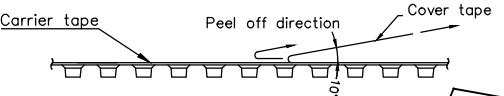
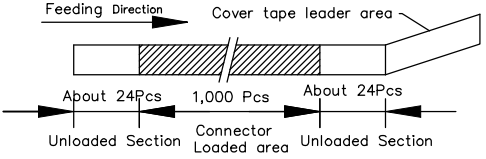
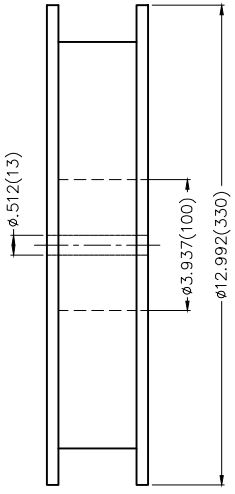
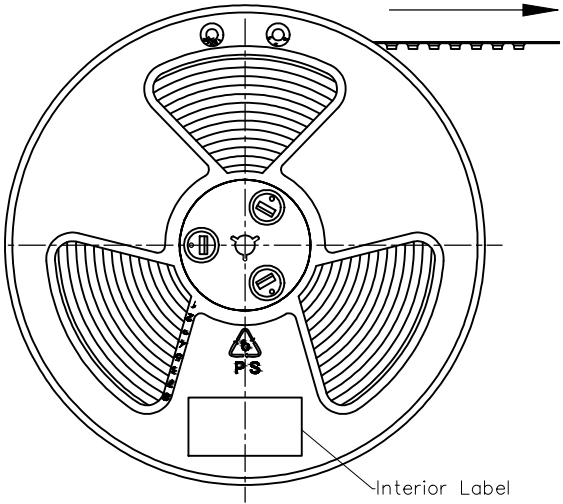

 THIRD ANGLE PROJECTION	GENERAL TOLERANCES (UNLESS SPECIFIED)		APPROVE BY	DATE	PART NO.	ITEM NO.	 Leader Of Industry
	X.±0.12(0.30)	X.±5'	FRANK	12/JUL/16	FFC10050-30SS126W5M	FFC10050	
DESIGN UNITS	X.X±.008(0.20)	.X'±2'	CHECKED BY	DATE	TITLE		REV 0    SHEET NO. 2/2
Inch (metric)	X.XX±.006(0.15)	.XX'±1"	CHERRY	12/JUL/16	FPC/FFC Connector 1.00mm Positive Needle DIP		
SCALE	X.XXX±.004(0.10)	.XXX'±0.5'	DRAWN BY	DATE	THIS DRAWING CONTAINS INFORMATION THAT IS PROPRIETARY TO TXGA INDUSTRIAL ELECTRONICS(S,Z)CO.,LTD AND SHOULD NOT BE USED WITHOUT WRITTEN PERMISSION		
5:1			KATE	12/JUL/16			

1 2 3 4 5 6 7 8