

REV	LOCATIONS	DESCRIPTION	DATE	REVISER	APPD
1	△	Dimensions change	28/DEC/17	KATE	FRANK

SPECIFICATIONS

Electrical
 Current Rating: 1.0A AC(rms)/DC
 Voltage Rating: 30V AC(rms)/DC
 Contact Resistance: 30 mΩ Max
 Insulation Resistance: 1000 MΩ MIN
 Withstanding Voltage: 500V AC r.m.s
 Temperature Range-Operating: -40°C~+85°C

Material
 Housing: Thermoplastic (UL 94V-0) , White
 Terminal: Copper alloy
 Shell: Brass

Plating
 Terminal: Gold in contact area, tin on tail
 Shell: Nickel plated

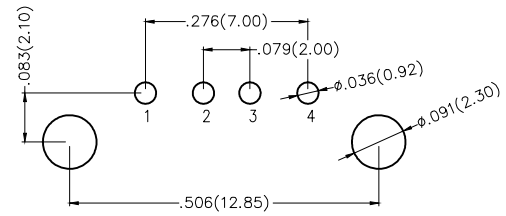
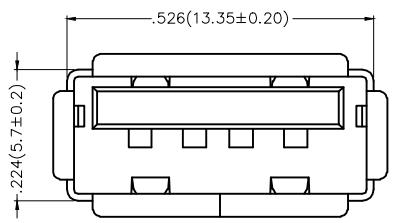
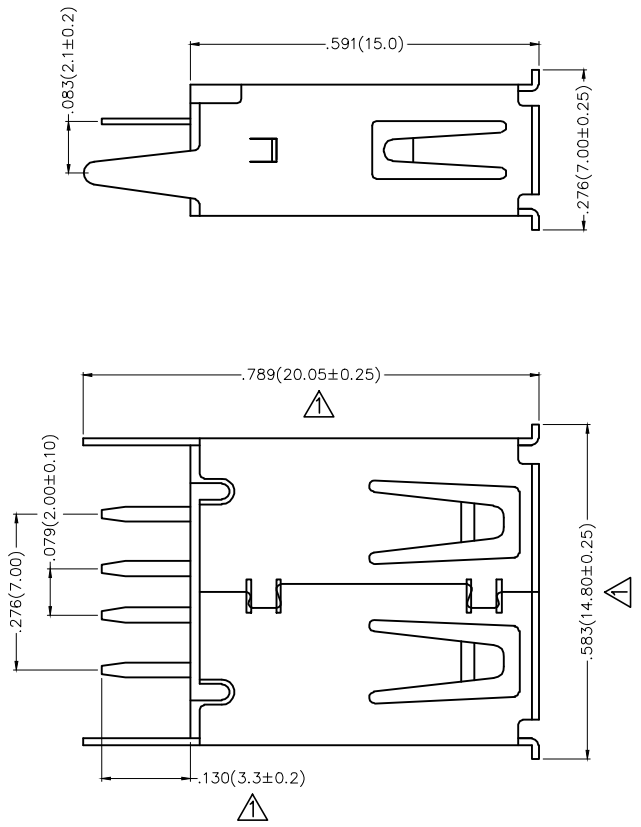

Recommended P.C.Board Layout

 THIRD ANGLE PROJECTION	GENERAL TOLERANCES (UNLESS SPECIFIED)		APPROVE BY Frank	DATE 17/AUG/10	PART NO. FUS220-FDSW1K	ITEM NO. FUS220	 Leader Of Industry	
	X.±.012(0.30)	X'.±5'	CHECKED BY Lynn	DATE 17/AUG/10	TITLE USB A-type 4Circuits 180°Vertical Female(DIP)			REV 1
	DESIGN UNITS Inch (metric)	X.X±.008(0.20)	.X'±2'	DRAWN BY Rong	DATE 17/AUG/10	THIS DRAWING CONTAINS INFORMATION THAT IS PROPRIETARY TO TXGA INDUSTRIAL ELECTRONICS(S.Z)CO.,LTD AND SHOULD NOT BE USED WITHOUT WRITTEN PERMISSION		
	SCALE 5:1	SIZE A4	X.XX±.006(0.15)					