

REV.	ECON. NO.	APPD.
A		

NOTES:
 Rated Current: 1.0AMP
 Contact Resistance: 20mΩ max
 Withstand Voltage: 500V AC/DC
 Insulation Resistance: 1000MΩ min
 Operation Temperature: -40°C to +105°C

Contact Material: Phosphor Bronze
 Contact plating: Au Or Sn over Ni
 Insulator Material: PBT+30%G.F. UL94V-0

Ordering Information

MTFC42-XX Y X

No. of Pins
 10 34
 14 40
 16 50
 20 60
 24 70
 26 80
 30 100

Bump
 N=W/O Bump
 W=W/ith Bump

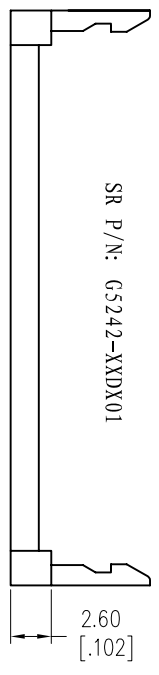
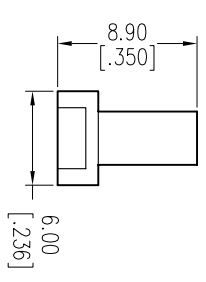
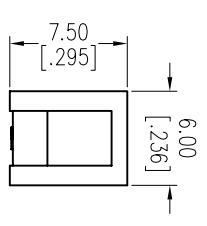
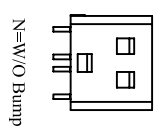
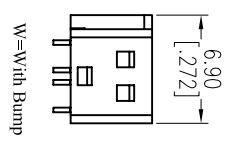
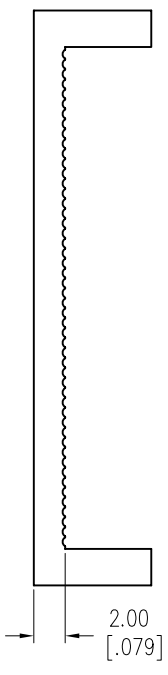
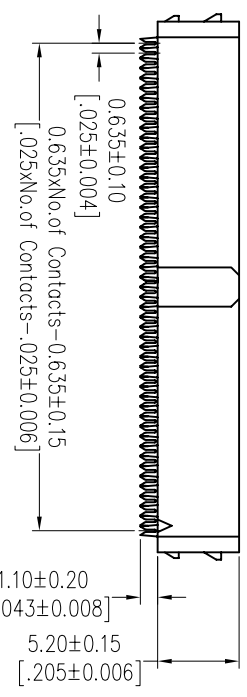
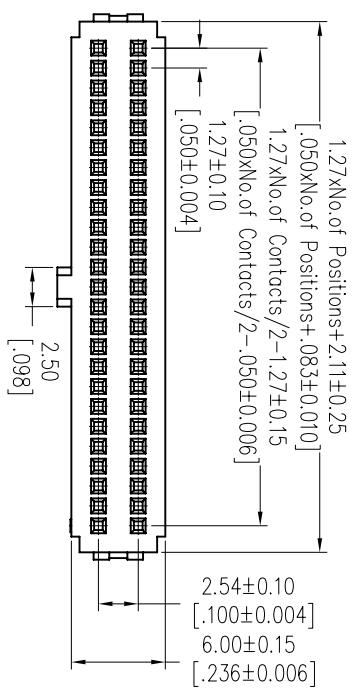

X.	± 0.30	X.°	± 5°	UNITS	mm	NAME (INTENDED USE)	MINTRON CO., LTD.
X	± 0.20	X°	± 2°	MATL			
XX	± 0.10	XX°	± 1°	FINISH		PART NO. (INTENDED USE)	TITLE: 1.27*2.54 IDC SOCKET+SR
.XXX ± 0.05	.XXX° ± 0.5°			QTY		APPD: SUNNY	DWG NO.: MTFC42-XXXX
IDC SOCKET CONNECTOR						CHKD: USA	SCALE SHEET REV. 1/1 1/1 A
						DR: ZOE	

