



PUSH SWITCH

MPS11 SERIES



SPECIFICATION

Rating:16A 125VAC (UL,CSA)

10A 250VAC (UL,CSA)

TV-5(UL,CSA)

16A 250VAC(CQC)

5/80A 250V~μT85(ENEC10,VDE,NEMKO,CQC)

INITIAL CONTACT RESISTANCE:20mΩ Max

OPERATION FORCE:500±200gf

INSULATION RESISTANCE:100mΩ MIN 500VDC

WITHSTAND VOLTAGE:1000VAC FOR 1MINUTE

ENDURANCE:10,000 CYCLES

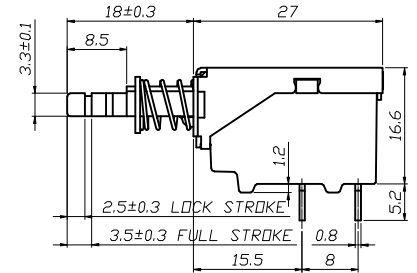
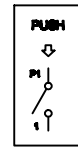
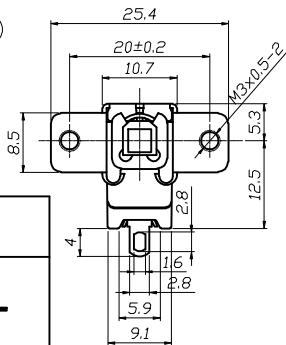

TERMINAL TYPE	
S	STANDARD TERMINAL SOLDERING TYPE
C	PCB. TYPE
L	LONG TERMINAL SOLDERING TYPE

Terminal List

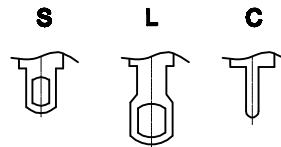

MPS11 SERIES ORDERING SYSTEM

MPS11 - M S 1 8 O - M 3 - R

MODEL NO.

BRACKET TYPE			
M	SCREW TYPE M3x0.5	H	HOLE TYPE Ø3.2
N	SCREW+PCB TYPE M3x0.5	F	HOLE TYPE Ø3.5
P	PCB. TYPE	J	SCREW TYPE M3x0.5/8A ONLY
I	HOLE+PCB TYPE Ø3.2		

ACTUATOR LENGTH	
18	18mm
15	14.5mm
11	11mm

OPERATING CODE	
M	MOMENTARY
	PUSH LOCK

RoHS DIRECTIVE	
R	MEET RoHS DIRECTIVE
	NONE

ACTUATOR COLOR	
O	ORANGE

OPERATING FORCE	
	500±200gf
3	400±150gf

TERMINAL TYPE	
S	STANDARD TERMINAL SOLDERING TYPE
C	PCB. TYPE
L	LONG TERMINAL SOLDERING TYPE