

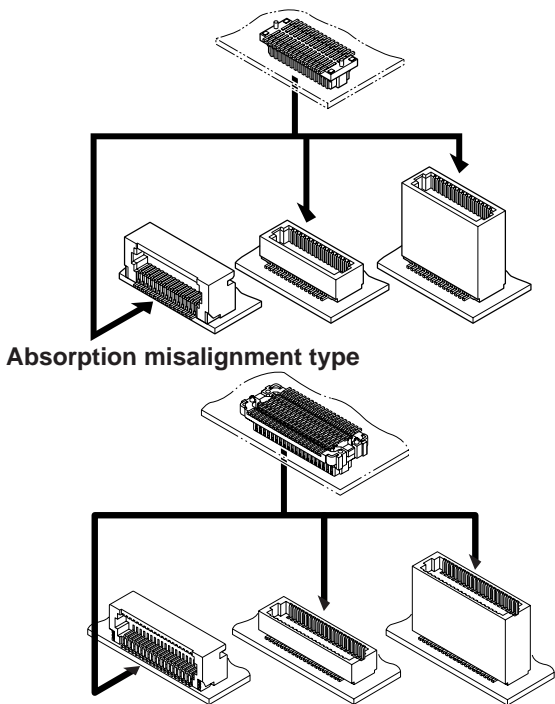

JMC CONNECTOR

0.5mm pitch/Board-to-board connectors



- **Secure mating**
- **Distortion preventive construction**
- **Versatile number of circuit and height**
- **Absorbing misalignment when mating connector**

Specifications

- Current rating: 0.5 A AC, DC
- Voltage rating: 50 V AC, DC
- Temperature range: -25°C to +85°C
(including temperature rise in applying electrical current)
- Contact resistance: Initial value/ 50 mΩ max.
After environmental tests/ 100 mΩ max.
- Insulation resistance: 50 MΩ min.
- Withstanding voltage: 100 VAC/minute
- * Contact JST for nitrogen (N₂) reflow soldering.
- * Refer to "General Instruction and Notice when using Terminals and Connectors" at the end of this catalog.
- * Contact JST for details.
- * Compliant with RoHS.

This JMC connector is 0.5 mm pitch SMT type board to board connector with selection of boss existence. Comparing with conventional JMC connector, more small and space saving are realized. Various types are available such as top/side entry type connectors including the development of the stacking height variation for plug and the absorption misalignment type for receptacle.

Standards

- ♻️ Recognized E60389
- Ⓢ Certified LR20812

PC board layout and Assembly layout

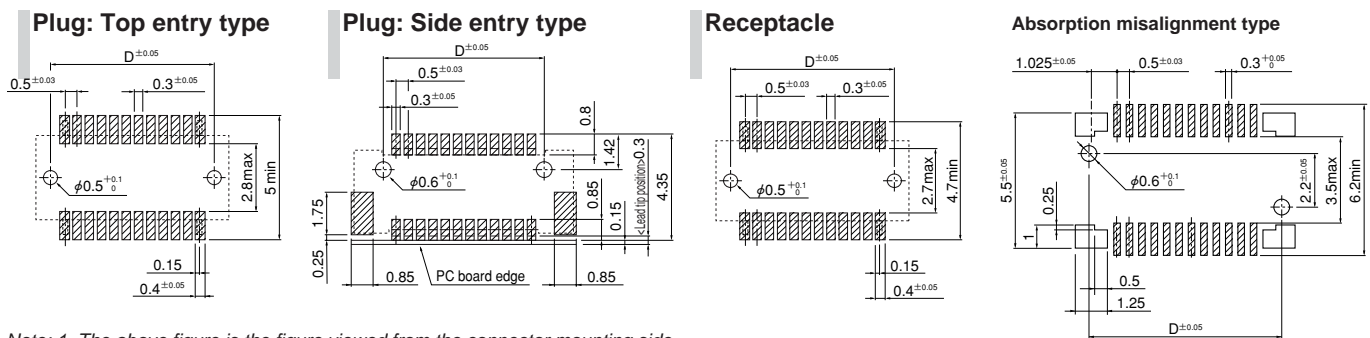

Note: 1. The above figure is the figure viewed from the connector mounting side.
2. Tolerances are non-cumulative: ±0.03 mm for all centers. The dimensions above should serve as a guideline. Contact JST for details.

Top entry type

Stacking height: 3.0 to 10.0 mm

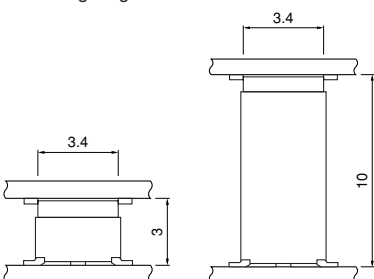

Absorption misalignment type

Stacking height: 4.0 to 11.0 mm

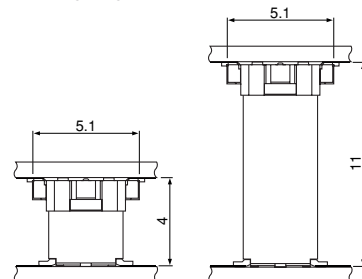

Side entry type

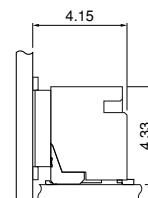

Absorption misalignment type

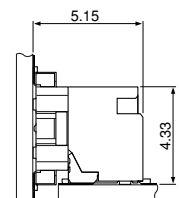

JMC CONNECTOR

Plug

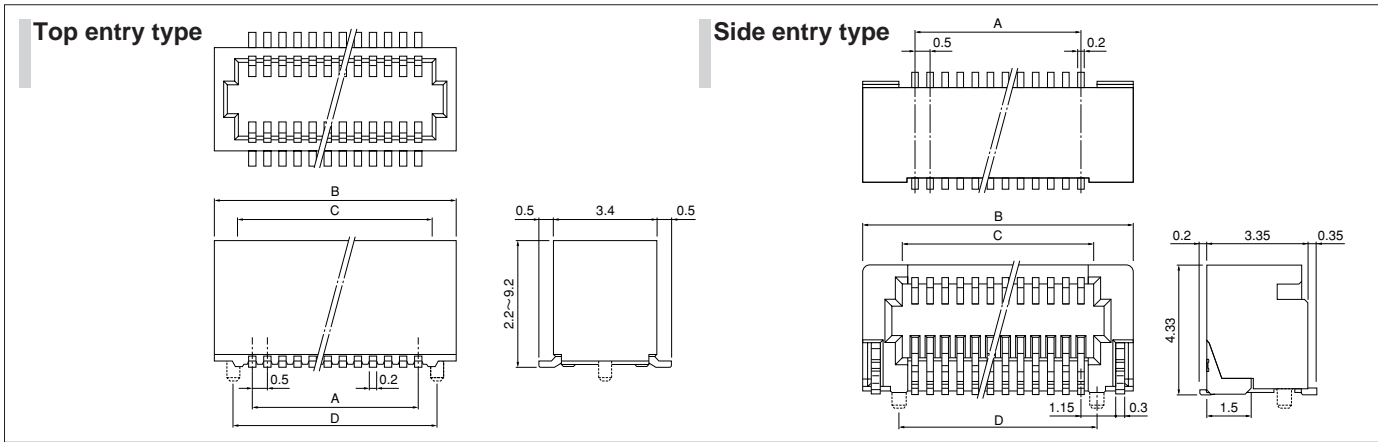

Top entry type

| | Circuits | Model No. Stacking height (mm) | | | | Dimensions (mm) | | | |
|--------------|-----------|-----------------------------------|-----------------------|-----------------------|-----------------------|-----------------|------|------|------|
| | | 3.0 | 3.5 | 4.0 | 4.5 | A | B | C | D |
| Without boss | 18 | 18P3.0-JMCS-G-TF(N) | — | — | — | 4.0 | 6.4 | 4.9 | — |
| | 20 | 20P3.0-JMCS-G-TF(N) | 20P3.5-JMCS-G-TF(N) | — | 20P4.5-JMCS-G-TF(N) | 4.5 | 6.9 | 5.4 | — |
| | 24 | — | 24P3.5-JMCS-G-TF(N) | — | — | 5.5 | 7.9 | 6.4 | — |
| | 30 | 30P3.0-JMCS-G-TF(N) | 30P3.5-JMCS-G-TF(N) | 30P4.0-JMCS-G-TF(N) | — | 7.0 | 9.4 | 7.9 | — |
| | 40 | 40P3.0-JMCS-G-TF(N) | 40P3.5-JMCS-G-TF(N) | 40P4.0-JMCS-G-TF(N) | — | 9.5 | 11.9 | 10.4 | — |
| | 50 | 50P3.0-JMCS-G-TF(N) | — | 50P4.0-JMCS-G-TF(N) | — | 12.0 | 14.4 | 12.9 | — |
| With boss | 60 | 60P3.0-JMCS-G-TF(N) | — | 60P4.0-JMCS-G-TF(N) | — | 14.5 | 16.9 | 15.4 | — |
| | 20 | 20P3.0-JMCS-G-B-TF(N) | 20P3.5-JMCS-G-B-TF(N) | — | 20P4.5-JMCS-G-B-TF(N) | 4.5 | 6.9 | 5.4 | 5.7 |
| | 24 | — | — | 24P4.0-JMCS-G-B-TF(N) | — | 5.5 | 7.9 | 6.4 | 6.7 |
| | 30 | — | 30P3.5-JMCS-G-B-TF(N) | 30P4.0-JMCS-G-B-TF(N) | — | 7.0 | 9.4 | 7.9 | 8.2 |
| | 40 | 40P3.0-JMCS-G-B-TF(N) | 40P3.5-JMCS-G-B-TF(N) | 40P4.0-JMCS-G-B-TF(N) | — | 9.5 | 11.9 | 10.4 | 10.7 |
| | 44 | 44P3.0-JMCS-G-B-TF(N) | — | — | — | 10.5 | 12.9 | 11.4 | 11.7 |
| | 50 | 50P3.0-JMCS-G-B-TF(N) | — | 50P4.0-JMCS-G-B-TF(N) | — | 12.0 | 14.4 | 12.9 | 13.2 |
| | 60 | 60P3.0-JMCS-G-B-TF(N) | — | 60P4.0-JMCS-G-B-TF(N) | — | 14.5 | 16.9 | 15.4 | 15.7 |
| | Q'ty/reel | 2,500 | 2,000 | 2,000 | 1,500 | | | | |

| | Circuits | Model No. Stacking height (mm) | | | | Dimensions (mm) | | | |
|--------------|-----------|-----------------------------------|-----------------------|-----------------------|-----------------------|-----------------|------|------|------|
| | | 5.0 | 5.5 | 6.0 | 6.5 | A | B | C | D |
| Without boss | 14 | 14P5.0-JMCS-G-TF(N) | — | — | — | 3.0 | 5.4 | 3.9 | — |
| | 20 | 20P5.0-JMCS-G-TF(N) | 20P5.5-JMCS-G-TF(N) | 20P6.0-JMCS-G-TF(N) | — | 4.5 | 6.9 | 5.4 | — |
| | 30 | — | — | — | 30P6.5-JMCS-G-TF(N) | 7.0 | 9.4 | 7.9 | — |
| | 40 | 40P5.0-JMCS-G-TF(N) | — | — | 40P6.5-JMCS-G-TF(N) | 9.5 | 11.9 | 10.4 | — |
| | 50 | 50P5.0-JMCS-G-TF(N) | — | — | — | 12.0 | 14.4 | 12.9 | — |
| | 60 | — | 60P5.5-JMCS-G-TF(N) | — | — | 14.5 | 16.9 | 15.4 | — |
| With boss | 14 | 14P5.0-JMCS-G-B-TF(N) | — | — | — | 3.0 | 5.4 | 3.9 | 4.2 |
| | 20 | 20P5.0-JMCS-G-B-TF(N) | 20P5.5-JMCS-G-B-TF(N) | 20P6.0-JMCS-G-B-TF(N) | — | 4.5 | 6.9 | 5.4 | 5.7 |
| | 30 | 30P5.0-JMCS-G-B-TF(N) | — | — | 30P6.5-JMCS-G-B-TF(N) | 7.0 | 9.4 | 7.9 | 8.2 |
| | 40 | 40P5.0-JMCS-G-B-TF(N) | — | 40P6.0-JMCS-G-B-TF(N) | 40P6.5-JMCS-G-B-TF(N) | 9.5 | 11.9 | 10.4 | 10.7 |
| | 50 | 50P5.0-JMCS-G-B-TF(N) | — | 60P6.0-JMCS-G-B-TF(N) | — | 14.5 | 16.9 | 15.4 | 15.7 |
| | 60 | — | — | — | — | — | — | — | — |
| | Q'ty/reel | 1,500 | 1,000 | 1,000 | 1,000 | | | | |

| | Circuits | Model No. Stacking height (mm) | | | | Dimensions (mm) | | | |
|--------------|-----------|-----------------------------------|-----------------------|-----------------------|-----------------------|-----------------|------|------|------|
| | | 7.0 | 7.5 | 8.0 | 8.5 | A | B | C | D |
| Without boss | 20 | 20P7.0-JMCS-G-TF(N) | — | — | — | 4.5 | 6.9 | 5.4 | — |
| | 50 | 50P7.0-JMCS-G-TF(N) | — | — | — | 12.0 | 14.4 | 12.9 | — |
| With boss | 34 | — | — | — | 34P8.5-JMCS-G-B-TF(N) | 8.0 | 10.4 | 8.9 | 9.2 |
| | 50 | 50P7.0-JMCS-G-B-TF(N) | 50P7.5-JMCS-G-B-TF(N) | 50P8.0-JMCS-G-B-TF(N) | — | 12.0 | 14.4 | 12.9 | 13.2 |
| | 64 | — | — | 64P8.0-JMCS-G-B-TF(N) | — | 15.5 | 17.9 | 16.4 | 16.7 |
| | Q'ty/reel | 1,000 | 600 | 600 | 500 | | | | |

| | Circuits | Model No. Stacking height (mm) | | | | Dimensions (mm) | | | |
|--------------|-----------|-----------------------------------|------------------------|---|---|-----------------|------|------|------|
| | | 9.0 | 10.0 | — | — | A | B | C | D |
| Without boss | 20 | — | 20P10.0-JMCS-G-TF(N) | — | — | 4.5 | 6.9 | 5.4 | — |
| | 30 | 30P9.0-JMCS-G-TF(N) | — | — | — | 7.0 | 9.4 | 7.9 | — |
| | 50 | 50P9.0-JMCS-G-TF(N) | — | — | — | 12.0 | 14.4 | 12.9 | — |
| With boss | 20 | — | 20P10.0-JMCS-G-B-TF(N) | — | — | 4.5 | 6.9 | 5.4 | 5.7 |
| | 30 | 30P9.0-JMCS-G-B-TF(N) | — | — | — | 7.0 | 9.4 | 7.9 | 8.2 |
| | 40 | 40P9.0-JMCS-G-B-TF(N) | 40P10.0-JMCS-G-B-TF(N) | — | — | 9.5 | 11.9 | 10.4 | 10.7 |
| | 50 | 50P9.0-JMCS-G-B-TF(N) | — | — | — | 12.0 | 14.4 | 12.9 | 13.2 |
| | 60 | 60P9.0-JMCS-G-B-TF(N) | — | — | — | 14.5 | 16.9 | 15.4 | 15.7 |
| | Q'ty/reel | 500 | 500 | — | — | | | | |

RoHS compliance

- Note: 1. The stacking height of absorption misalignment type is 1.0 mm higher than that of standard type.
 2. As for the overall gold plated product, "(N)" is not given to the end of model No.
 3. The products listed above are supplied on embossed-tape.

JMC CONNECTOR

Plug

Side entry type

| | Circuits | Model No. | Dimensions (mm) | | | | Q'ty/ reel |
|--------------|----------|----------------------|-----------------|------|------|-------|---------------|
| | | | A | B | C | D | |
| Without boss | 20 | 20PS-JMCS-G-1-TF(N) | 4.5 | 7.9 | 5.4 | — | 1,500 |
| | 24 | 24PS-JMCS-G-1-TF(N) | 5.5 | 8.9 | 6.4 | — | 1,500 |
| | 30 | 30PS-JMCS-G-1-TF(N) | 7.0 | 10.4 | 7.9 | — | 1,500 |
| | 34 | 34PS-JMCS-G-1-TF(N) | 8.0 | 11.4 | 8.9 | — | 1,500 |
| | 40 | 40PS-JMCS-G-1-TF(N) | 9.5 | 12.9 | 10.4 | — | 1,500 |
| | 50 | 50PS-JMCS-G-1-TF(N) | 12.0 | 15.4 | 12.9 | — | 1,500 |
| With boss | 20 | 20PS-JMCS-G-1B-TF(N) | 4.5 | 7.9 | 5.4 | 5.55 | 1,500 |
| | 24 | 24PS-JMCS-G-1B-TF(N) | 5.5 | 8.9 | 6.4 | 6.55 | 1,500 |
| | 30 | 30PS-JMCS-G-1B-TF(N) | 7.0 | 10.4 | 7.9 | 8.05 | 1,500 |
| | 34 | 34PS-JMCS-G-1B-TF(N) | 8.0 | 11.4 | 8.9 | 9.05 | 1,500 |
| | 40 | 40PS-JMCS-G-1B-TF(N) | 9.5 | 12.9 | 10.4 | 10.55 | 1,500 |
| | 50 | 50PS-JMCS-G-1B-TF(N) | 12.0 | 15.4 | 12.9 | 13.05 | 1,500 |
| | 60 | 60PS-JMCS-G-1B-TF(N) | 14.5 | 17.9 | 15.4 | 15.55 | 1,500 |

Material and Finish

Contact: Phosphor bronze, nickel-undercoated, gold-plated (nickel-stripe)
Housing: PA 6T, UL94V-0
Solder tab: Brass, tin-plated (reflow treatment)

RoHS compliance This product displays (LF)(SN) on a label.

Note: 1. The products listed above are supplied on embossed-tape.

2. As for the overall gold plated product, "(N)" is not given to the end of model No.

Receptacle

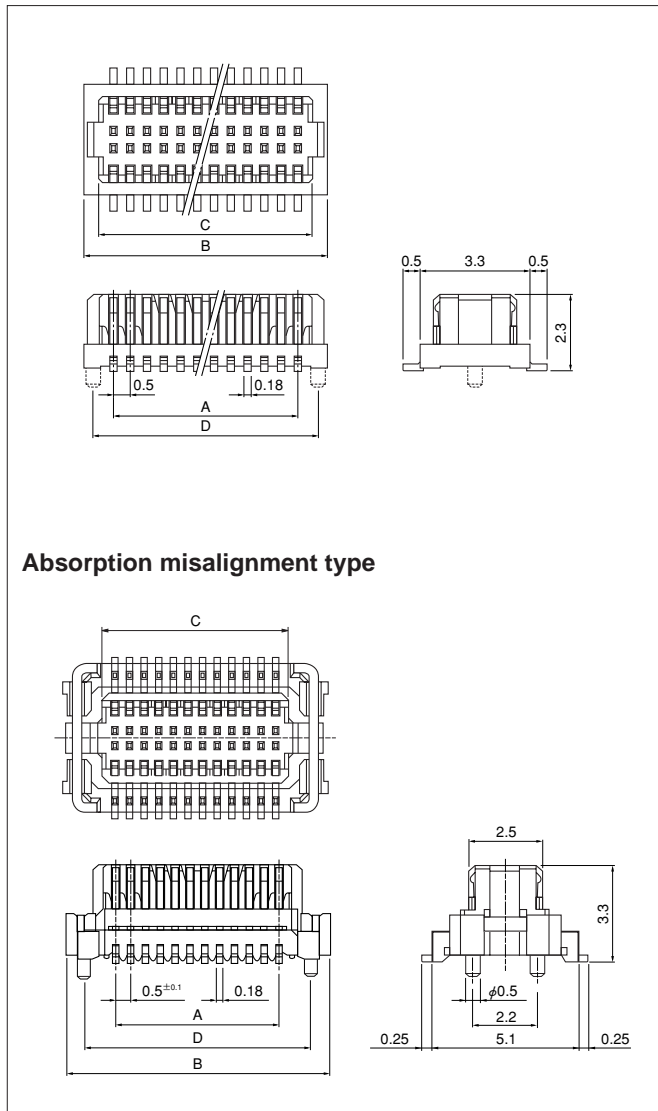

| Circuits | Model No. | | Dimensions (mm) | | | | Q'ty/ reel |
|----------|---------------------|-----------------------|-----------------|------|------|------|---------------|
| | Without boss | With boss | A | B | C | D | |
| 14 | 14R-JMCS-G-TF (NSA) | 14R-JMCS-G-B-TF (NSA) | 3.0 | 4.8 | 3.9 | 4.2 | 2,500 |
| 18 | 18R-JMCS-G-TF (NSA) | — | 4.0 | 5.8 | 4.9 | 5.2 | 2,500 |
| 20 | 20R-JMCS-G-TF (NSA) | 20R-JMCS-G-B-TF (NSA) | 4.5 | 6.3 | 5.4 | 5.7 | 2,500 |
| 24 | 24R-JMCS-G-TF (NSA) | 24R-JMCS-G-B-TF (NSA) | 5.5 | 7.3 | 6.4 | 6.7 | 2,500 |
| 30 | 30R-JMCS-G-TF (NSA) | 30R-JMCS-G-B-TF (NSA) | 7.0 | 8.8 | 7.9 | 8.2 | 2,500 |
| 34 | 34R-JMCS-G-TF (NSA) | 34R-JMCS-G-B-TF (NSA) | 8.0 | 9.8 | 8.9 | 9.2 | 2,500 |
| 40 | 40R-JMCS-G-TF (NSA) | 40R-JMCS-G-B-TF (NSA) | 9.5 | 11.3 | 10.4 | 10.7 | 2,500 |
| 46 | 46R-JMCS-G-TF (NSA) | 46R-JMCS-G-B-TF (NSA) | 11.0 | 12.8 | 11.9 | 12.2 | 2,500 |
| 50 | 50R-JMCS-G-TF (NSA) | 50R-JMCS-G-B-TF (NSA) | 12.0 | 13.8 | 12.9 | 13.2 | 2,500 |
| 60 | 60R-JMCS-G-TF (NSA) | 60R-JMCS-G-B-TF (NSA) | 14.5 | 16.3 | 15.4 | 15.7 | 2,500 |

Material and Finish

Contact: Phosphor bronze, nickel-undercoated, gold-plated (nickel-stripe)
Housing: PA 6T, UL94V-0

RoHS compliance

Note: 1. The products listed above are supplied on embossed-tape.

2. As for the overall gold plated product, "(S)" instead of "(NSA)" shall be given to the end of model No.

Absorption misalignment type

| Circuits | Model No. | | Dimensions (mm) | | | | Q'ty/ reel |
|----------|---------------------|----------------------|-----------------|------|------|-------|---------------|
| | Without boss | With boss | A | B | C | D | |
| 20 | 20RF-JMCS-G-1-TF(N) | 20RF-JMCS-G-1B-TF(N) | 4.5 | 8.0 | 5.4 | 6.75 | 1,000 |
| 30 | 30RF-JMCS-G-1-TF(N) | 30RF-JMCS-G-1B-TF(N) | 7.0 | 10.5 | 7.9 | 9.25 | 1,000 |
| 40 | 40RF-JMCS-G-1-TF(N) | 40RF-JMCS-G-1B-TF(N) | 9.5 | 13.0 | 10.4 | 11.75 | 1,000 |
| 44 | — | 44RF-JMCS-G-1B-TF(N) | 10.5 | 14.0 | 11.4 | 12.75 | 1,000 |
| 50 | 50RF-JMCS-G-1-TF(N) | 50RF-JMCS-G-1B-TF(N) | 12.0 | 15.5 | 12.9 | 14.25 | 1,000 |
| 60 | 60RF-JMCS-G-1-TF(N) | 60RF-JMCS-G-1B-TF(N) | 14.5 | 18.0 | 15.4 | 16.75 | 1,000 |
| 64 | — | 64RF-JMCS-G-1B-TF(N) | 15.5 | 19.0 | 16.4 | 17.75 | 1,000 |

Material and Finish

Contact: Phosphor bronze, nickel-undercoated, gold-plated (nickel-stripe)
Housing: PA 6T, UL94V-0
Solder tab: Brass, copper-undercoated, tin-plated (reflow treatment)

RoHS compliance This product displays (LF)(SN) on a label.

Note: 1. The products listed above are supplied on embossed-tape.

2. Not CSA approved.