

## SPECIFICATIONS

Rated(额定参数): 300V,1.5A  
 Dielectric strength(抗电强度): AC2000V/1 Minute  
 Insulation Resistance(绝缘电阻):1000MΩ Min  
 Contact Resistance(接触电阻):20mΩ Max  
 Temp. range(操作温度): -40℃~+105℃  
 MAX Soldering(瞬时温度):+250℃,5s

Housing Material(塑件): PA66 (UL94 V-0)  
 Contact(端子): Brass, Tin plating(黄铜镀锡)

PITCH RANGE		NOMINAL DIMENSION RANGE					
IN MM		IN MM		IN MM		IN MM	
OVER	TO	OVER	TO	OVER	TO	OVER	TO
6	10	10	24	30	60	100	150
±0.10	±0.15	±0.25	±0.30	±0.30	±0.50	±0.70	±1.00

## Ordering Information

JL2EDGVC-XXX GX 1

Pitch  
 500=5.00PH  
 508=5.08PH

No.of pins  
 2P~24P

Housing Color  
 B=Black  
 G=Green  
 U=Blue  
 R=Red  
 W=White  
 Y=Yellow  
 O=Orange  
 E=Grey

Packing  
 O=Pe bog  
 A=Troy  
 T=Tube

Recommended P.C.B Layout(Top Side)

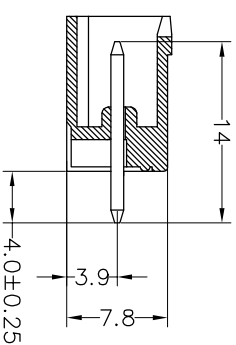
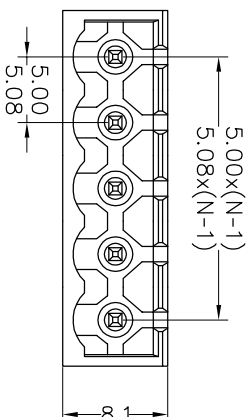
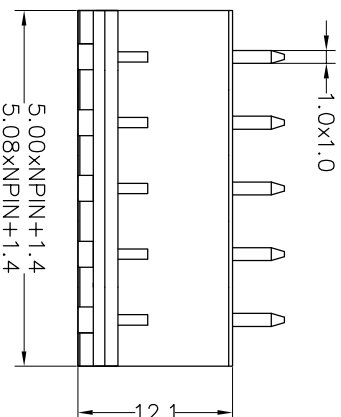
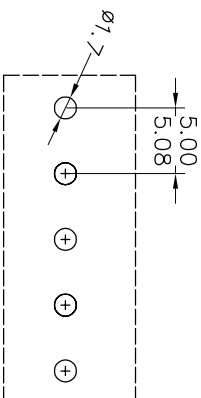

OPERATION		DRAW		SCALE		FIT		PART NO.	
XX	±0.30	yy	yusheng	UNIT	mm	1/1	A4	JL2EDGVC-500(508)XXGX1	5.00/5.08mm Pitch Male Pluggable Terminal Blocks
X:XX	±0.20	CHECK		SIZE	A4	SHEET	1/1	TITLE:	
X:XXX	±0.10	APPROVE		PROU.					
Angle	±3°								
DIM	TOL								
CHANGE									
MODIFICATION DESCRIPTION									
NEW DRAWING									
DATE									
2018.12.24									
REV									
A0									

**JILIN** 深圳市锦凌电子有限公司  
 SHENZHEN JINLING ELECTRONIC CO.,LTD  
 Tel: 86-755-2997-5806/5802 Fax: 86-755-2997-5992