

SPECIFICATIONS

Rated(额定参数): 300V,1.5A
 Dielectric strength(抗电强度): AC2000V/1 Minute
 Insulation Resistance(绝缘电阻):1000MΩ Min
 Contact Resistance(接触电阻):20mΩ Max
 Temp. range(操作温度): -40℃~+105℃
 MAX Soldering(瞬时温度):+250℃,5s

Housing Material(塑件): PA66 (UL94 V-0)
 Nut(螺母): Brass (黄铜)
 Contact(端子): Brass, Tin plating(黄铜镀锡)

PITCH RANGE IN MM	NOMINAL DIMENSION RANGE IN MM				
	OVER	OVER	OVER	OVER	OVER
TO 6	10	TO 30	60	100	OVER 150
TO 10	TO 24	TO 60	TO 100	TO 150	TO 150
±0.10	±0.15	±0.25	±0.30	±0.50	±0.70
					±1.00

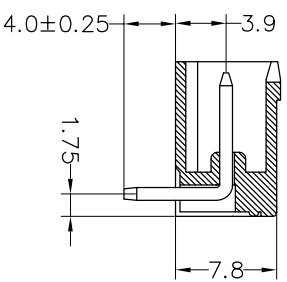
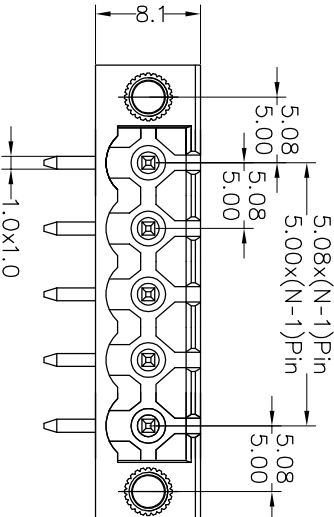
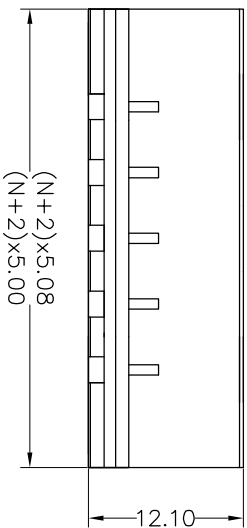

Ordering Information

JL2EDGRM - XXX XX G X 1

Pitch
 500=5.00PH
 508=5.08PH

No.of pins
 2P~24P

Housing Color
 B=Black
 G=Green
 U=Blue
 R=Red
 W=White
 Y=Yellow
 O=Orange
 F=Grey

Packing
 0=Pe bog
 T=Tube
 A=Troy

Recommended P.C.B Layout(Top Side)

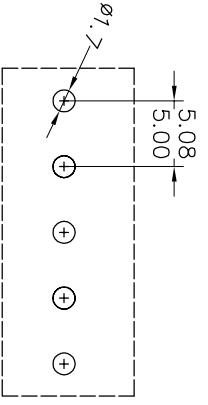

REV	DATE	MODIFICATION DESCRIPTION	CHANGE	DIM	TOL	APPROVE	SCALE	FIT	PART NO.	TITLE:
A0	2018.12.24	NEW DRAWING		Angle	±3°	CHECK	UNIT	mm	JL2EDGRM-500(508)XXGX1	5.00/5.08mm Pitch Male Pluggable Terminal Blocks
1							SIZE	A4		
OPERATION							DRAW	yiyusheng	18.12.24	
DIM										
TOL										
APPROVE										
PRU.										
SHEET										
SHEET										
PROU.										
SCALE										
FIT										
UNIT										
SIZE										
SHEET										
SHEET										
PROU.										
PART NO.										
TITLE:										

JILIN 深圳市锦凌电子有限公司
 SHENZHEN JINLING ELECTRONIC CO.,LTD
 Tel: 86-755-2997-5806/5802 Fax: 86-755-2997-5992