

**SPECIFICATIONS**

Rated(额定参数): 300V,1.5A  
 Dielectric strength(抗电强度): AC2000V/1 Minute  
 Insulation Resistance(绝缘电阻):1000MΩ Min  
 Contact Resistance(接触电阻):20mΩ Max  
 Temp. range(操作温度): -40℃~+105℃  
 MAX Soldering(瞬时温度):+250℃,5s

Housing Material(塑件): PA66 (UL94 V-0)  
 Contact(端子): Brass, Tin plating(黄铜镀锡)

PITCH RANGE IN MM	NOMINAL DIMENSION RANGE IN MM					
	OVER TO	OVER TO	OVER TO	OVER TO	OVER TO	OVER TO
6	6	10	30	60	100	150
10	10	24	30	60	100	150
±0.10	±0.15	±0.25	±0.30	±0.30	±0.50	±0.70 ±1.00

**Ordering Information**

**JL2EDGRC-XXX XX G X 1**

Pitch  
500=5.00PH  
508=5.08PH

No.of pins  
2P~24P

Housing Color  
B=Black  
G=Green  
U=Blue  
R=Red  
W=White  
O=Orange  
E=Grey

Packing  
0=Pe bag  
T=Tube  
A=Tray

Recommended P.C.B Layout(Top Side)

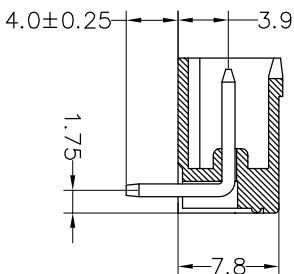
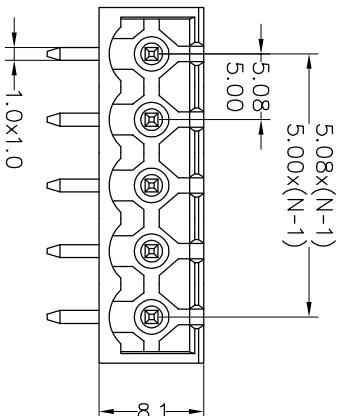
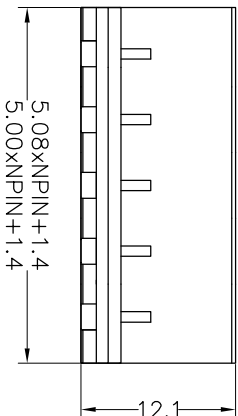
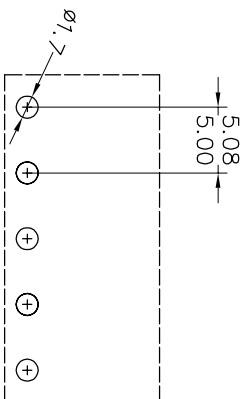

REV	DATE	MODIFICATION DESCRIPTION	CHANGE	OPERATION		DRAW	yiyusheng	18.12.24	SCALE	FIT	PART NO.	TITLE:
				DIM	TOL				UNIT	mm		
A0	2018.12.24	NEW DRAWING		X:XX	±0.30	CHECK		A4	1/1	JL2EDGRC-XXXXXXGX1	5.08/5.00mm Pitch Male Pluggable Terminal Blocks	
1				Angle	±3°	APPROVE						

**JIN** 深圳市锦凌电子有限公司  
 SHENZHEN JINLING ELECTRONIC CO.,LTD  
 Tel: 86-755-2997-5806/5802 Fax: 86-755-2997-5992