



# 晶体管 TRANSISTOR FHP13007A

## 主要参数 MAIN CHARACTERISTICS

Ic	8A
Vcbo	700V
Vceo	400V
Pc	80W

## 用途 APPLICATIONS

节能灯	Energy-saving light
电子镇流器	Electronic ballasts
高频开关电源	High frequency switching power supply
高频功率变换	High frequency power transform
一般功率放大电路	Commonly power amplifier circuit

## 封装形式 Package



TO-220

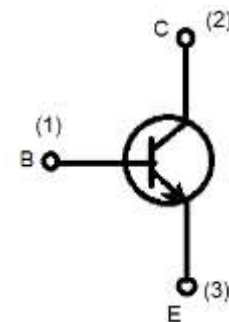

## 绝对最大额定值 ABSOLUTE RATINGS (Tc=25°C)

项目 Parameter	符号 Symbol	数值 Value	单位 Unit
集电极—基极直流电压 Collector- Base Voltage (IE=0)	Vcbo	700	V
集电极—发射极直流电压 Collector- Emitter Voltage (IB=0)	Vceo	400	V
发射极—基极直流电压 Emitter-Base Voltage (IC=0)	VEBO	9	V
最大集电极直流电流 Collector Current (DC)	Ic	8	A
最大集电极耗散功率 Total Dissipation (TO-92)	Pc	80	W
最高结温 Junction Temperature	Tj	150	°C
贮存温度 Storage Temperature	Tstg	-55~+150	°C

## 热特性 THERMAL CHARACTERISTIC

项目 Parameter	符号 Symbol	最小值 (min)	最大值 (max)	单位 Unit
结到环境的热阻 Thermal Resistance Junction Ambient	Rth(j-a)	-	125	°C/W

## 电特性 ELECTRICAL CHARACTERISTICS

项目 Parameter	测试条件 Tests conditions	最小值 (min)	典型值 (typ)	最大值 (max)	单位 Unit
$V(BR)_{CBO}$	$I_C=100\mu A, I_E=0$	700	-	-	V
$V(BR)_{CEO}$	$I_C=10mA, I_B=0$	400	-	-	V
$V(BR)_{EBO}$	$I_E=1mA, I_C=0$	9	-	-	V
$I_{CEO}$	$V_{CE}=400V, I_E=0$	-	-	300	$\mu A$
$I_{EBO}$	$V_{EB}=9V, I_C=0$	-	-	100	$\mu A$
$I_{CBO}$	$V_{CB}=700V, I_E=0$	-	-	100	$\mu A$
$H_{fe}(1)$	$V_{CE}=5V, I_C=2A$	15	-	40	
$H_{fe}(2)$	$V_{CE}=5V, I_C=5A$	5	-	-	
$V_{CE(sat)}$	$I_C=5A, I_B=1A$	-	-	1.0	V
$t_s$	$I_C=0.5A$	2	-	6	$\mu s$
$f_T$	$V_{CE}=10V, I_C=0.5A$	4	-	-	MHz

## 放大倍数 $h_{FE}$ Classifications

Classifications	H1	H2
$h_{FE} (1)$	15-28	26-39

特性曲线

Typical Performance Characteristics

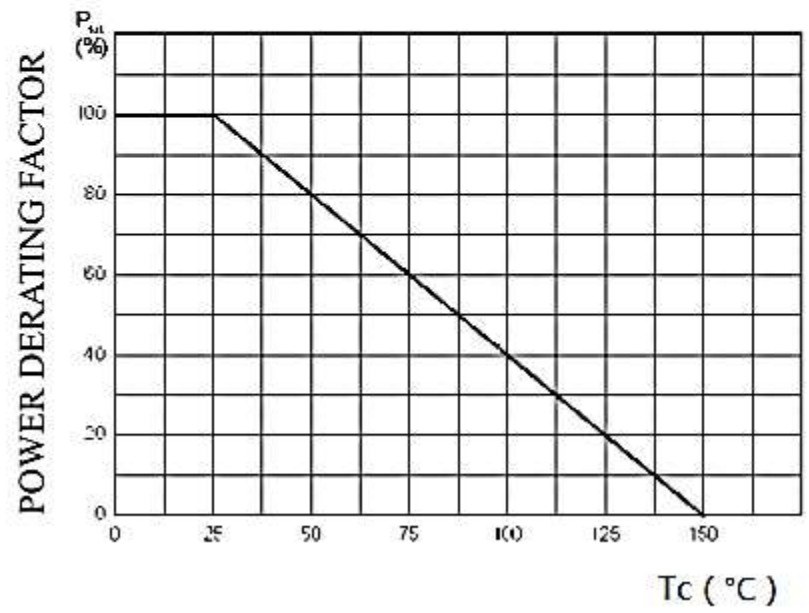
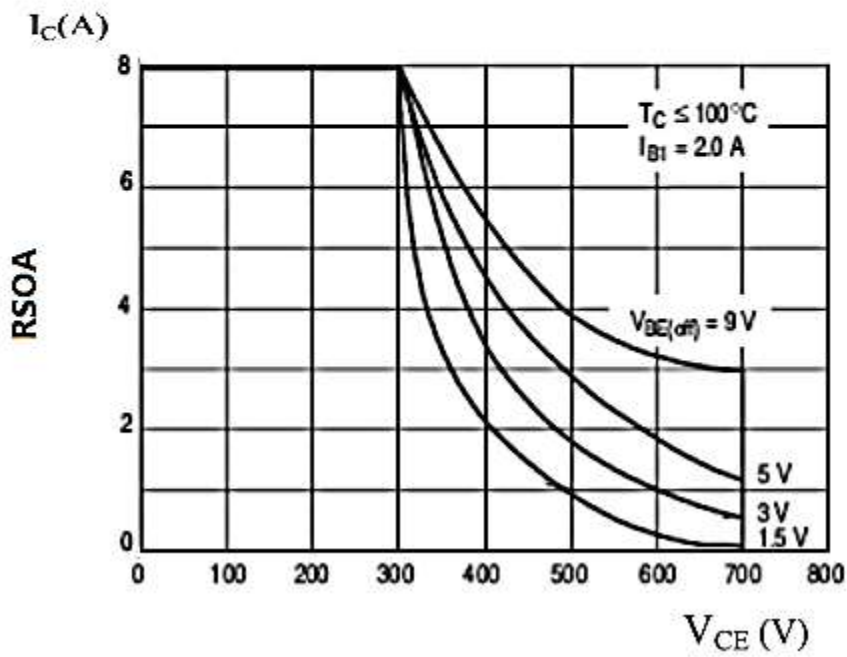
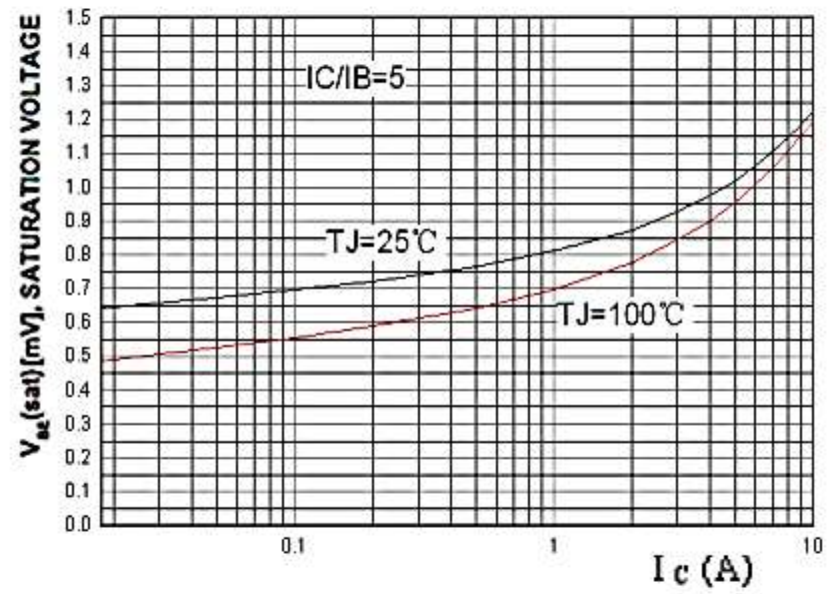
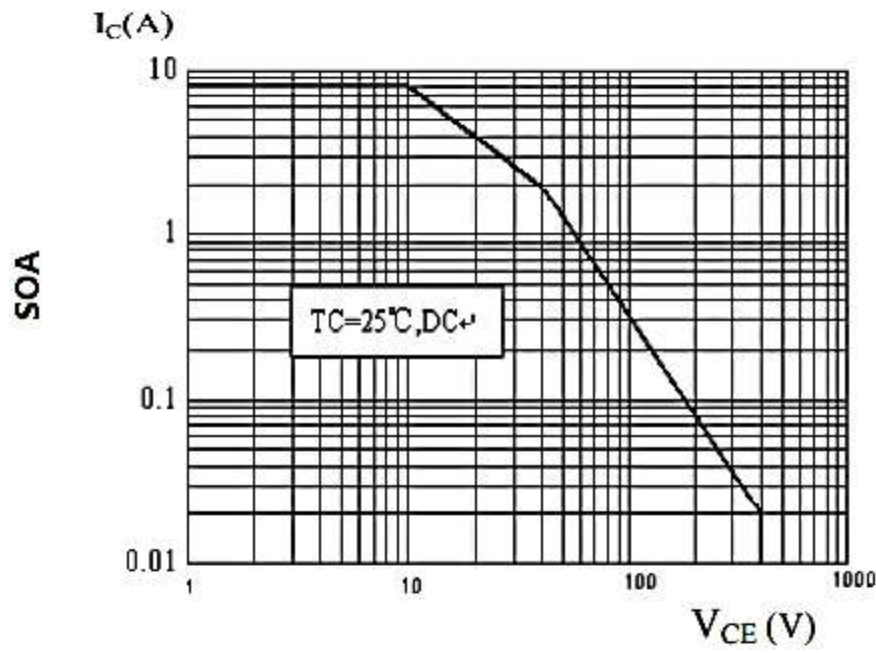
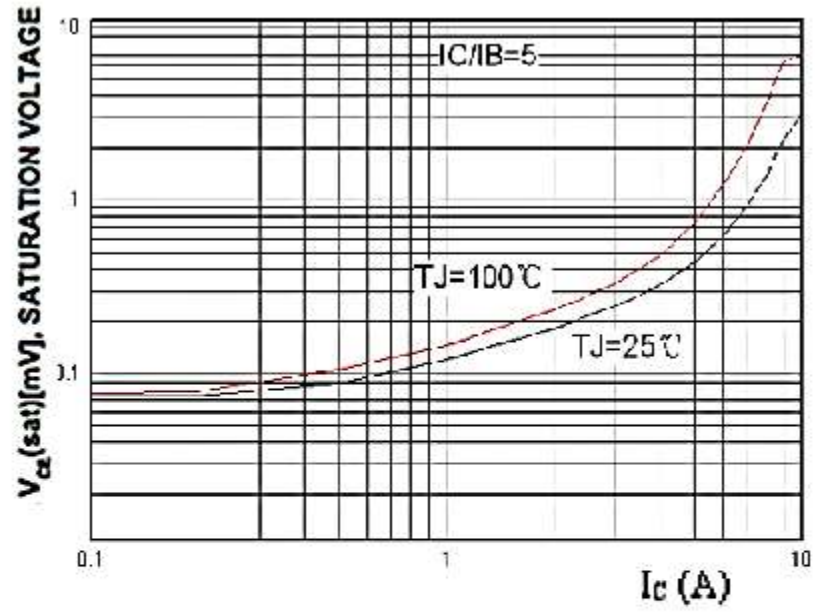
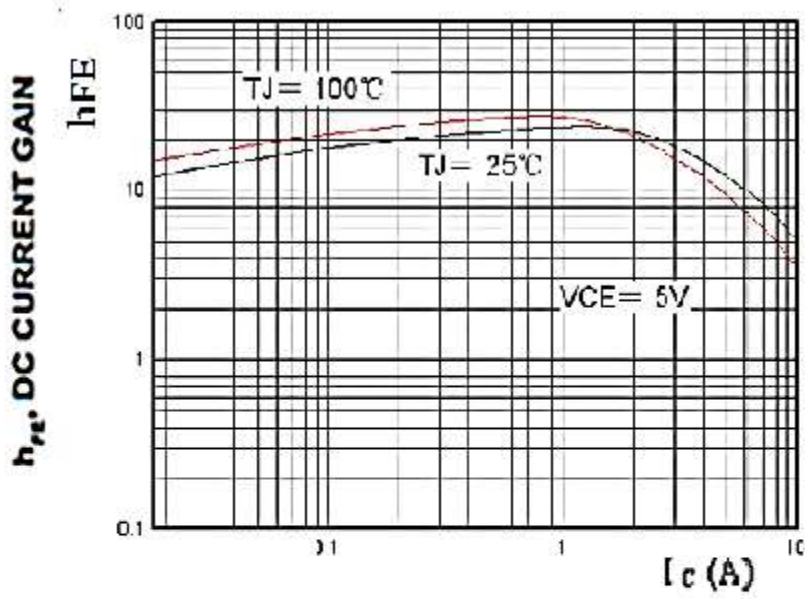

印记 Marking:

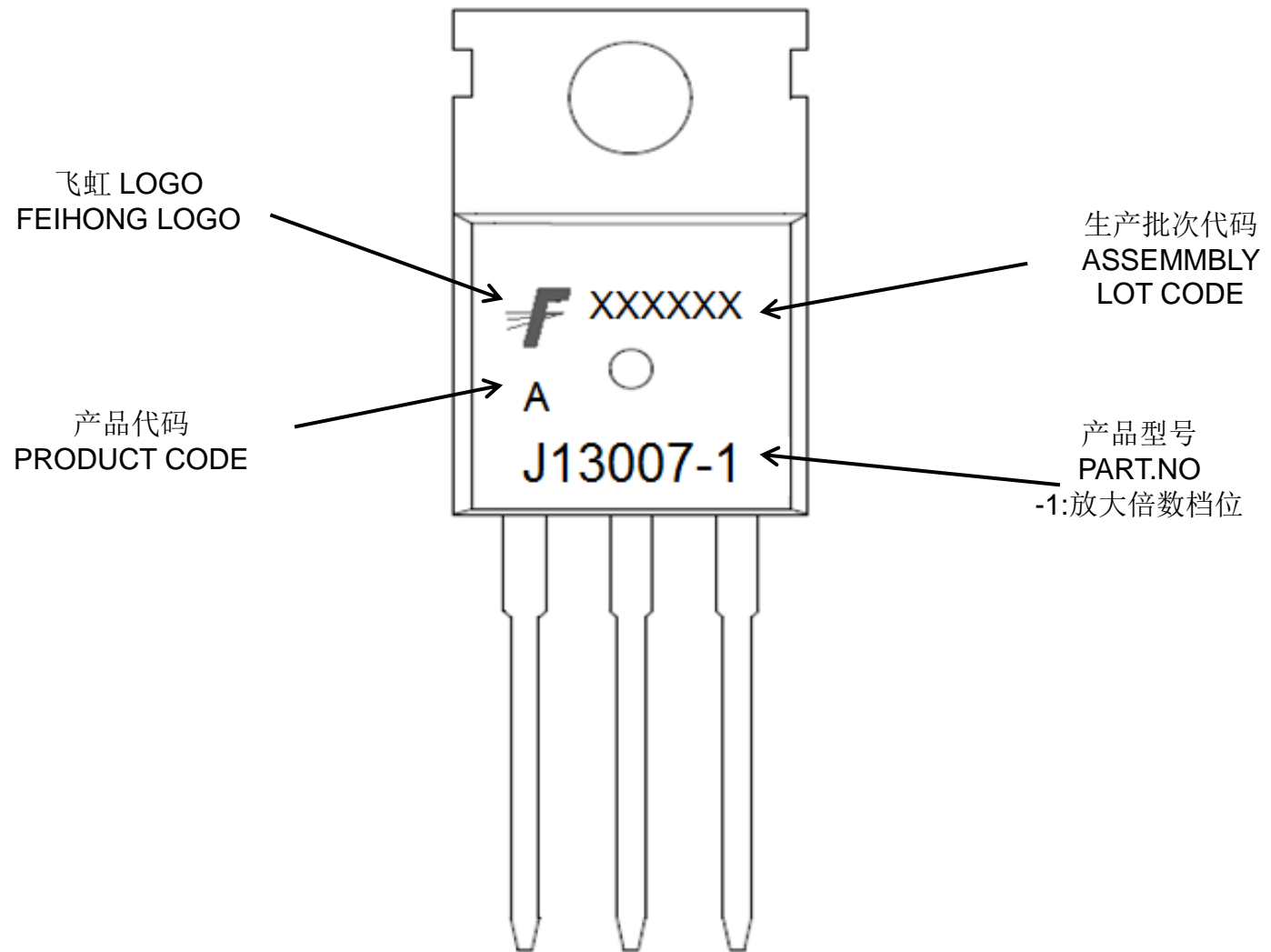

外形尺寸：  
Package Dimension:

TO-220

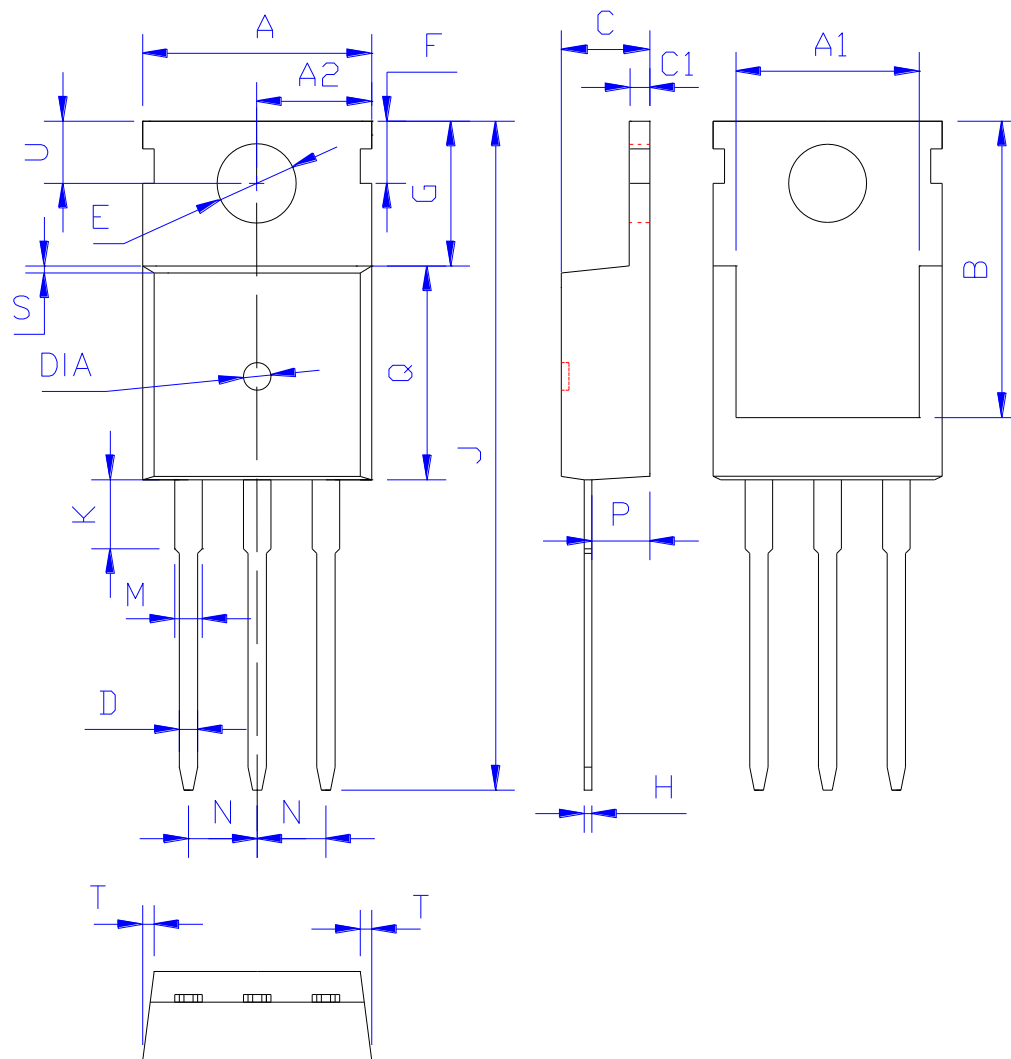

DIM	MILLIMETERS
A	10.00±0.30
A1	8.00±0.30
A2	5.00±0.30
B	13.20±0.40
C	4.50±0.20
C1	1.30±0.20
D	0.80±0.20
E	3.60±0.20
F	3.00±0.30
G	6.60±0.40
H	0.50±0.20
J	28.88±0.50
K	3.00±0.30
M	1.30±0.30
N	Typical 2.54
P	2.40±0.40
Q	9.20±0.40
S	0.25±0.15
T	0.25±0.15
U	2.80±0.30
DIA	宽 1.50±0.10 深 0.50 MAX

(Units: mm)