



**晶体管**  
**TRANSISTOR**  
**A940C**

**主要参数 MAIN CHARACTERISTICS**

I <sub>c</sub>	-1.5A
V <sub>CEO</sub>	-150V
P <sub>c</sub>	25W

**产品特性 FEATURES**

硅外延	Epitaxial silicon
高开关速度	High switching speed
RoHS 产品	RoHS product
与 C2073 互补	Complementary to C2073

**用途 APPLICATIONS**

高频开关电源	High frequency switch power supply
一般功率放大电路	Commonly power amplifier circuit
高频功率变换	High frequency power transform

**封装形式 Package**



**绝对最大额定值 ABSOLUTE RATINGS (T<sub>c</sub>=25°C)**

项目 Parameter	符号 Symbol	数值 Value	单位 Unit
集电极—基极直流电压 Collector- Base Voltage ( I <sub>E</sub> =0)	V <sub>CB0</sub>	-170	V
集电极—发射极直流电压 Collector- Emitter Voltage ( I <sub>B</sub> =0)	V <sub>CEO-</sub>	-150	V
发射极—基极直流电压 Emitter-Base Voltage ( I <sub>C</sub> =0)	V <sub>EB0</sub>	-7	V
最大集电极直流电流 Collector Current (DC)	I <sub>c</sub>	-1.5	A
最大集电极耗散功率 Total Dissipation (TO-92)	P <sub>c</sub>	25	W
最高结温 Junction Temperature	T <sub>j</sub>	150	°C
贮存温度 Storage Temperature	T <sub>stg</sub>	-55~+150	°C

---

## 电特性 ELECTRICAL CHARACTERISTICS

项目 Parameter	测试条件 Tests conditions	最小值 (min)	典型值 (typ)	最大值 (max)	单位 Unit
V(BR) <sub>CBO</sub>	I <sub>C</sub> =-100μA, I <sub>E</sub> =0	-170	-	-	V
V(BR) <sub>CEO</sub>	I <sub>C</sub> =-2mA, I <sub>B</sub> =0	-150	-	-	V
V(BR) <sub>EBO</sub>	I <sub>E</sub> =-100μA, I <sub>C</sub> =0	-7	-	-	V
I <sub>CBO</sub>	V <sub>CB</sub> =-180V, I <sub>E</sub> =0	-	-	-10	μA
I <sub>EBO</sub>	V <sub>EB</sub> =7V, I <sub>C</sub> =0	-	-	-10	μA
hFE(1)	V <sub>CE</sub> =-5V, I <sub>C</sub> =-0.5A	70	-	200	-
V <sub>CE(sat)</sub>	I <sub>C</sub> =-0.5A, I <sub>B</sub> =-0.05A	-	-	-1	V

## 典型特性曲线 Electrical Characteristics

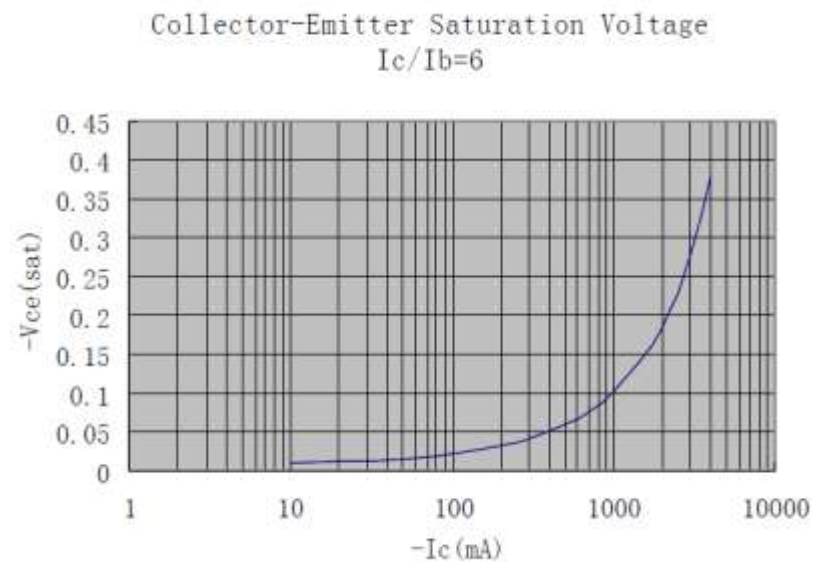
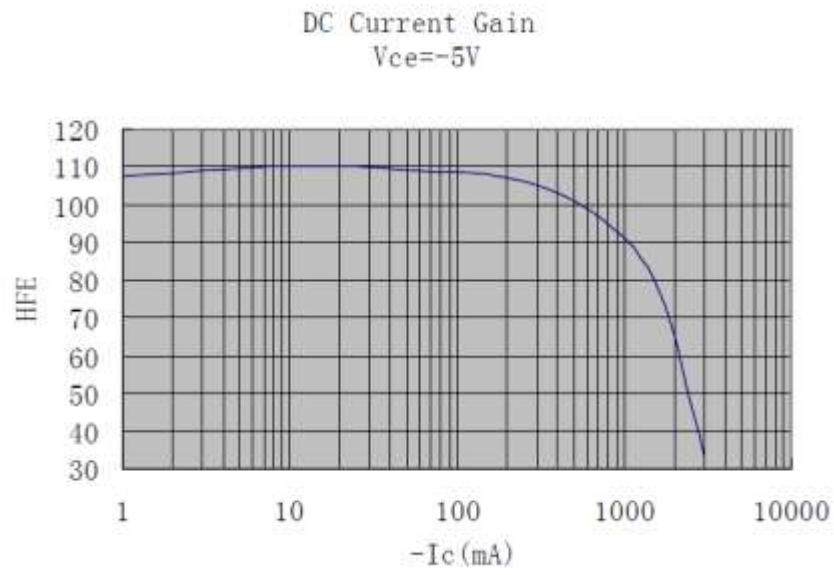

## 印记 Marking:

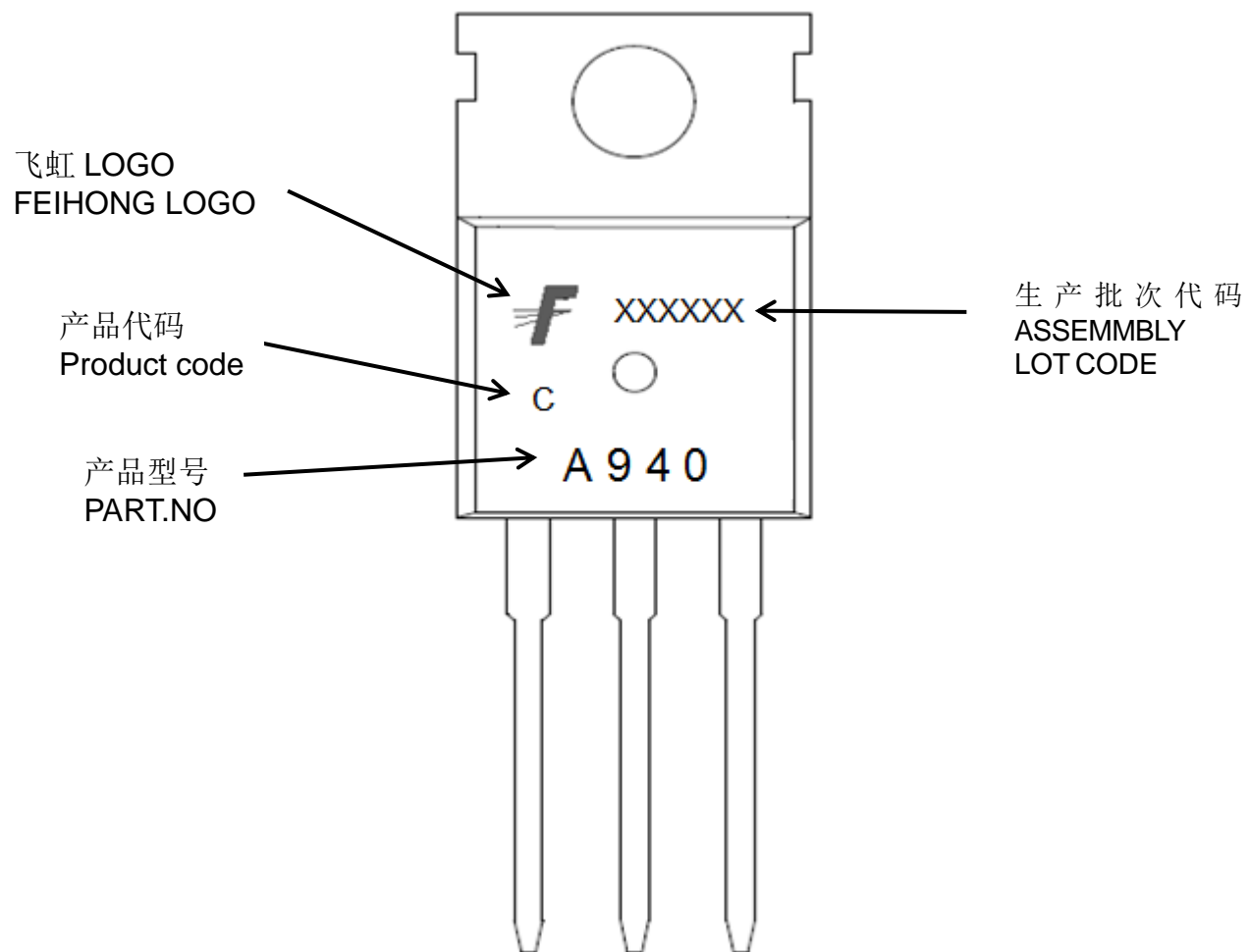

外形尺寸:

Package Dimension:

TO-220

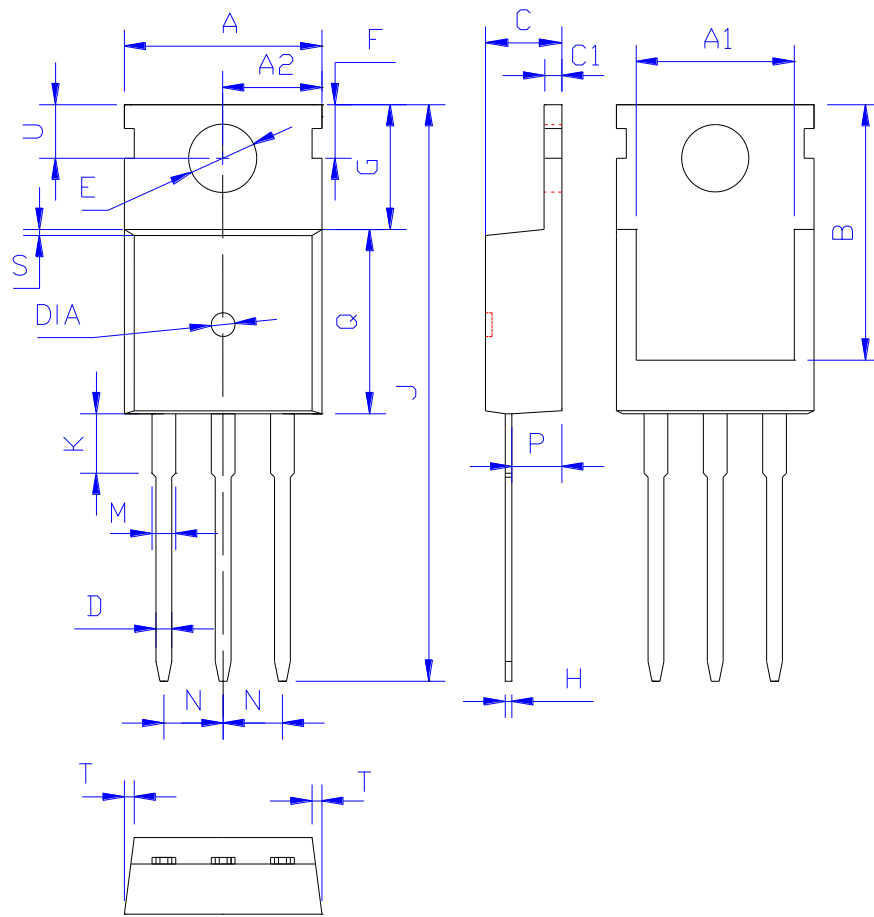

DIM	MILLIMETERS
A	10.00±0.30
A1	8.00±0.30
A2	5.00±0.30
B	13.20±0.40
C	4.50±0.20
C1	1.30±0.20
D	0.80±0.20
E	3.60±0.20
F	3.00±0.30
G	6.60±0.40
H	0.50±0.20
J	28.88±0.50
K	3.00±0.30
M	1.30±0.30
N	Typical 2.54
P	2.40±0.40
Q	9.20±0.40
S	0.25±0.15
T	0.25±0.15
U	2.80±0.30
DIA	宽 1.50±0.10 深 0.50 MAX

(Units: mm)