

主要技术参数、性能  
The Main Technology Performance

| 项目 Item                          | 参数 Parameter  |
|----------------------------------|---|
| 电路图<br>Circuit                   |  |
| 额定电流、电压<br>Rated current/voltage | 见标识图<br>Marking/Rating  |
| 绝缘电阻<br>Insulated resistance     | $\geq 100M \Omega$  |
| 接触电阻<br>Contact resistance       | $\leq 100m \Omega$  |
| 介电强度<br>Dielectric strength      | 工作绝缘: 500Vac/5mA/5s<br>基本绝缘: 1500Vac/5mA/5s   |
| 电气寿命<br>Endurance                | 见标识图<br>Marking/Rating  |
| 使用温度<br>Ambient temperature      | 见标识图<br>Marking/Rating  |
| 操作力<br>Operating force           | $60 \pm 30g \cdot f$  |
| 行程<br>TRAVEL                     | FP=12.7 $\pm$ 0.8mm<br>OP=1.0、2 $\pm$ 0.8mm   |

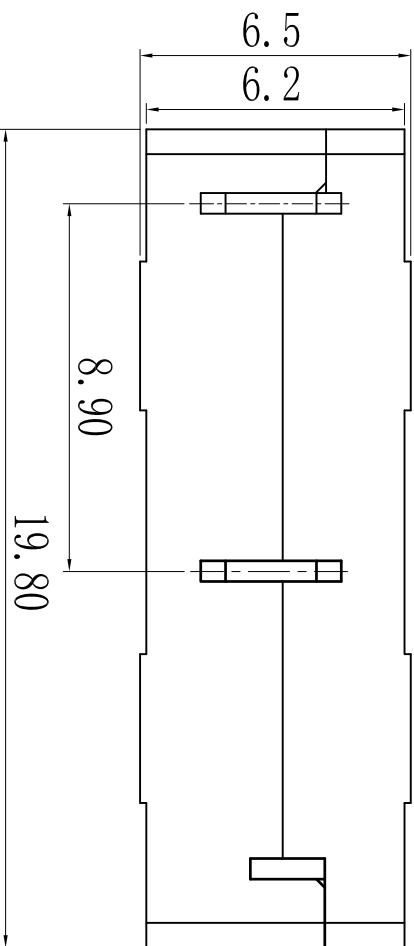

**CNIBAO** MAC-1210  $\mu$   
 3(3)A 250VAC 5E4 T125  
 8(3)A 250VAC T125  
 MAC-1210  $\mu$  25T125 5E4  
 10GPA 125/250VAC 8A 36VDC 1E5 **UL**® US  
 8(4)A 125/250VAC 1/2HP 125/250VAC

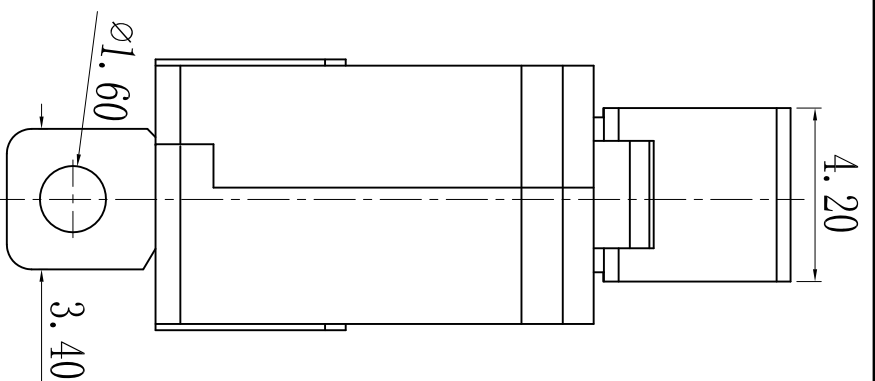
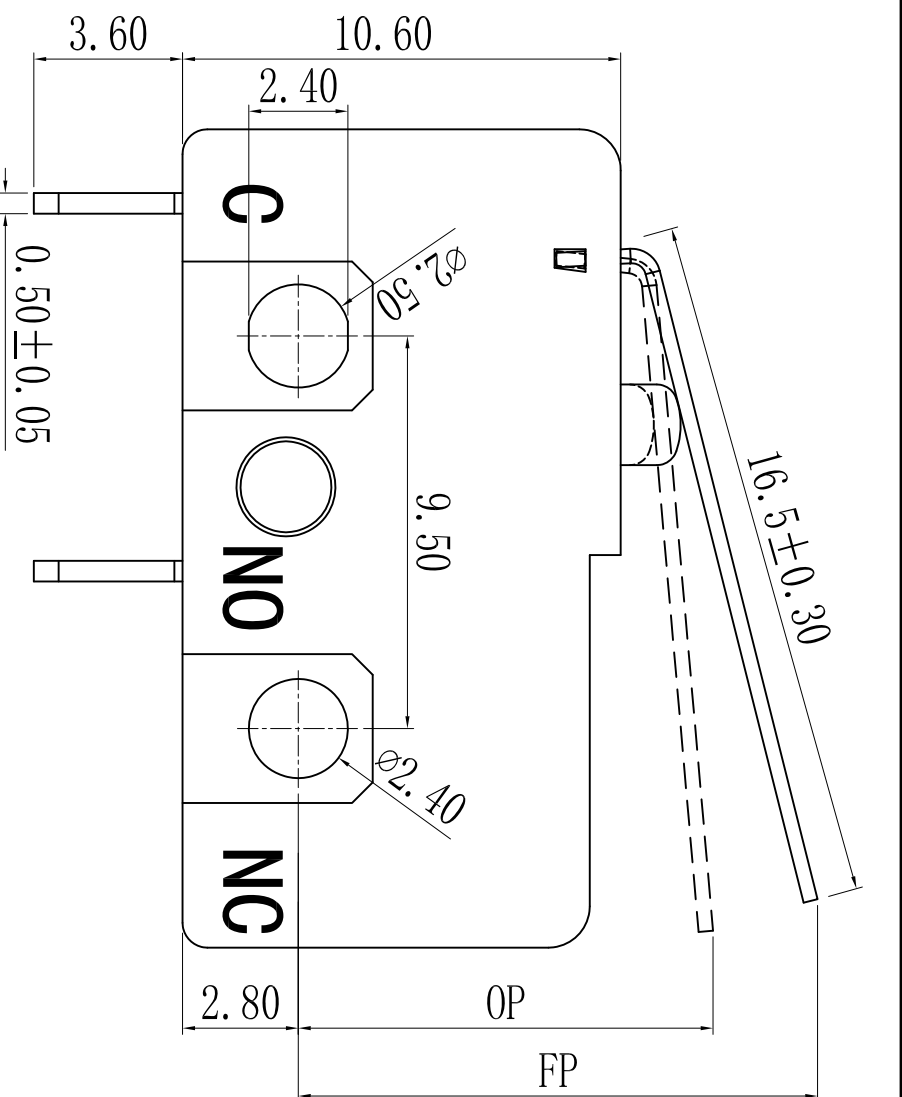
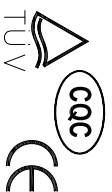

|  |  |                       |  |                                     |  |
|--|--|-----------------------|--|-------------------------------------|--|
| 第三视图<br>THE THIRD<br>ANGLE<br>PROJECTION |  | 比例 SCALE<br>SCALE     |  | NONE                                |  |
| MARK AMOUNT 数量                           |  | MODIFY FILE NO. 更改文件号 |  | CHANGE BY 更改人                       |  |
| DATE                                     |  | DATE                  |  | DATE                                |  |
| 设计 DESIGN                                |  | 审核 CHECK              |  | 批准 APPROVAL                         |  |
| 单位 UNIT                                  |  | mm                    |  | 版本 VERSION                          |  |
| A0                                       |  | A0                    |  | A0                                  |  |
| -般公差 GENERAL TOLERANCE                   |  | ±0.10                 |  | ±0.10                               |  |
| >0.5~6                                   |  | ±0.20                 |  | ±0.20                               |  |
| >6~30                                    |  | ±0.30                 |  | ±0.30                               |  |
| >30~120                                  |  | ±2°                   |  | ±2°                                 |  |
| 角公差 ANGLE                                |  | ±2°                   |  | ±2°                                 |  |
| <b>CNIBAO</b> 浙江亿宝<br>ZHEJIANG YIBAO     |  | 微动开关<br>MICRO SWITCH  |  | DESIGNATION:<br>MAC-1210-0-BDA12-11 |  |