

One-touch connection with female connector terminal

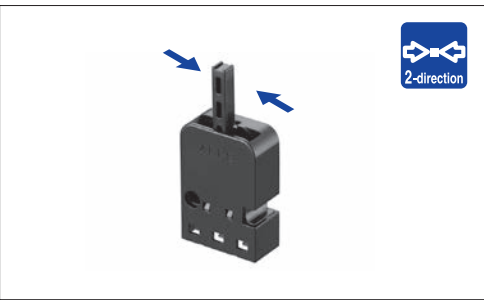

### Typical Specifications

Items		Specifications
Rating (max.)/(min.) (Resistive load)		0.1A 12V DC / 50μA 5V DC
Contact resistance (Initial / After operating life)		500mΩ max. / 1Ω max.
Operating force		0.7N max.
Operating life	Without load	50,000cycles
	With load	50,000cycles (0.1A 12V DC)

### Product Line

Poles	Positions	Terminal type	Inclination angle (max. on one side)	Minimum order unit (pcs)		Product No.
				Japan	Export	
1	2	Female connector type	36°	1,000	5,000	<b>SSCL110101</b>

### Packing Specifications

Bulk

Number of packages (pcs.)		Export package measurements (mm)
1 case /Japan	1 case /export packing	
1,000	5,000	400×270×290

### Dimensions

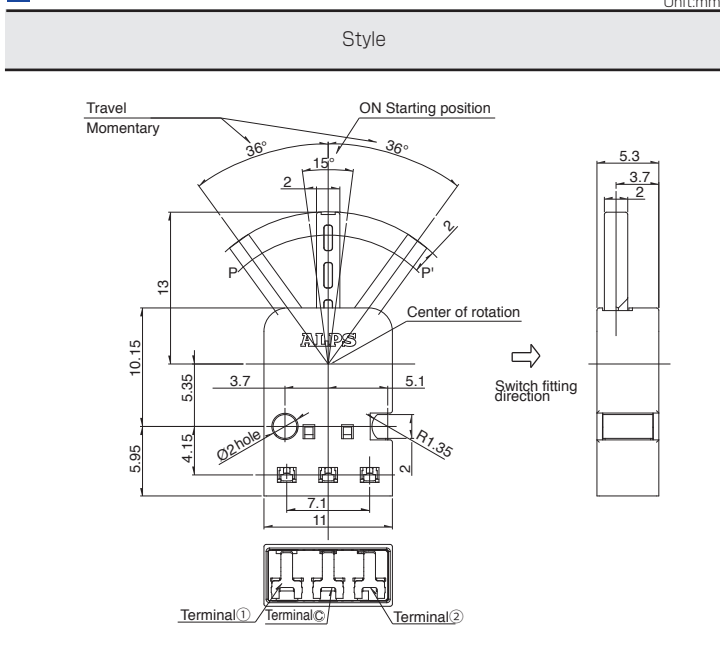



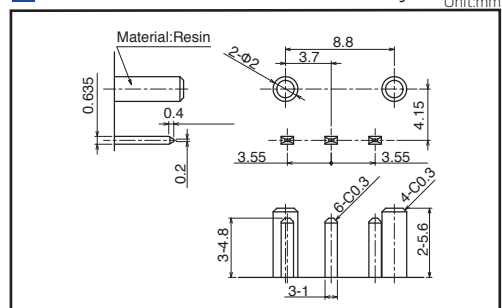



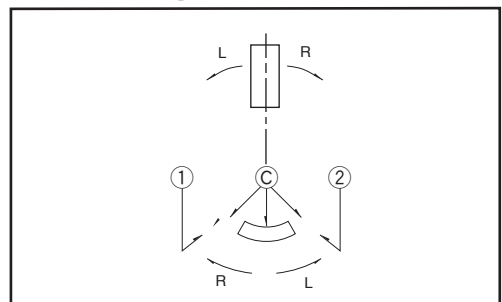

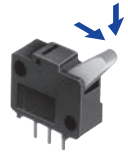

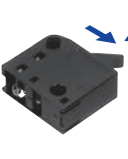
### Recommended Unit Terminal Style

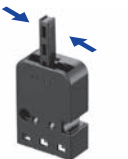

### Circuit Diagram



Series		General-purpose Type				
		SSCT	SSCF	SSCW	SPVQ5	SSCL
Photo						
Operation type		Two-way			One-way	Two-way
Dimensions (mm)	W	12.5	11	13.1	13.8	11
	D	5	5.8	11.35		16.1
	H	11.5	12.4	5.3	5.8	5.3
Operating temperature range		-40°C to +85°C				
Automotive use		●	●	●	●	●
Life cycle (availability)						
Poles / Positions		1/2		1/1	1/2	
Rating (max.) (Resistive load)		0.1A 12V DC				
Rating (min.) (Resistive load)		50μA 3V DC		100μA 3V DC	50μA 5V DC	
Durability	Operating life without load	10,000cycles 500mΩ max.	50,000cycles 300mΩ max.	100,000cycles 1Ω max.	300,000cycles 1Ω max.	50,000cycles 1Ω max.
	Operating life with load Rating (max.) (Resistive load)	10,000cycles 500mΩ max.	50,000cycles 300mΩ max.	100,000cycles 1Ω max.	300,000cycles 1Ω max.	50,000cycles 1Ω max.
Electrical performance	Initial contact resistance	200mΩ max.	100mΩ max.	500mΩ max.		
	Insulation resistance	100MΩ min. 250V DC	100MΩ min. 100V DC	100MΩ min. 250V DC	100MΩ min. 500V DC	100MΩ min. 100V DC
	Voltage proof	250V AC for 1minute	100V AC for 1 minute	250V AC for 1minute	500V AC for 1minute	100V AC for 1minute
Mechanical performance	Terminal strength	3N for 1minute	5N for 1minute	—		
	Actuator strength	20N	10N	20N		10N
Environmental performance	Cold	-40°C 500h				
	Dry heat	85°C 500h				
	Damp heat	60°C, 90 to 95%RH 500h				
Operation force		0.7±0.3N	0.7N max.	1N max.	2N max.	0.7N max.
Page		40	41	43	44	45

Detector Switches Soldering Conditions . . . . . 73  
 Detector Switches Cautions . . . . . 74

**Note**  
 ● Indicates applicability to all products in the series.