

SPECIFICATIONS

Rated (额定参数): 300V,20A
 Dielectric strength(抗电强度): AC2000V/1 Minute
 Insulation Resistance(绝缘电阻):1000MΩ Min
 Contact Resistance(接触电阻):20mΩ Max
 Screw Torque(扭矩): 0.4Nm (3.5lb.in)
 Wire Range(线径):1.6~2.2AWG
 Temp. range(操作温度): -40°C~+105°C
 MAX Soldering(瞬时温度):+250°C,5s

Housing Material(塑件): PA66 (UL94 V-0)
 Contact(端子): Brass, Tin plating(黄铜镀锡)
 Screw (螺丝): M2.5, Steel, Ni plating(钢,镀锌)

PITCH RANGE IN MM	NOMINAL DIMENSION RANGE IN MM				
	OVER TO	OVER TO	OVER TO	OVER TO	OVER TO
6 TO 6	10 TO 10	30 TO 30	60 TO 60	100 TO 100	150 TO 150
±0.10	±0.15	±0.25	±0.30	±0.50	±0.70

Ordering Information

JL635 - 635 XX X X 1

Pitch 635=6.35PH
 No.of pins 2P~20P
 Housing Color
 B=Black
 G=Green
 U=Blue
 R=Red
 W=White
 Y=Yellow
 O=Orange
 E=Grey

Packing
 0=Pe bag
 T=Tube
 A=Troy

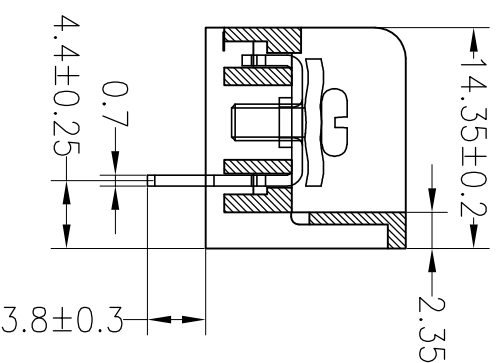
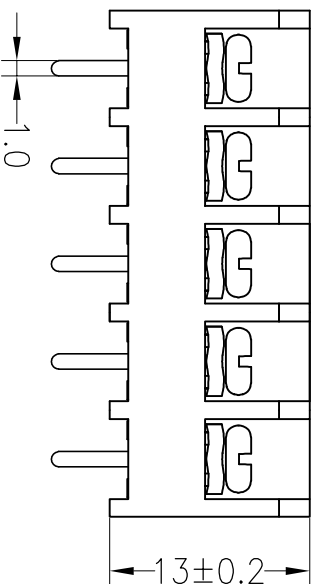
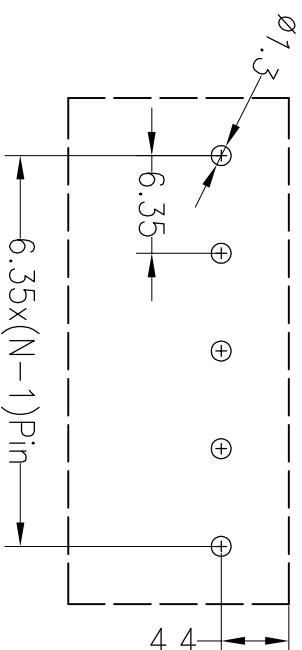
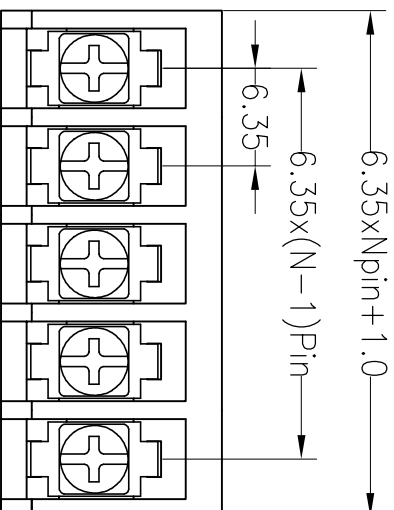

OPERATION	DRAW	SCALE	FIT
XX ±0.30	yiyusheng	UNIT	mm
X.XX ±0.20	CHECK	SIZE	A4
X.XXX ±0.10	APPROVE	SHEET	1/1
Angle ±3°		PROJ.	
DIM TOL			

DATE	MODIFICATION DESCRIPTION	CHANGE
2019.03.29	NEW DRAWING	

JILIN 深圳市锦凌电子有限公司
 SHENZHEN JINLING ELECTRONIC CO.,LTD
 Tel: 86-755-2997-5806/5802 Fax: 86-755-2997-5992

PART NO. JL635-635XXXX1
 TITLE: 6.35mm Terminal Blocks Female