

客户确认

日期

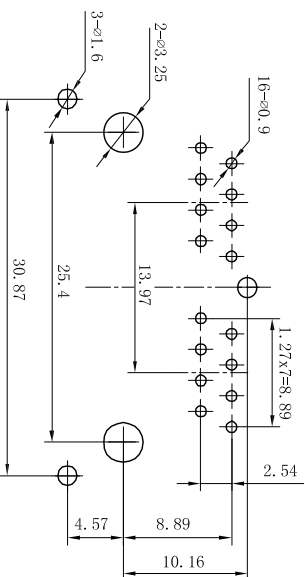
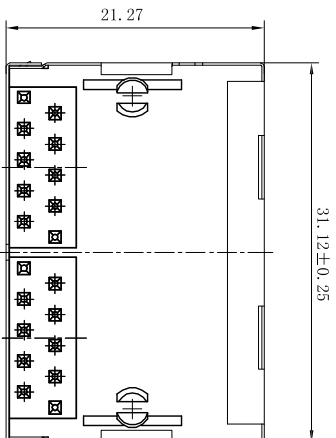
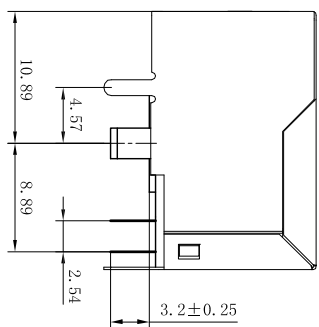
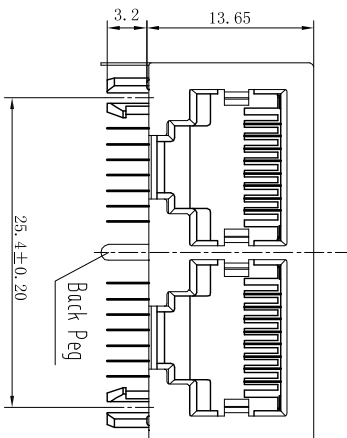

PC Board Layout  
Component Side Shown

NOTES:

MATERIAL:

- 1 HOUSING MATERIAL
- 2 CONTACT MATERIAL
- 3 PLATING
- 4 SHIELD

ELECTRICAL:

- 1 VOLTAGE RATING
- 2 CURRENT RATING
- 3 CONTACT RESISTANCE
- 4 INSULATION RESISTANCE
- 5 DIELECTRIC WITHSTANDING RESISTANCE

MECHANICAL:

- 1 DURABILITY
- 2 PCB RETENTION PRE-SOLDER

ENVIRONMENTAL:

- 1 STORAGE
- 2 OPERATION

TOLERANCE TABLE	
.0	±0.30
.00	±0.20
.000	±0.05

APPROVED:	DATE:	TITLE:	
CHECKED:	DATE:	R145-8P8C 双胞胎 弯插 带屏蔽	
DRAWN:	DATE:	CLIENT P/N	
LYF	2013-11-13	R-RJ45R08P-2006	
		UNIT	SCALE
		mm	Free
		FILE NO.	REV.
		Ckmtw-RJ45-0067	A

深圳市灿科盟实业有限公司  
CHANKEMENG INDUSTRY CO., LTD

深 圳 市 灿 科 盟 实 业 有 限 公 司  
CHANKEMENG INDUSTRY CO., LTD

R145-8P8C 双胞胎 弯插 带屏蔽

CLIENT P/N R-RJ45R08P-2006

UNIT mm SCALE Free

FILE NO. Ckmtw-RJ45-0067 REV. A

HX04