

**HSF** RoHS **SAI** us **CE**

**SPECIFICATIONS**

Rated(额定参数): 300V,25A  
 Dielectric strength(抗电强度): AC2000V/1 Minute  
 Insulation Resistance(绝缘电阻):1000MΩ Min  
 Contact Resistance(接触电阻):20mΩ Max  
 Screw Torque(扭矩): 1.2Nm (10.53lb.in)  
 Wire Range(线径):12~22AWG  
 Temp. range(操作温度): -40°C~+105°C  
 MAX Soldering(瞬时温度):+250°C,5s

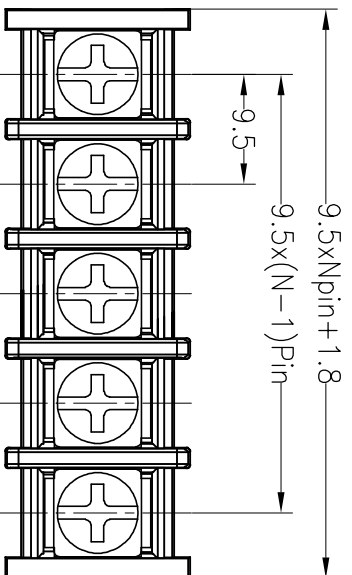

Housing Material(塑件): PA66 (UL94 V-0)  
 Contact(端子): Brass, Tin plating(黄铜镀锡)  
 Screw (螺丝): M4.0, Steel, Ni plating(钢,镀锌)

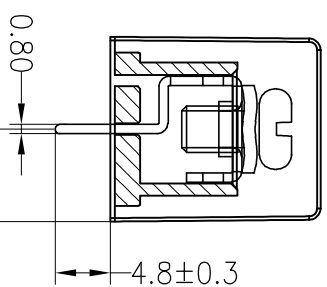
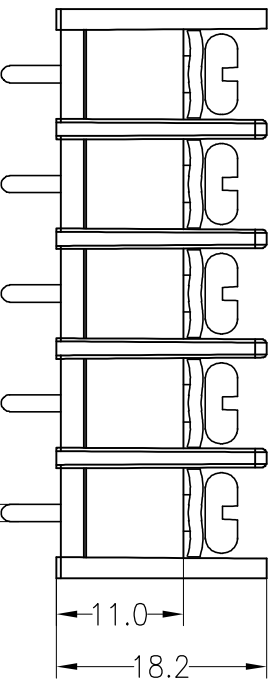

**Ordering Information**

**JL45C - 950 XX X X 1**

Pitch 950=9.5PH  
 No.of pins 2P~26P  
 Housing Color  
 B=Black  
 G=Green  
 U=Blue  
 R=Red  
 W=White  
 Y=Yellow  
 O=Orange  
 E=Grey  
 Packing  
 O=Pe bog  
 T=Tube  
 A=Troy

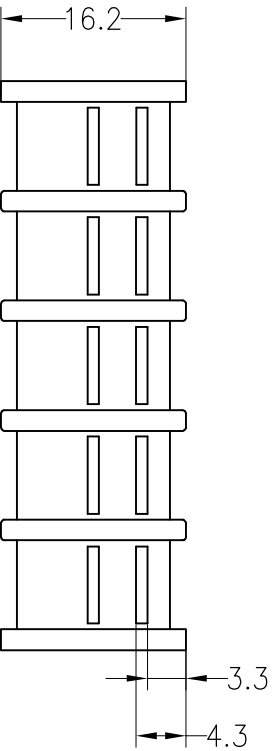

REV		DATE	MODIFICATION DESCRIPTION	CHANGE	DIM	TOL	APPROVE	SCALE	FIT	TITLE:	
A0		2015.07.09	NEW DRAWING		Angle	±3°	APPROVE	UNIT	mm	PART NO. JL45C-950XXXX1	
								SIZE	A4	SHENZHEN JINLING ELECTRONIC CO.,LTD	
								SHEET	1/1	Tel: 86-755-2997-5806/5802 Fax: 86-755-2997-5992	
								PROJ.		深圳市锦凌电子有限公司	
										9.50mm Barrier Terminal Blocks	