

## MKA10110

Ultra-miniature dry-reed switch hermetically sealed in a gas-filled glass envelope. Single-pole, single-throw (SPST) type, having normally open contacts, and containing two magnetically actuated reeds.

The switch is of the double-ended type and may be actuated by an electromagnet, a permanent magnet or a combination of both. The device is intended for use in relays, sensors, pulse counters or similar devices.

### MKA10110 Features

- ◆ Ideal for ATE switching
- ◆ 10 mm glass length
- ◆ Contact layers: gold, sputtered ruthenium
- ◆ Superior glass-to-metal seal and blade alignment
- ◆ Excellent life expectancy and reliability

### Dimension For MKA10110

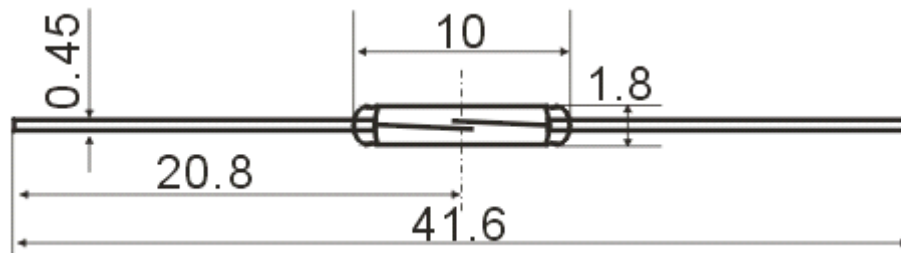

### Technical Specifications

Parameters	Test Conditions	Units	MKA10110
Contact Form			1A SPST-NO
Contact Material			Ru
Max. Contact Rating		W	10
Max Switching Voltage		V	100VDC
Max Switching Current		A	0.5
Max Initialcontact Resistance		mΩ	100
Pull In Value		AT	7-35
Drop out Volue		AT	4
Min Breakdown Voltage		VDC/AC	150
Max Contact Capacitance		pF	0.5
Min Insulation Resistance		mΩ	10 <sup>6</sup>
Type Resonant Frequency	(energization)	KHz	5
Operation Temperature		°C	-55°C~+125°C