

RECOMMENDED P.C.B. LAYOUT

安装尺寸图

规格 Specifications	
额定负荷 Rating	DC 12V/50mA
接触电阻 Contact Resistance	100mΩ max.
绝缘电阻 Insulation resistance	DC100V 60S 100MΩ min.
抗电强度 Dielectric strength	AC250V (50~60HZ) 60S min.
操作力 Operation force	≤ 180 ± 80gf / ≥ 250 ± 50gf
寿命试验 Operating Life	100,000cycles / 100,000cycles
行程 Travels	看左侧编码说明

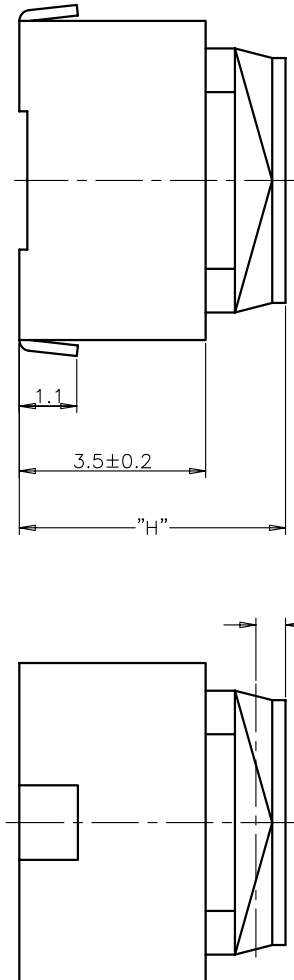

PRODUCT NO. : 1TS009\*\*\*\*\*-CT

- 轻触开关 TMRV系列
- 外形: A=弧盖弯脚 B=平盖弯脚 C=弧盖平脚 D=平盖平脚
- 按钮颜色: 底座颜色: 盖板颜色:
- 操作力度: 160=160±30gf, 180=180±30gf, 250=250±50gf, 260=260±50gf, 280=280±50gf, 300=300±50gf
- 手感: 0=常规, 1=大手感, 2=小手感
- 产品高度 (H): 430=4.3mm (行程: 0.7±0.2mm), 500=5.0mm (行程: 1.3<sup>+0.2</sup> mm)
- 材质: 0=LCP, 1=新增材质, 依次增加
- 编织带 非编织带, 不启用

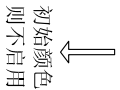

ITEM	PART NAME	QUANTITY	MATERIAL	FINISH
5	COVER	1	LCP	BLACK
4	ACTUATOR	1	SILICONE	/
3	CONTACT	1	STAINLESS STEEL	Ag-PLATED
2	TERMINAL	2	BRASS	Ag-PLATED
1	HOUSING	1	LCP	BLACK

X. ± 0.3	X' ± 3'	UNITS	MM	NAME(INTENDED USE)	TMRV SERIES TACT SWITCH	HON YUAN HON YUAN PRECISION IND. CO.,LTD. SHENZHEN, CHINA.
.X ± 0.2	.X' ± 2'	MAT'L				
.XX ± 0.1	.XX' ± 1'	FINISH				
.XXX ± 0.05	.XXX' ± 0.5'					

APPD:	CHKD:	DR:	SCALE	SHEET	REV.
ZO 2015-11-10	LI 2015-11-10	DR:Y.Y.Chen 2015-11-10	10/1	1/1	D

