

Fig1. MEASURING METHOD

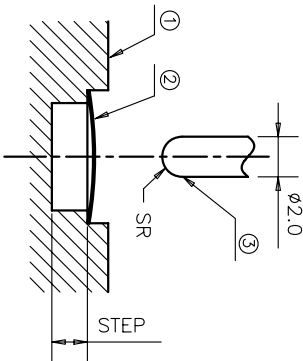
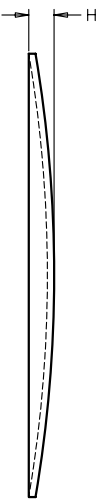

Fig2. OPERATING PERFORMANCE

NOTES:  
1. ALL THE OPERATING PERFORMANCE SPEC. IN BELOW TABLE SHOULD BE MET. THE MEASURE METHOD IS SHOWN AS Fig.1.  
OPERATE THE DOME 10 TIMES BEFORE MEASURING.

REV	ECN NO.	APPD
A	HC060009	ZO
B	HC100097	ZO
C	HC150011	ZO

F<sub>p</sub>: PEAK FORCE  
F<sub>r</sub>: RETURN FORCE  
T1: CONTACT POINT  
T2: BUTTON POINT  
C/R=(F<sub>p</sub>-F<sub>r</sub>)/F<sub>p</sub>\*100%  
REMARK:  
1.T1, T2 TESTED WHEN THE SETP IS DEEP ENOUGH TO NOT CONTACT WITH DOME DURING MEASURING.  
2. T1<T2



- 1) TEST SPEED : 120 SPM
- 2) TEST FORCE : F<sub>p</sub>
- 3) MATERIAL : ALUMINIUM.
2. OBVIOUS BURR, SCRATCHES, CRACKES IS FORBIDDEN.
3. DIMENSIONS MARKED ∇ SHOULD BE CHECKED BY Q.C. AND P.E.
4. DIMENSIONING SHALL BE INTERPRETED PER ANSI Y14.5M-1982.
5. HARMFUL MATERIAL CONTROL PLEASE FOLLOW DOC."HY-QW-02".
6. PART PERFORMANCE TABLE

PART NAME	D	W	H	P.F(gf)	C/R(%)
610-5***-****	∅5±0.05	3.7±0.05	0.25±0.05	CP±15	C/R±10
610-C***-****	∅4.5±0.05	3.3±0.05	0.22±0.05	CP±15	C/R±10
610-4***-****	∅4±0.05	2.8±0.05	0.2±0.05	CP±15	C/R±10
610-F***-****	∅2.4±0.05	2.2±0.05	0.15±0.05	CP±15	C/R±10
610-D***-****	∅2.2±0.05	1.6±0.05	0.13±0.05	CP±15	C/R±10
610-2***-****	∅2±0.05	1.5±0.05	0.12±0.05	CP±15	C/R±10

TYPE:	DIMPLE:	D:	C/R:	STEP:	MATERIAL:	CP:
□	0 1 3 4 5	2=∅2.0mm 3=∅3.0mm 4=∅4.0mm 5=∅5.0mm 6=∅6.0mm A=∅2.5mm B=∅3.5mm C=∅4.5mm D=∅2.2mm E=∅2.3mm F=∅2.4mm G=∅2.7mm H=∅2.8mm J=∅2.9mm K=∅2.85mm L=∅2.92mm	0=60% 1=65% 2=55% 3=45% 4=35% 5=25% 6=15%	0=0.00mm 1=0.01mm 2=0.02mm 3=0.03mm 4=0.04mm 5=0.05mm 6=0.06mm 7=0.07mm 8=0.08mm 9=0.09mm A=0.10mm	9=SUS 0=Ni-SUS S=AG-SUS 1=PB 2=BECU	060=060gf 080=080gf 100=100gf 130=130gf 150=150gf 160=160gf 180=180gf 200=200gf 250=250gf

X. ± 0.2	X'. ± 0.3	UNITS	MM	NAME(INTENDED USE)	HON YUAN
.X ± 0.1	.X' ± 2'	MATL		METAL DOME FOR TACT SWITCH	HON YUAN PRECISION IND. CO.,LTD. SHENZHEN, CHINA, R.O.C.
.XX ± 0.05	.XX' ± 1'	FINISH		PART NO.(INTENDED USE)	TITLE:
.XXX ± 0.03	.XXX' ± 0.5'			610-****-****	DOME CUSTOMER DRAWING
THESE DRAWINGS AND SPECIFICATIONS ARE THE PROPERTY OF HON YUAN PRECISION IND. CO., LTD. AND SHALL NOT BE REPRODUCED, COPIED OR USED IN ANY MANNER WITHOUT THE PRIOR WRITTEN CONSENT OF HON YUAN PRECISION IND. CO., LTD.				APPD: ZO 6/04/2015	DWG NO.: 610-0000-000
				CHKD: M.H.L: 6/04/2015	SCALE SHEET
				DR: WP.L: 6/03/2015	1/1
					1/5
					REV. C