

NOTES:  
 Housing: Thermoplastics, UL94V-0  
 Contact: Copper Alloy  
 Shell: Copper Alloy/Steel  
 Voltage Current Rating: 1.5 AMP. 30V AC  
 Insulation Resistance: 1000MΩ Min.  
 Contact Resistance: 30 MΩ Max.  
 Dielectric Withstanding Voltage: 500V AC  
 Temperature Range: -55° C to +85° C  
 Insulator color: Black/White  
 Plastic material: PBT/LCP  
 Shell finish: Nickel plated/Tin-Lead plated  
 Contact finish:  
 01: Selective Gold Flash  
 02: Selective Gold 3U"  
 03: Selective Gold 5U"  
 04: Selective Gold 15U"  
 05: Selective Gold 30U"

目錄 MAPX	设变内容 MODIFICATION	日期 DATE
A0	NEW	09-10-20

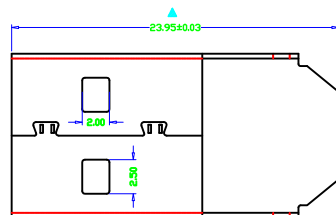
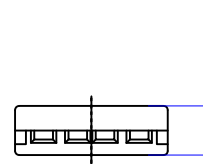
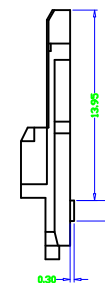
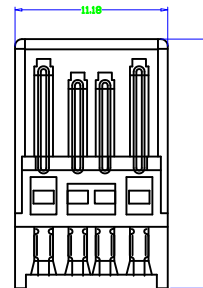
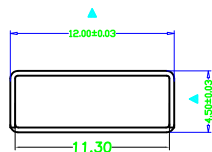
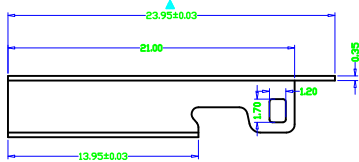

产品图 PRODUCT CHART DWG									
公差一览表 TOLERANCE UNLESS OTHERWISE				单位 UNITS	MM	制图 DRAWING	Z-Y-B	产品料号 PRODUCT PART NO.	
X.	±0.15	X'	±5°	比例 SCALE	1:1	审核 CHKD		产品名称 PRODUCT NO.	C39464
.XX	±0.10	.XX'	±2°					日期 DATE	2014/10/20
.XXX	±0.05	.XXX'	±1°						
	±0.03	.XXX'	±0.5°						A0