

◆ SPECIFICATIONS

Unit:mm

- ◇ Poles: 4~35
- ◇ Applicable wire: AWG#28-#22
- ◇ Voltage rating: 50V DC/AC
- ◇ Current rating: 0.5A
- ◇ Withstand voltage: 500V AC
- ◇ Working Temperature: -25°C~+85°C
- ◇ Insulation resistance: $\geq 800M\Omega$
- ◇ Contact resistance: $\leq 0.03\Omega$
- ◇ Applicable PC board thickness: 0.6~1.2mm

FPC 0.5-1-nP 立贴

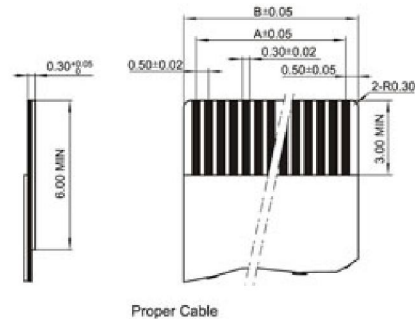
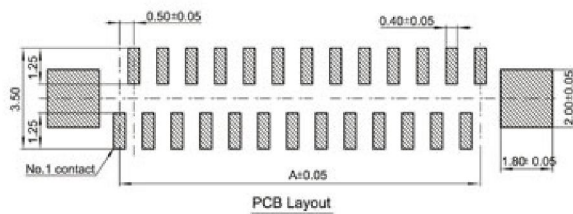
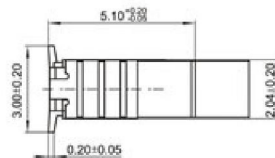
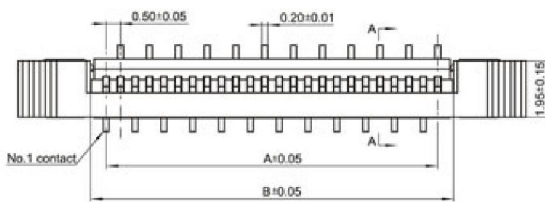
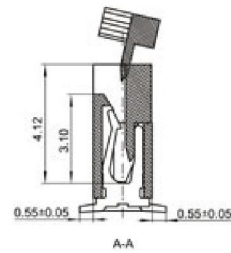
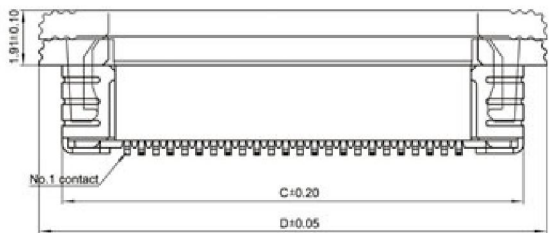

FPC 0.5-1-nP 上接

Unit:mm

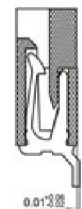
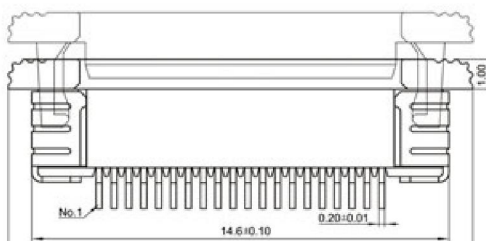

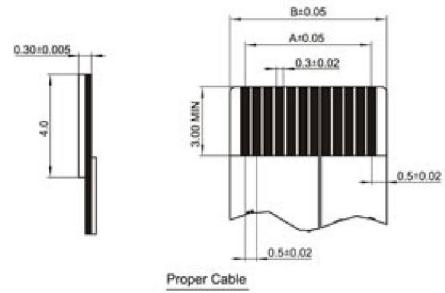
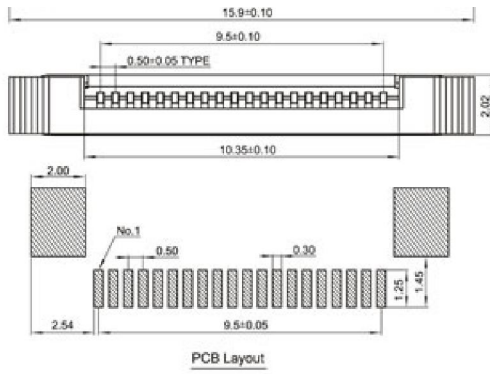

FPC 0.5-1-nP 下接

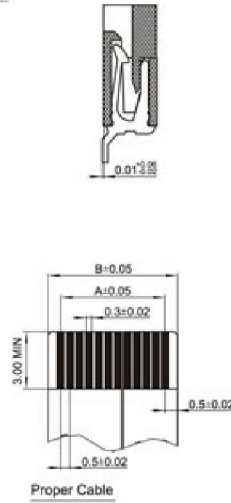
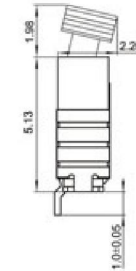
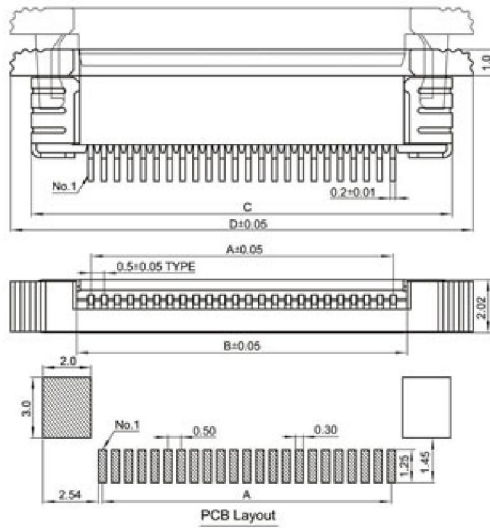

Poles	Type	Size(mm)			
		A	B	C	D
4	FPC 0.5-1-4Y	1.5	2.6	6.0	7.5
5	FPC 0.5-1-5Y	2.0	3.1	6.5	8.0
6	FPC 0.5-1-6Y	2.5	3.6	7.0	8.5
7	FPC 0.5-1-7Y	3.0	4.1	7.5	9.0
8	FPC 0.5-1-8Y	3.5	4.6	8.0	9.5
9	FPC 0.5-1-9Y	4.0	5.1	8.5	10.0
10	FPC 0.5-1-10Y	4.5	5.6	9.0	10.5
11	FPC 0.5-1-11Y	5.0	6.1	9.5	11.0
12	FPC 0.5-1-12Y	5.5	6.6	10.0	11.5
13	FPC 0.5-1-13Y	6.0	7.1	10.5	12.0
14	FPC 0.5-1-14Y	6.5	7.6	11.0	12.5

Poles	Type	Size(mm)			
		A	B	C	D
15	FPC 0.5-1-15Y	7.0	8.1	11.5	13.0
16	FPC 0.5-1-16Y	7.5	8.6	12.0	13.5
17	FPC 0.5-1-17Y	8.0	9.1	12.5	14.0
18	FPC 0.5-1-18Y	8.5	9.6	13.0	14.5
19	FPC 0.5-1-19Y	9.0	10.1	13.5	15.0
20	FPC 0.5-1-20Y	9.5	10.6	14.0	15.5
21	FPC 0.5-1-21Y	10.0	11.1	14.5	16.0
22	FPC 0.5-1-22Y	10.5	11.6	15.0	16.5
23	FPC 0.5-1-23Y	11.0	12.1	15.5	17.0
24	FPC 0.5-1-24Y	11.5	12.6	16.0	17.5
25	FPC 0.5-1-25Y	12.0	13.1	16.5	18.0

Poles	Type	Size(mm)			
		A	B	C	D
26	FPC 0.5-1-26Y	12.5	13.6	17.0	18.5
27	FPC 0.5-1-27Y	13.0	14.1	17.5	19.0
28	FPC 0.5-1-28Y	13.5	14.6	18.0	19.5
29	FPC 0.5-1-29Y	14.0	15.1	18.5	20.0
30	FPC 0.5-1-30Y	14.5	15.6	19.0	20.5
31	FPC 0.5-1-31Y	15.0	16.1	19.5	21.0
32	FPC 0.5-1-32Y	15.5	16.6	20.0	21.5
33	FPC 0.5-1-33Y	16.0	17.1	20.5	22.0
34	FPC 0.5-1-34Y	16.5	17.6	21.0	22.5
35	FPC 0.5-1-35Y	17.0	18.1	21.5	23.0