

## Single Phase 1.0Amp Glass passivated Bridge Rectifiers

### Features

- ◆ The plastic package carries Underwriters Laboratory Flammability Classification 94V-0
- ◆ Idea for printed circuit board
- ◆ Glass passivated Junction chip
- ◆ Low reverse leakage
- ◆ High forward surge current capability
- ◆ High temperature soldering guaranteed  
250°C/10 seconds at terminals

### Mechanical Data

**Case:** Molded plastic body

**Terminals:** Solder plated, solderable per MIL-STD-750, Method 2026

**Polarity:** Polarity symbol marking on body

**Mounting Position:** Any

**Weight :** 0.008 ounce, 0.22 grams

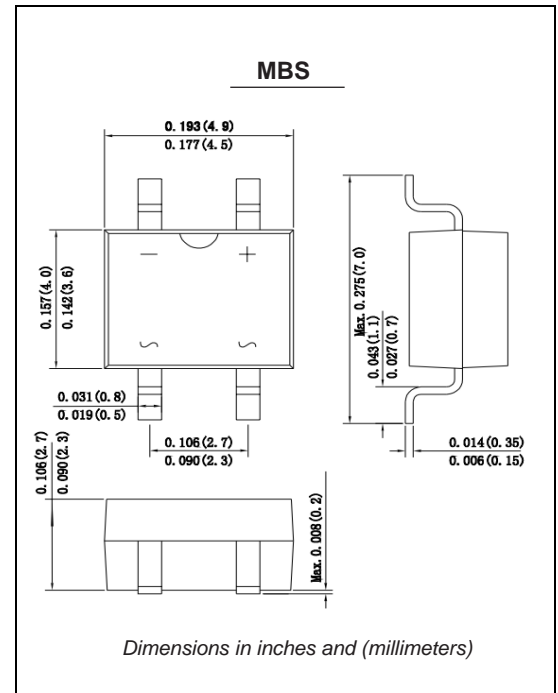

### Maximum Ratings And Electrical Characteristics

Ratings at 25°C ambient temperature unless otherwise specified. Single phase half-wave 60Hz, resistive or inductive load, for capacitive load current derate by 20%.

	SYMBOLS	MB1S	MB2S	MB4S	MB6S	MB8S	MB10S	UNITS
Maximum repetitive peak reverse voltage	$V_{RRM}$	100	200	400	600	800	1000	VOLTS
Maximum RMS voltage	$V_{RMS}$	70	140	280	420	560	700	VOLTS
Maximum DC blocking voltage	$V_{DC}$	100	200	400	600	800	1000	VOLTS
Maximum average forward rectified current at $T_L=30^\circ C$ On glass-epoxy P.C.B (Note 1)	$I_{AV}$	1.0						Amp
Peak forward surge current 8.3ms single half sine-wave superimposed on rated load (JEDEC Method)	$I_{FSM}$	35.0						Amps
Maximum instantaneous forward voltage at 1.0A	$V_F$	1.0						Volts
Maximum DC reverse current $T_A=25^\circ C$ at rated DC blocking voltage $T_A=125^\circ C$	$I_R$	5.0 500						$\mu A$
Typical junction capacitance (Note 2)	$C_J$	25.0						pF
Typical thermal resistance	$R_{qJA}$	55.0						$^\circ C/W$
Operating junction and storage temperature range	$T_J, T_{STG}$	-50 to +155						$^\circ C$

**Note:** 1. Mounted on glass epoxy PC board with 1.3\*1.3mm solder pad

2. Measured at 1MHz and applied reverse voltage of 4.0V D.C.

# Ratings And Characteristic Curves

## MB1S THRU MB10S

FIG. 1- DERATING CURVE OUTPUT RECTIFIED CURRENT

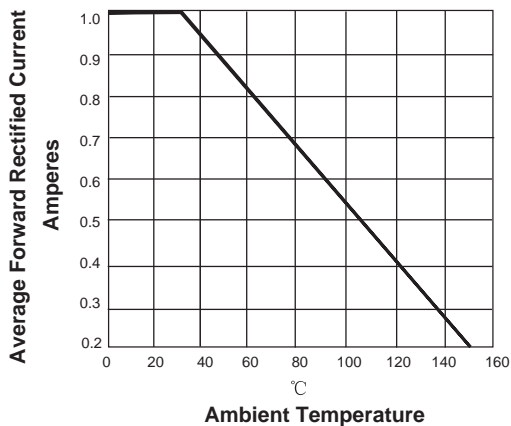

FIG. 2-MAXIMUM NON-REPETITIVE PEAK FORWARD SURGE CURRENT PER LEG

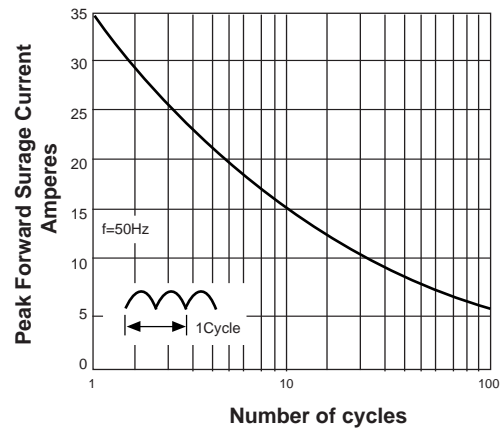

FIG. 3-TYPICAL FORWARD VOLTAGE CHARACTERISTICS

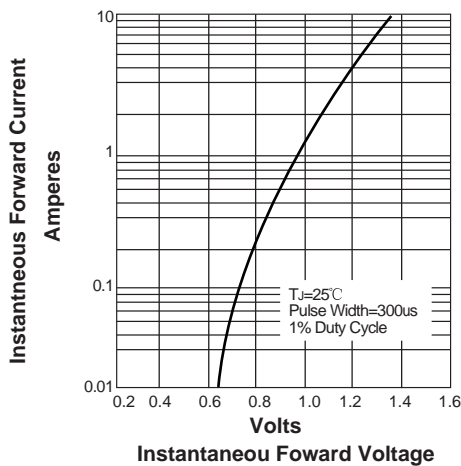

FIG. 4-TYPICAL REVERSE LEAKAGE CHARACTERISTICS

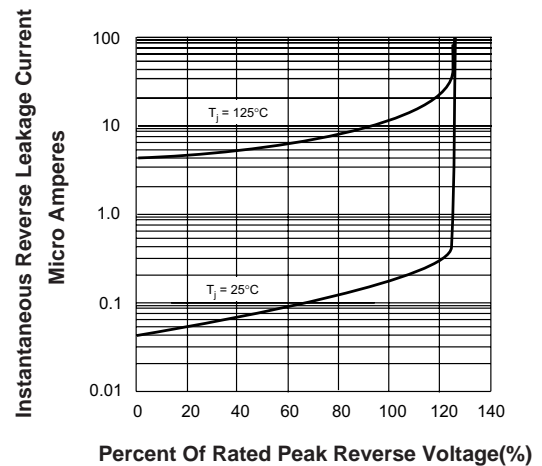

FIG. 5-TYPICAL JUNCTION CAPACITANCE

